

AGENDA
MAPLEWOOD CITY COUNCIL
7:00 P.M. Monday, March 25, 2024
City Hall, Council Chambers
Meeting No. 06-24

A. CALL TO ORDER

B. PLEDGE OF ALLEGIANCE

C. ROLL CALL

D. APPROVAL OF AGENDA

E. APPROVAL OF MINUTES

1. March 11, 2024 City Council Meeting Minutes

F. APPOINTMENTS AND PRESENTATIONS

1. Administrative Presentations
 - a. Council Calendar Update
2. Council Presentations
3. Swearing-In Ceremony for Three Police Officers

G. CONSENT AGENDA – *Items on the Consent Agenda are considered routine and non-controversial and are approved by one motion of the council. If a councilmember requests additional information or wants to make a comment regarding an item, the vote should be held until the questions or comments are made then the single vote should be taken. If a councilmember objects to an item it should be removed and acted upon as a separate item.*

1. Approval of Claims
2. Resolution Directing Modification of Existing Construction Contract, Change Order No. 1, Change Order No. 2, and Construction Contract Directive for Goodrich Park Improvements
3. Purchase of Road Salt for 2024-2025 Winter Season
4. Ramsey County Public Works to Perform 2024 Street Striping

H. PUBLIC HEARINGS – *If you are here for a Public Hearing please familiarize yourself with the Rules of Civility printed on the back of the agenda. Sign in with the City Clerk before addressing the council. At the podium please state your name and address clearly for the record. All comments/questions shall be posed to the Mayor and Council. The Mayor will then direct staff, as appropriate, to answer questions or respond to comments.*

None

I. UNFINISHED BUSINESS

None

J. NEW BUSINESS

1. Resolution for a Lawful Gambling Premises Permit for White Bear Avenue Business Association at Unison Restaurant & Banquet LLC, 1800 White Bear Avenue North

2. 2024 Maplewood Street Improvements, City Project 23-08
 - a. Resolution Approving Plans and Specifications and Advertising for Bids
 - b. Resolution Ordering Preparation of Assessment Roll

K. AWARD OF BIDS
None

L. ADJOURNMENT

Sign language interpreters for hearing impaired persons are available for public hearings upon request. The request for this must be made at least 96 hours in advance. Please call the City Clerk's Office at 651.249.2000 to make arrangements. Assisted Listening Devices are also available. Please check with the City Clerk for availability.

RULES OF CIVILITY FOR THE CITY COUNCIL, BOARDS, COMMISSIONS AND OUR COMMUNITY

Following are rules of civility the City of Maplewood expects of everyone appearing at Council Meetings - elected officials, staff and citizens. It is hoped that by following these simple rules, everyone's opinions can be heard and understood in a reasonable manner. We appreciate the fact that when appearing at Council meetings, it is understood that everyone will follow these principles:

Speak only for yourself, not for other council members or citizens - unless specifically tasked by your colleagues to speak for the group or for citizens in the form of a petition.

Show respect during comments and/or discussions, listen actively and do not interrupt or talk amongst each other.

Be respectful of the process, keeping order and decorum. Do not be critical of council members, staff or others in public.

Be respectful of each other's time keeping remarks brief, to the point and non-repetitive.

MINUTES
MAPLEWOOD CITY COUNCIL
7:00 P.M. Monday, March 11, 2024
City Hall, Council Chambers
Meeting No. 05-24

A. CALL TO ORDER

A meeting of the City Council was held in the City Hall Council Chambers and was called to order at 7:00 by Mayor Abrams.

B. PLEDGE OF ALLEGIANCE

C. ROLL CALL

Marylee Abrams, Mayor	Present
Rebecca Cave, Councilmember	Absent
Kathleen Juenemann, Councilmember	Present
Chonburi Lee, Councilmember	Present
Nikki Villavicencio, Councilmember	Present

Mayor Abrams welcomed new City Manager Mike Sable. City Manager Sable expressed appreciation for being back to the City of Maplewood and conveyed looking forward to working with the council and community members.

D. APPROVAL OF AGENDA

Councilmember Lee moved to approve the agenda as submitted.

Seconded by Councilmember Juenemann Ayes – All

The motion passed.

E. APPROVAL OF MINUTES

1. February 26, 2024 City Council Meeting Minutes

Councilmember Juenemann moved to approve the February 26, 2024 City Council Meeting Minutes as submitted.

Seconded by Councilmember Lee Ayes – All

The motion passed.

F. APPOINTMENTS AND PRESENTATIONS

1. Administrative Presentations

a. Council Calendar Update

City Manager Sable gave an update to the council calendar and reviewed other topics of concern or interest requested by councilmembers.

2. Council Presentations

None

- G. CONSENT AGENDA** – *Items on the Consent Agenda are considered routine and non-controversial and are approved by one motion of the council. If a councilmember requests additional information or wants to make a comment regarding an item, the vote should be held until the questions or comments are made then the single vote should be taken. If a councilmember objects to an item it should be removed and acted upon as a separate item.*

Councilmember Lee moved to approve agenda items G1-G9.

Seconded by Councilmember Juenemann Ayes – All

The motion passed.

1. Approval of Claims

Councilmember Lee moved to approve the approval of claims.

ACCOUNTS PAYABLE:

\$	1,063,895.68	Checks # 120601 thru # 120626 dated 02/27/24
\$	186,895.71	Checks # 120627 thru # 120651 dated 03/05/24
\$	398,394.73	Disbursements via debits to checking account dated 02/19/24 thru 03/03/24
<hr/>		
\$	1,649,186.12	Total Accounts Payable

PAYROLL

\$	725,443.54	Payroll Checks and Direct Deposits dated 03/1/24
<hr/>		
\$	725,443.54	Total Payroll
<hr/>		
\$	2,374,629.66	GRAND TOTAL

Seconded by Councilmember Juenemann Ayes – All

The motion passed.

2. Conditional Use Permit Review, Ridge Periodontics, 3033 Hazelwood Street North

Councilmember Lee moved to approve the CUP review for Ridge Periodontics, located at 3033 Hazelwood Street North, and review again only if a problem arises or a significant change is proposed.

Seconded by Councilmember Juenemann Ayes – All

The motion passed.

3. Conditional Use Permit Review, Moose Lodge, 1832 Gervais Court East

Councilmember Lee moved to approve the CUP review for the Moose Lodge at 1832 Gervais Court East and review again in one year.

Seconded by Councilmember Juenemann Ayes – All

The motion passed.

4. Conditional Use Permit Review, InTech, Inc., 1055 Gervais Avenue East

Councilmember Lee moved to approve the CUP review for InTech Inc., located at 1055 Gervais Avenue East, and review again in one year.

Seconded by Councilmember Juenemann Ayes – All

The motion passed.

5. Conditional Use Permit Review, McCarrons Water Treatment Plant, 1900 Rice Street North

Councilmember Lee moved to approve the CUP review for McCarrons Water Treatment Plant, located at 1900 Rice Street North, and review again in one year.

Seconded by Councilmember Juenemann Ayes – All

The motion passed.

6. Conditional Use Permit Review, Scooter’s Coffee, 2228 Maplewood Drive

Councilmember Lee moved to approve the CUP review for Scooter’s Coffee, located at 2228 Maplewood Drive North, and review again only if a problem arises or a significant change is proposed.

Seconded by Councilmember Juenemann Ayes – All

The motion passed.

7. Conditional Use Permit Review, Londin Crossing, 2501 Londin Ln

Councilmember Lee moved to approve the CUP review for Londin Crossing, located at 2501 Londin Lane, and review again in one year.

Seconded by Councilmember Juenemann Ayes – All

The motion passed.

8. Conditional Use Permit Review, Xcel Energy, 1555 Century Avenue North

Councilmember Lee moved to approve the CUP review for Xcel Energy, located at 1555 Century Avenue North, and review again in one year.

Seconded by Councilmember Juenemann Ayes – All

The motion passed.

9. Bituminous Material Purchases for 2024 Season

Councilmember Lee moved to authorize the Street Superintendent to purchase bituminous materials in an amount up to \$85,000 for the 2024 street maintenance season.

Seconded by Councilmember Juenemann Ayes – All

The motion passed.

H. PUBLIC HEARINGS – *If you are here for a Public Hearing please familiarize yourself with the Rules of Civility printed on the back of the agenda. Sign in with the City Clerk before addressing the council. At the podium please state your name and address clearly for the record. All comments/questions shall be posed to the Mayor and Council. The Mayor will then direct staff, as appropriate, to answer questions or respond to comments.*
None

I. UNFINISHED BUSINESS
None

J. NEW BUSINESS
None

K. AWARD OF BIDS
None

L. ADJOURNMENT

Mayor Abrams adjourned the meeting at 7:11 p.m.

CITY COUNCIL STAFF REPORT
Meeting Date March 25, 2024

REPORT TO: City Council
REPORT FROM: Michael Sable, City Manager
PRESENTER: Michael Sable, City Manager
AGENDA ITEM: Council Calendar Update

Action Requested: Motion Discussion Public Hearing
Form of Action: Resolution Ordinance Contract/Agreement Proclamation

Policy Issue:

This item is informational and intended to provide the Council an indication on the current planning for upcoming agenda items and the Work Session schedule. These are not official announcements of the meetings, but a snapshot look at the upcoming meetings for the City Council to plan their calendars.

Recommended Action:

No motion needed. This is an informational item.

Upcoming Agenda Items and Work Sessions Schedule:

April 8: To be determined
April 22: Workshop: Update on Purple Line from Met Council Staff

Council Comments:

Comments regarding Workshops, Council Meetings or other topics of concern or interest.

Council Schedule for Maplewood Living through September 2024:

Issue	Contributor	Due Date
April 2024	Villavicencio	March 16, 2024
May 2024	Lee	April 14, 2024
June 2024	Abrams	May 17, 2024
July 2024	Juenemann	June 15, 2024
August 2024	Cave	July 17, 2024
September 2024	Villavicencio	August 17, 2024

Subject to change after election filings in May, as no active candidates will be allowed to contribute.

Upcoming Events:

March 30: Easter Egg Hunt Hunt 1: 9:30 am Hunt 2: 10:30 am Edgerton Gym
Registration is required. Children ages 3 – 8.
April 13: Spring Clean Up Day 8 am – 1 pm Aldrich Arena

CITY COUNCIL STAFF REPORT

Meeting Date March 25, 2024

REPORT TO: Michael Sable, City Manager

REPORT FROM: Brian Bierdeman, Public Safety Director

PRESENTER: Brian Bierdeman, Public Safety Director

AGENDA ITEM: Swearing-In Ceremony for Three Police Officers Rob Anderson, Emma Kral and Lee Schroeder

Action Requested: Motion Discussion Public Hearing

Form of Action: Resolution Ordinance Contract/Agreement Proclamation

Policy Issue:

The Maplewood Police Department has had an open hiring and recruitment process to fill multiple police officer vacancies. Police Officers Rob Anderson, Emma Kral and Lee Schroeder will be officially sworn in with the Maplewood Police Department.

Recommended Action:

For presentation purposes only.

Fiscal Impact:

Is There a Fiscal Impact? No Yes, the true or estimated cost is \$0.00

Financing source(s): Adopted Budget Budget Modification New Revenue Source
 Use of Reserves Other: n/a

Strategic Plan Relevance:

Community Inclusiveness Financial & Asset Mgmt Environmental Stewardship
 Integrated Communication Operational Effectiveness Targeted Redevelopment

N/A

Background:

Officer Rob Anderson was raised in Brooklyn Park, MN. After graduating from the University of St. Thomas, he pursued multiple different career avenues and ultimately started working for the Brooklyn Park Police Department in 2008 as a patrol officer. Throughout his time at BPPD, he worked as a patrol officer, detective, school resource officer, juvenile detective and crisis negotiator.

At the end of 2020, Officer Anderson left law enforcement to pursue a dream of owning his own business. Officer Anderson and his wife own and operate a small business located in Vadnais Heights. With the business running smoothly Officer Anderson decided to come back to law enforcement.

Officer Anderson decided to come to the Maplewood Police Department after speaking with officers who spoke of a strong, supportive administration and city staff. Officer Anderson hopes to become a field-training officer, Sergeant and work with the county crisis negotiation team.

Officer Anderson spends most of his free time with his wife Erica, son Henrik, and bonus kids Madeline and Daniel. They stay active with sports, friends, family and barbecue!

Officer Emma Kral is originally from Graettinger, IA, a small town in the Northwest part of the state. Officer Kral graduated from Iowa Lakes Community College in 2021 with her Associate of Arts Degree. Officer Kral then transferred to Saint Mary's University of Minnesota. In April of 2023, she earned her bachelor's degree in Criminal Justice: Law Enforcement with a minor in Social Justice and Global Diversity.

While attending Saint Mary's, she had the opportunity to complete a summer internship and while searching for departments, her friend and softball teammate, Sophie Cave, mentioned that she should contact the Maplewood Police Department. Sophie also mentioned that her mother, City Council Member Rebecca Cave, would let her stay at their residence during her internship, something for which Officer Kral is very grateful.

After her internship, Officer Kral knew the Maplewood Police Department was the perfect fit for her. She enjoyed working with the administration, staff and officers. Immediately after graduation, Officer Kral became a Community Service Officer in Maplewood. After completing skills at Hennepin Technical College and passing her MN Post Exam, she became an officer in August of 2023. For now, Officer Kral wants to ensure she successfully completes her first year of probation, but hopes to one day become a part of the Mental Health Outreach Team and recruitment committee.

In Officer Kral's time off, she enjoys attending Minnesota Lynx games, going to various concerts and spending time with friends and family. Lastly, Officer Kral wants to thank Lieutenant Michael Dugas, who has been a wonderful mentor throughout this entire process.

Officer Schroeder was born in Coon Rapids and is from Stillwater, Minnesota. Officer Schroeder graduated from Minnesota State University with a Bachelor's degree in Law Enforcement in 2014. Officer Schroeder started his law enforcement career as a Community Service Officer with the MSP Airport Police Department in 2014. In 2016, Officer Schroeder was hired as a Police Officer by the Oak Park Heights Police Dept. While at Oak Park Heights, Officer Schroeder was a field training officer, a firearms instructor, a Taser instructor, Armorer, a mobile field force operator, and a tactical SWAT operator. Officer Schroeder also obtained his certification in mobile forensics during this time.

Officer Schroeder chose to come to the Maplewood Police Department for several reasons. Officer Schroeder enjoyed the diversity Maplewood offered, everything from the diverse population to the numerous opportunities offered within the department. Officer Schroeder went on a ride along, spoke with several members of patrol as well as admin, and loved how the department put family first and truly cares about the well-being of its officers.

Officer Schroeder hopes to continue increasing his skills, especially in the investigation division. Officer Schroeder also hopes to assist in setting up a mobile forensic program within the Maplewood PD.

In Officer Schroeder's free time he enjoys traveling, spending time with his family, and playing with his 2-year-old son, Grayson.

Attachments:

None.

THIS PAGE IS INTENTIONALLY LEFT BLANK

CITY COUNCIL STAFF REPORT

Meeting Date March 25, 2024

REPORT TO: Michael Sable, City Manager
REPORT FROM: Joe Rueb, Finance Director
PRESENTER: Joe Rueb, Finance Director
AGENDA ITEM: Approval of Claims

Action Requested: Motion Discussion Public Hearing
Form of Action: Resolution Ordinance Contract/Agreement Proclamation

Policy Issue:

The City Manager has reviewed the bills and authorized payment in accordance with City Council policies.

Recommended Action:

Motion to approve the approval of claims.

ACCOUNTS PAYABLE:

\$	605,518.71	Checks # 120652 thru # 120689 dated 03/12/24
\$	139,309.18	Checks # 120690 thru # 120713 dated 03/19/24
\$	424,723.12	Disbursements via debits to checking account dated 03/04/24 thru 03/17/24
<hr/>		
\$	1,169,551.01	Total Accounts Payable

PAYROLL

\$	706,544.19	Payroll Checks and Direct Deposits dated 03/15/24
<hr/>		
\$	706,544.19	Total Payroll
<hr/>		
\$	1,876,095.20	GRAND TOTAL

Background

A detailed listing of these claim has been provided. Please call me at 651-249-2902 if you have any questions on the attached listing. This will allow me to check the supporting documentation on file if necessary.

Attachments

1. Listing of Paid Bills

**Check Register
City of Maplewood**

Check	Date	Vendor	Description	Amount
120652	3/5/2024	1 ONE TIME VENDOR	DIRECT DEPOSIT RETURN 3/4/2024	1,356.59
120653	3/12/2024	43 ADAM'S PEST CONTROL INC	PEST CONTROL TREATMENT - PARK MAINT. GARAGE	125.00
	3/12/2024	43 ADAM'S PEST CONTROL INC	CITY HALL PEST CONTROL TREATMENT	125.00
120653	3/12/2024	43 ADAM'S PEST CONTROL INC	PEST CONTROL TREATMENT AT PUBLIC WORKS	125.00
120654	3/12/2024	7024 BEAUDRY OIL & SERVICE INC	CONTRACT GAS AND DIESEL FUEL - MARCH 2024	20,962.99
120655	3/12/2024	5786 COLONIAL LIFE PROCESSING CTR	E4677316 PREMIUM - FEBRUARY 2024	285.02
120656	3/12/2024	6320 COMPANION ANIMAL CONTROL	ANIMAL CONTROL SERVICES - FEB	100.00
120657	3/12/2024	2909 COMPASS MINERALS AMERICA INC.	ROAD SALT PURCHASED UNDER STATE CONTRACT	2,381.49
	3/12/2024	2909 COMPASS MINERALS AMERICA INC.	ROAD SALT PURCHASED UNDER STATE CONTRACT	16,607.80
120658	3/12/2024	7028 COVENANT SECURITY EQUIPMENT	SECURITY DROP-BOX AT CITY HALL	2,351.74
120659	3/12/2024	4371 ELECTRO WATCHMAN INC.	REMOVAL OF UNUSED PANIC BUTTONS AT 1902	272.50
120660	3/12/2024	464 EMERGENCY AUTOMOTIVE TECH, INC	BUILD OF NEW SQUAD 949 VIN#1C4RDJFG0PC597679	5,034.34
120661	3/12/2024	5222 MARTIN-MCALLISTER	2 PUBLIC SAFETY ASSESSMENTS	1,250.00
120662	3/12/2024	6438 METRO - INET	METRO-INET MONTHLY PAYMENT JAN	9,490.00
	3/12/2024	6438 METRO - INET	METRO-INET MONTHLY PAYMENT FEB	9,490.00
120663	3/12/2024	5838 MINNESOTA BENEFIT ASSOCIATION	MONTHLY PREMIUM - APRIL 2024	346.73
120664	3/12/2024	7025 MINNESOTA TRUCK AND TRAILER	M311 FENDER REPAIR	4,486.77
120665	3/12/2024	6257 NINE NORTH	FEBRUARY 2024 MUNICIPAL MEETING	683.28
120666	3/12/2024	6269 OPTUM	JANUARY 2024 - EMPLOYER HSA FEES	93.50
120667	3/12/2024	5667 PROTEK LIGHTING SOLUTIONS LLC	CITY CAMPUS BOLLARD BASE REPAIR	226.74
120668	3/12/2024	6111 QUADIENT FINANCE USA, INC.	POSTAGE - CITY HALL POSTAGE MACHINE	958.51
	3/12/2024	6111 QUADIENT FINANCE USA, INC.	PUBLIC WORKS POSTAGE	1,053.00
120669	3/12/2024	6014 REHDER FORESTRY CONSULTING	FEBRUARY 2024 TREE INSP. SERVICES	1,052.91
	3/12/2024	6014 REHDER FORESTRY CONSULTING	TREE INSPECTION SERVICES - JAN	140.12
120670	3/12/2024	5879 ROADKILL ANIMAL CONTROL	ROADKILL REMOVAL - FEBRUARY 2024	129.00
120671	3/12/2024	4256 SHI INTERNATIONAL CORP	CISCO SWITCH FOR PSCV	1,914.28
	3/12/2024	4256 SHI INTERNATIONAL CORP	ADDITIONAL ADOBE PRO LICENSES FOR POLICE SERGEANTS	354.10
	3/12/2024	4256 SHI INTERNATIONAL CORP	CISCO SMARTNET FOR PSCV SWITCH	638.05
120672	3/12/2024	6456 ST CROIX FIRE & SAFETY INC	TWO REPLACEMENT FIRE EXTINGUISHERS AT MNC	166.00
120673	3/12/2024	198 ST PAUL REGIONAL WATER SRVS	WATER UTILITY	44.12
	3/12/2024	198 ST PAUL REGIONAL WATER SRVS	WATER UTILITY	268.99
	3/12/2024	198 ST PAUL REGIONAL WATER SRVS	WATER UTILITY	67.39
	3/12/2024	198 ST PAUL REGIONAL WATER SRVS	WATER UTILITY	62.87
	3/12/2024	198 ST PAUL REGIONAL WATER SRVS	WATER UTILITY	180.39
	3/12/2024	198 ST PAUL REGIONAL WATER SRVS	WATER UTILITY	126.15
	3/12/2024	198 ST PAUL REGIONAL WATER SRVS	WATER UTILITY	276.11
	3/12/2024	198 ST PAUL REGIONAL WATER SRVS	WATER UTILITY	44.12
	3/12/2024	198 ST PAUL REGIONAL WATER SRVS	WATER UTILITY	62.87
	3/12/2024	198 ST PAUL REGIONAL WATER SRVS	WATER UTILITY	94.51
	3/12/2024	198 ST PAUL REGIONAL WATER SRVS	WATER UTILITY	639.49
120674	3/12/2024	1565 SWEEPER SERVICES	SERVICE/MAINTENANCE ON STREET SWEEPER, UNIT 714	2,244.04
120675	3/12/2024	1730 W W GOETSCH ASSOCIATES, INC.	STORM LIFT STATION REPAIR 9/12/23 - COPE AVE	1,186.00
120676	3/12/2024	5114 BOLTON & MENK, INC.	PROJ 21-02 MCMENEMY ST IMP PRO DESIGN SERVICES	8,010.00
	3/12/2024	5114 BOLTON & MENK, INC.	GENERAL GIS ASSISTANCE	2,195.00
120677	3/12/2024	5312 ENVUE TELEMATICS, LLC	GEO TAB PRO PLAN FEBRUARY FEE	624.00
120678	3/12/2024	585 GOPHER STATE ONE-CALL	NET BILLABLE CALL TICKETS - FEB 2024	252.45
120679	3/12/2024	687 HUGO'S TREE CARE INC	TREE REMOVAL WEST OF 1949 COPE AVE - CITY PROPERTY	3,500.00
120680	3/12/2024	875 LOFFLER COMPANIES, INC.	CANON MONTHLY USAGE CHARGES - JANUARY	915.85
	3/12/2024	875 LOFFLER COMPANIES, INC.	CANON MONTHLY USAGE CHARGES - FEBRUARY	937.59
120681	3/12/2024	2696 MUSKA ELECTRIC CO	WIRE AND PULL WIRE NEW AIR COMPRESSOR	3,509.08
120682	3/12/2024	1202 NYSTROM PUBLISHING CO INC	MAPLEWOOD LIVING - MARCH	8,053.24
120683	3/12/2024	5670 PETERSON COUNSELING/CONSULTING	SERVICE FEES - JAN 2024	1,712.50
	3/12/2024	5670 PETERSON COUNSELING/CONSULTING	SERVICE FEES - FEB 2024	1,775.00
120684	3/12/2024	6273 SRF CONSULTING GROUP INC.	PROJ 23-08 PROF DESIGN SERVICES ENDING JAN 21,2024	33,330.98
120685	3/12/2024	1574 T A SCHIFSKY & SONS, INC	PROJ 21-07 GERVAIS AREA PAVE REHAB - FINAL PAYMENT	263,535.44
	3/12/2024	1574 T A SCHIFSKY & SONS, INC	PROJ 21-02 PMT NO 13 - FINAL PAYMENT	178,659.67
120686	3/12/2024	3334 UNIQUE PAVING MATERIALS CORP	WINTER PATCHING MATERIAL	1,118.84
120687	3/12/2024	1190 XCEL ENERGY	ELECTRIC & GAS UTILITY	3,145.39
	3/12/2024	1190 XCEL ENERGY	ELECTRIC & GAS UTILITY	(2,399.73)
	3/12/2024	1190 XCEL ENERGY	ELECTRIC & GAS UTILITY	4,916.13

**Check Register
City of Maplewood**

Check	Date	Vendor	Description	Amount
	3/12/2024	1190 XCEL ENERGY	ELECTRIC UTILITY	19.78
120688	3/12/2024	5013 YALE MECHANICAL LLC	SOUTH FIRE STATION HVAC MAINT.	412.00
	3/12/2024	5013 YALE MECHANICAL LLC	NORTH FIRE STATION - WATER HEATER REPAIR	1,039.99
120689	3/12/2024	5761 YMCA	EMPLOYEE MEMBERSHIPS - OCT	1,346.00
	3/12/2024	5761 YMCA	EMPLOYEE MEMBERSHIPS - JAN	1,412.00
39 Checks in this report.				605,518.71

**Check Register
City of Maplewood**

Check	Date	Vendor	Description	Amount
120691	3/19/2024	1175 CITY OF NORTH ST PAUL	MONTHLY UTILITIES - FEBRUARY	3,132.01
120692	3/19/2024	1771 CITY OF WHITE BEAR LAKE	VIN #6275 TAB RENEWAL	16.25
120693	3/19/2024	5313 GRAPHIC DESIGN, INC.	BUSINESS CARDS	304.56
120694	3/19/2024	6009 HEALTHCALL, LLC	PARAMEDIC ELECTRONIC PATIENT CARE SOFTWARE - JAN	920.00
120695	3/19/2024	846 LANGUAGE LINE SERVICES	PHONE INTERPRETIVE SERVICES FEBRUARY	482.41
120696	3/19/2024	7007 LEGALSHIELD PPLSI	MONTHLY PREMIUM - MARCH 2024	763.60
120697	3/19/2024	6336 LUTHERAN CHURCH OF PEACE	PNP ELECTION - USE OF FACILITY POLLING PLACE	200.00
120698	3/19/2024	6269 OPTUM	FEBRUARY 2024 - EMPLOYER HSA FEES	101.75
120699	3/19/2024	4112 PROFESSIONAL WIRELESS COMM	REPLACEMENT BATTERIES FOR TWO WAY RADIOS	197.50
120700	3/19/2024	2008 RAMSEY COUNTY PUBLIC WORKS	REPLACE & REPAIR SIGNAL LUMNAIRES	2,300.00
120701	3/19/2024	1836 ST PAUL, CITY OF	STREET LIGHT REPAIR - JANUARY	453.00
	3/19/2024	1836 ST PAUL, CITY OF	MATERIALS FOR STREET LIGHT REPAIR - JANUARY	32.82
120702	3/19/2024	6107 TOKLE INSPECTIONS, INC.	ELECTRICAL INSPECTIONS - FEB 2024	8,995.24
120703	3/19/2024	5663 TRANS UNION LLC	FEBRUARY CREDIT REPORTS	87.20
120704	3/19/2024	6485 TRUEPOINT SOLUTIONS	ON-CALL SUPPORT FOR CD AND PW JAN 2024	5,610.00
	3/19/2024	6485 TRUEPOINT SOLUTIONS	ON-CALL SUPPORT FOR CD AND PW FEB 2024	1,856.25
120705	3/19/2024	5805 AXON ENTERPRISE, INC.	COMMAND VEHICLE TETHERED DRONE	72,317.67
120706	3/19/2024	5312 ENVUE TELEMATICS, LLC	GEO TAB PRO PLAN JANUARY FEE	624.00
120707	3/19/2024	5598 KELLY & LEMMONS, P.A.	PROSECUTION SERVICES - FEBRUARY	16,907.00
120708	3/19/2024	6084 LINCOLN FINANCIAL GROUP	MONTHLY PREMIUM - MARCH 2024	9,647.55
120709	3/19/2024	532 MADDEN GALANTER HANSEN, LLP	HR ATTORNEY FEES - FEB 2024	3,321.30
120710	3/19/2024	1337 RAMSEY COUNTY-PROP REC & REV	FLEET SUPPORT FEE - FEBRUARY	574.08
120711	3/19/2024	5628 SITEIMPROVE, INC.	SUBSCRIPTION SERVICE FEE 2024	4,530.85
120712	3/19/2024	1190 XCEL ENERGY	STREET LIGHTS	2,294.47
	3/19/2024	1190 XCEL ENERGY	STREET LIGHTS	7,019.66
	3/19/2024	1190 XCEL ENERGY	STREET LIGHTS	19.71
	3/19/2024	1190 XCEL ENERGY	STREET LIGHTS	9,376.83
	3/19/2024	1190 XCEL ENERGY	STREET LIGHTS	(14,270.64)
	3/19/2024	1190 XCEL ENERGY	ELECTRIC & GAS UTILITY	393.85
	3/19/2024	1190 XCEL ENERGY	FIRE SIRENS	55.40
	3/19/2024	1190 XCEL ENERGY	FIRE SIRENS	(20.09)
	3/19/2024	1190 XCEL ENERGY	ELECTRIC & GAS UTILITY	75.75
	3/19/2024	1190 XCEL ENERGY	ELECTRIC & GAS UTILITY	32.20
120713	3/19/2024	5013 YALE MECHANICAL LLC	FALL HVAC MAINT. - SO FIRE STATION	957.00
23 Checks in this report.				139,309.18

CITY OF MAPLEWOOD
Disbursements via Debits to Checking Account

Settlement Date	Payee	Description	Amount
3/4/2024	Delta Dental	Dental Premium	\$ 3,823.42
3/11/2024	Delta Dental	Dental Premium	2,061.98
3/4/2024	Empower - State Plan	PR - Deferred Compensation	29,978.00
3/5/2024	ICMA (Vantagepointe)	PR - Retiree Health Savings	6,688.86
3/15/2024	ICMA (Vantagepointe)	Retiree Health Savings	1,100.00
3/15/2024	Labor Unions	PR - Union Dues	4,281.83
3/15/2024	MidAmerica	HRA Flex Plan - AUL	17,150.15
3/4/2024	MN State Treasurer	PR - State Payroll Tax	30,854.20
3/8/2024	Optum Health	DCRP & Flex Plan Payments	176.76
3/15/2024	Optum Health	DCRP & Flex Plan Payments	384.82
3/4/2024	Optum Health	H.S.A. Payments	7,727.62
3/15/2024	P.E.R.A.	PR - P.E.R.A.	153,931.28
3/15/2024	U.S. Treasurer	PR - Federal Payroll Tax	122,143.26
3/15/2024	US Bank VISA One Card*	Purchasing Card Items	44,420.94
			<u>\$ 424,723.12</u>

**CITY OF MAPLEWOOD
EMPLOYEE GROSS EARNINGS REPORT
FOR THE CURRENT PAY PERIOD**

<u>CHECK #</u>	<u>DATE</u>	<u>EMPLOYEE NAME</u>	<u>AMOUNT</u>	Exp Reimb, Severance, Conversion incl in Amount
	03/15/24	ABRAMS, MARYLEE	\$ 793.92	\$ 123.52
	03/15/24	CAVE, REBECCA	590.40	
	03/15/24	JUENEMANN, KATHLEEN	590.40	
	03/15/24	LEE, CHONBURI	590.40	
	03/15/24	VILLAVICENCIO, NICHOLE	590.40	
	03/15/24	DARROW, MICHAEL	6,355.35	
	03/15/24	KNUTSON, LOIS	3,936.13	
	03/15/24	CHRISTENSON, SCOTT	2,825.23	
	03/15/24	DOUGLASS, TOM	3,268.05	
	03/15/24	JAHN, DAVID	2,646.94	
	03/15/24	LENTINI, LINDSAY	3,313.33	
	03/15/24	RAMEAUX, THERESE	4,092.26	
	03/15/24	BREIMHURST, LAUREN	2,486.60	
	03/15/24	JACOBSON, CARL	4,729.68	
	03/15/24	RACETTE, THOMAS	3,123.65	
	03/15/24	RUEB, JOSEPH	6,046.62	
	03/15/24	STANLEY, JENNIFER	3,992.20	
	03/15/24	ARNOLD, AJLA	3,167.09	
	03/15/24	COMMERS, CHERYL	558.00	
	03/15/24	EVANS, CHRISTINE	3,731.57	
	03/15/24	LARSON, MICHELLE	2,550.64	
	03/15/24	SINDT, ANDREA	4,499.46	
	03/15/24	MOY, PAMELA	2,507.11	
	03/15/24	MAHRE, GERALDINE	63.00	
	03/15/24	ABDIRISAK, ABDULLAHI	3,422.40	
	03/15/24	ANDERSON, ROBERT	3,904.99	
	03/15/24	BELDE, STANLEY	1,005.91	115.91
	03/15/24	BENJAMIN, MARKESE	4,284.62	
	03/15/24	BERGERON, ASHLEY	4,180.81	
	03/15/24	BIERDEMAN, BRIAN	7,042.48	
	03/15/24	BORN, BRIAN	3,533.18	
	03/15/24	BURT-MCGREGOR, EMILY	5,016.62	
	03/15/24	BUSACK, DANIEL	6,052.93	
	03/15/24	CONDON, MITCHELL	3,988.19	
	03/15/24	COX, RACHEL	1,601.63	
	03/15/24	CRUZ, TREANA	3,756.99	
	03/15/24	DEMULLING, JOSEPH	5,840.69	345.60
	03/15/24	DUGAS, MICHAEL	5,502.81	
	03/15/24	FORSYTHE, MARCUS	4,525.59	
	03/15/24	FRITZE, DEREK	4,524.41	
	03/15/24	GABRIEL, ANTHONY	6,296.96	

**CITY OF MAPLEWOOD
EMPLOYEE GROSS EARNINGS REPORT
FOR THE CURRENT PAY PERIOD**

<u>CHECK #</u>	<u>DATE</u>	<u>EMPLOYEE NAME</u>	<u>AMOUNT</u>	<u>Exp Reimb, Severance, Conversion incl in Amount</u>
	03/15/24	GEISELHART, BENJAMIN	3,894.64	
	03/15/24	GIVAND, JONATHAN	4,004.01	
	03/15/24	GREEN, JAMIE	3,904.99	
	03/15/24	HAWKINSON, TIMOTHY	4,459.39	
	03/15/24	HER, PHENG	4,379.62	
	03/15/24	HER, TERRELL	4,281.95	
	03/15/24	HOEMKE, MICHAEL	5,502.81	
	03/15/24	HOLTY, BRYCE	3,711.17	
	03/15/24	JOHNSON, BARBARA	2,089.60	
	03/15/24	KADEN, JACOB	3,746.30	
	03/15/24	KIM, WINSTON	4,650.17	
	03/15/24	KONG, TOMMY	4,944.07	
	03/15/24	KRAL, EMMA	3,728.54	
	03/15/24	KROLL, BRETT	5,607.64	3,354.64
	03/15/24	KROLL, LISA	9,957.64	10,345.60
	03/15/24	KUCHENMEISTER, GINA	2,586.41	
	03/15/24	KUCHENMEISTER, JASON	2,431.20	
	03/15/24	LANGNER, TODD	390.00	
	03/15/24	LENERTZ, NICHOLAS	3,904.99	
	03/15/24	LYNCH, KATHERINE	4,555.37	
	03/15/24	MALLET, MICHAEL	3,904.99	
	03/15/24	MARINO, JASON	4,670.08	
	03/15/24	MARK, OLAF	1,404.00	
	03/15/24	MORALES, MARIO	2,089.60	
	03/15/24	MURRAY, RACHEL	4,459.39	
	03/15/24	NYE, MICHAEL	5,310.68	
	03/15/24	PASDO, JOSEPH	3,776.31	
	03/15/24	PATROS, CLARE	1,932.80	
	03/15/24	PETERS, DANIEL	4,063.19	
	03/15/24	PIPKIN, JULIA	3,341.17	
	03/15/24	QUIRK, JAMES	3,814.80	
	03/15/24	RETHWILL, SCOTT	4,193.71	
	03/15/24	SALCHOW, CONNOR	4,651.85	
	03/15/24	SCHROEDER, LEE	3,904.99	
	03/15/24	SHANLEY, HAYLEY	2,298.40	
	03/15/24	SHEA, STEPHANIE	3,158.62	
	03/15/24	STARKEY, ROBERT	4,457.75	
	03/15/24	STEINER, JOSEPH	5,502.81	
	03/15/24	STOCK, AUBREY	4,554.17	
	03/15/24	SUEDKAMP, ADAM	4,219.39	
	03/15/24	SWETALA, NOAH	4,081.19	

**CITY OF MAPLEWOOD
EMPLOYEE GROSS EARNINGS REPORT
FOR THE CURRENT PAY PERIOD**

<u>CHECK #</u>	<u>DATE</u>	<u>EMPLOYEE NAME</u>	<u>AMOUNT</u>	<u>Exp Reimb, Severance, Conversion incl in Amount</u>
	03/15/24	TAUZELL, BRIAN	5,151.53	
	03/15/24	ULVENES, AMANDA	1,988.19	
	03/15/24	WEAVER, TAWNY	3,559.21	
	03/15/24	WENZEL, JAY	4,547.65	
	03/15/24	WERTH, JENNIFER	2,497.60	
	03/15/24	WIETHORN, AMANDA	4,067.64	
	03/15/24	XIONG, KAO	4,478.14	
	03/15/24	XIONG, PETER	3,559.20	
	03/15/24	XIONG, TUOYER	3,809.28	
	03/15/24	YANG, TANGURAY	1,818.04	
	03/15/24	YANG, THANG	3,559.20	
	03/15/24	ZAPPA, ANDREW	5,493.07	
	03/15/24	BARRETTE, CHARLES	4,450.04	
	03/15/24	BAUMAN, ANDREW	4,666.10	
	03/15/24	BEITLER, NATHAN	4,147.98	
	03/15/24	CAMPBELL, MACLANE	3,304.91	
	03/15/24	CHANG, KENG	420.00	
	03/15/24	COOK, NICKLAUS	4,019.11	
	03/15/24	COOK, TANNER	4,021.87	
	03/15/24	CRAWFORD, RAYMOND	4,073.23	
	03/15/24	CRUMMY, CHARLES	4,332.35	
	03/15/24	DABRUZZI, THOMAS	4,500.57	
	03/15/24	DAVISON, BRADLEY	4,168.73	
	03/15/24	HAGEN, JOHN	4,981.28	
	03/15/24	HAGEN, MICHAEL	4,126.43	
	03/15/24	HALWEG, JODI	4,073.24	
	03/15/24	HANG, RYAN	3,194.70	
	03/15/24	HAWTHORNE, ROCHELLE	5,199.46	
	03/15/24	KUBAT, ERIC	5,107.11	
	03/15/24	LANDER, CHARLES	4,198.07	
	03/15/24	LANIK, JAKE	4,255.04	
	03/15/24	MALESKI, MICHAEL	4,755.36	
	03/15/24	MCGEE, BRADLEY	4,250.63	
	03/15/24	MERKATORIS, BRETT	4,667.45	
	03/15/24	MILLER, SETH	4,202.47	
	03/15/24	MONDOR, MICHAEL	6,924.36	
	03/15/24	NEILY, STEVEN	4,806.11	
	03/15/24	NELSON, GRADON	5,640.27	
	03/15/24	NIELSEN, KENNETH	4,177.65	
	03/15/24	NOVAK, JEROME	4,204.34	
	03/15/24	ORLANDO, TYLER	5,061.50	

**CITY OF MAPLEWOOD
EMPLOYEE GROSS EARNINGS REPORT
FOR THE CURRENT PAY PERIOD**

<u>CHECK #</u>	<u>DATE</u>	<u>EMPLOYEE NAME</u>	<u>AMOUNT</u>	<u>Exp Reimb, Severance, Conversion incl in Amount</u>
	03/15/24	POWERS, KENNETH	4,525.74	
	03/15/24	SCHROEDER, RYAN	4,927.20	
	03/15/24	SEDLACEK, JEFFREY	4,344.93	
	03/15/24	SOHRWEIDE, TYSON	3,537.79	
	03/15/24	SPANDE, KAYLA	801.07	
	03/15/24	WARDELL, JORDAN	4,141.55	
	03/15/24	WILLIAMSON, MICHAEL	4,264.26	
	03/15/24	ZAPPA, ERIC	3,919.79	
	03/15/24	CORTESI, LUANNE	2,504.80	
	03/15/24	JANASZAK, MEGHAN	3,695.52	
	03/15/24	BRINK, TROY	3,914.66	
	03/15/24	BUCKLEY, BRENT	3,293.80	
	03/15/24	EDGE, DOUGLAS	3,292.67	
	03/15/24	HERBST, JONATHEN	2,673.67	
	03/15/24	JORDAN, TIMOTHY	2,524.65	
	03/15/24	MEISSNER, BRENT	3,256.05	
	03/15/24	MLODZIK, JASON	3,013.09	
	03/15/24	MORRIS-KARL, AIDEN	2,484.39	
	03/15/24	RUNNING, ROBERT	3,261.65	
	03/15/24	TEVLIN, TODD	3,254.86	
	03/15/24	YANG, SOLOMAN	2,382.99	
	03/15/24	DUCHARME, JOHN	3,643.82	
	03/15/24	ENGSTROM, ANDREW	3,641.51	
	03/15/24	JAROSCH, JONATHAN	4,918.84	
	03/15/24	LOVE, STEVEN	7,041.12	
	03/15/24	STEJSKAL, JAYSON	3,237.79	
	03/15/24	STRONG, TYLER	3,694.59	
	03/15/24	AMENYA, FLORENCE	110.50	
	03/15/24	CAMPBELL, NOAH	48.75	
	03/15/24	GERNES, CAROLE	3,184.25	
	03/15/24	MCKANE, QUINN	357.50	
	03/15/24	FRIBERG, DAVID	2,514.09	
	03/15/24	HAYS, TAMARA	2,762.23	
	03/15/24	HINNENKAMP, GARY	3,692.12	
	03/15/24	NAUGHTON, JOHN	3,048.21	
	03/15/24	ORE, JORDAN	3,054.83	
	03/15/24	STOKES, KAL	2,872.29	
	03/15/24	BEGGS, REGAN	2,747.29	
	03/15/24	HAMMOND, ELIZABETH	2,725.94	
	03/15/24	JOHNSON, ELIZABETH	2,744.99	
	03/15/24	JOHNSON, RANDY	4,918.83	

**CITY OF MAPLEWOOD
EMPLOYEE GROSS EARNINGS REPORT
FOR THE CURRENT PAY PERIOD**

<u>CHECK #</u>	<u>DATE</u>	<u>EMPLOYEE NAME</u>	<u>AMOUNT</u>	<u>Exp Reimb, Severance, Conversion incl in Amount</u>
	03/15/24	PARR, DANETTE	7,328.57	
	03/15/24	SCHORR, JENNIFER	2,180.19	
	03/15/24	FINWALL, SHANN	4,091.41	
	03/15/24	MARTIN, MICHAEL	4,837.30	
	03/15/24	LENTZ, DANIEL	3,496.99	
	03/15/24	THIENES, PAUL	3,318.22	
	03/15/24	WESTLUND, RONALD	3,171.95	
	03/15/24	YOUNG, MATTHEW	3,008.83	
	03/15/24	WELLENS, MOLLY	2,870.14	
	03/15/24	BJORK, BRANDON	117.00	
	03/15/24	BRENEMAN, NEIL	3,695.52	
	03/15/24	CAMPBELL, KEVIN	110.50	
	03/15/24	GORACKI, GERALD	185.25	
	03/15/24	MOORE, PATRICK	117.00	
	03/15/24	ROBBINS, AUDRA	5,046.33	
	03/15/24	BERGO, CHAD	4,026.61	
	03/15/24	SCHMITZ, KEVIN	2,757.30	
	03/15/24	SHEERAN JR, JOSEPH	4,919.07	
	03/15/24	ADAMS, DAVID	3,258.19	
	03/15/24	JENSEN, JOSEPH	2,900.19	
	03/15/24	JONES, DONALD	3,087.21	
	03/15/24	SCHULTZ, SCOTT	4,946.33	
	03/15/24	WILBER, JEFFREY	3,051.75	
	03/15/24	PRIEM, STEVEN	3,376.24	
	03/15/24	WOEHRLE, MATTHEW	3,406.46	
	03/15/24	XIONG, BOON	3,598.53	
	03/15/24	FOWLDS, MYCHAL	6,078.83	
	03/15/24	FRANZEN, NICHOLAS	5,081.57	
	03/15/24	GERONSIN, ALEXANDER	3,766.45	
	03/15/24	RENNER, MICHAEL	3,230.49	
			<u>\$ 706,544.19</u>	<u>\$ 14,285.27</u>

Purchasing Card Items

Transaction Date	Posting Date	Merchant Name	Transaction Amount	Name
2/26/2024	2/27/2024	AMZN MKTP US*RZ9W52QU0	\$ 20.07	CHAD BERGO
2/28/2024	2/29/2024	AMZN MKTP US*RZ61043M2	265.00	NEIL BRENEMAN
3/1/2024	3/1/2024	AMZN MKTP US*RW5FB3WE1	69.90	NEIL BRENEMAN
3/1/2024	3/4/2024	DALCO ENTERPRISES	153.15	NEIL BRENEMAN
3/1/2024	3/4/2024	FUN EXPRESS	156.87	NEIL BRENEMAN
3/4/2024	3/4/2024	AMZN MKTP US*RZ0XU3P81	49.30	NEIL BRENEMAN
2/28/2024	2/29/2024	CINTAS CORP	187.56	TROY BRINK
2/28/2024	3/1/2024	MALCO PRODUCTS, INC.	74.88	TROY BRINK
3/6/2024	3/7/2024	CINTAS CORP	388.78	TROY BRINK
2/28/2024	3/1/2024	THE HOME DEPOT 2801	362.20	BRENT BUCKLEY
2/29/2024	3/1/2024	IN *BRODIN STUDIOS, INC.	249.05	DANIEL BUSACK
3/4/2024	3/5/2024	GRAPHIC DESIGN INC	155.56	DANIEL BUSACK
2/22/2024	2/26/2024	THE HOME DEPOT #2801	3.68	SCOTT CHRISTENSON
2/27/2024	2/29/2024	THE HOME DEPOT #2801	(26.43)	SCOTT CHRISTENSON
2/28/2024	2/29/2024	GRAINGER	57.18	SCOTT CHRISTENSON
2/29/2024	3/4/2024	THE HOME DEPOT #2801	12.36	SCOTT CHRISTENSON
3/7/2024	3/8/2024	NARDINI FIRE EQUIPMENT	1,054.00	SCOTT CHRISTENSON
3/7/2024	3/8/2024	NARDINI FIRE EQUIPMENT	687.50	SCOTT CHRISTENSON
2/23/2024	2/26/2024	NATIONAL REGISTRY EMT	32.00	BRAD DAVISON
3/6/2024	3/6/2024	SQ *MINNESOTA CIT OFFICER	975.00	JOSEPH DEMULLING
2/29/2024	2/29/2024	AMZN MKTP US*RZ9834YE0	106.65	TOM DOUGLASS
2/23/2024	2/26/2024	WPSG, INC.	92.74	MICHAEL DUGAS
2/28/2024	3/1/2024	ODP BUS SOL LLC # 101090	316.95	CHRISTINE EVANS
2/29/2024	3/1/2024	SAMS CLUB #6309	80.88	CHRISTINE EVANS
3/5/2024	3/6/2024	CHILIS 1748 ECOMM	105.04	CHRISTINE EVANS
3/6/2024	3/6/2024	PANERA BREAD #601305 O	102.27	CHRISTINE EVANS
3/6/2024	3/6/2024	PANERA BREAD #601305 O	13.75	CHRISTINE EVANS
2/29/2024	3/1/2024	CRADLEPOINT	1,424.07	MYCHAL FOWLDS
3/1/2024	3/4/2024	COMCAST BUSINESS	413.00	MYCHAL FOWLDS
3/1/2024	3/4/2024	COMCAST BUSINESS	413.00	MYCHAL FOWLDS
3/4/2024	3/5/2024	AMZN MKTP US*RZ3DT7IT2	34.99	MYCHAL FOWLDS
3/5/2024	3/6/2024	AMZN MKTP US*RN8QO5OS2	111.90	MYCHAL FOWLDS
3/6/2024	3/6/2024	AMZN MKTP US*RN94Y9NT2	86.39	MYCHAL FOWLDS
3/6/2024	3/7/2024	AMZN MKTP US*RZ5SW22W1	50.19	MYCHAL FOWLDS
3/6/2024	3/7/2024	CANON *PAYMENT	267.52	MYCHAL FOWLDS
3/6/2024	3/7/2024	CANON *PAYMENT	129.98	MYCHAL FOWLDS
3/6/2024	3/7/2024	CANON *PAYMENT	1,728.50	MYCHAL FOWLDS
3/6/2024	3/7/2024	CANON *PAYMENT	590.52	MYCHAL FOWLDS
3/6/2024	3/7/2024	CENTURYLINK LUMEN	64.74	MYCHAL FOWLDS
2/23/2024	2/26/2024	APPLE.COM/US	1,299.00	NICK FRANZEN
2/23/2024	2/26/2024	AJ TEK CORPORATION	90.00	NICK FRANZEN
2/24/2024	2/26/2024	AMZN MKTP US*RW4PQ4FX1	71.95	NICK FRANZEN
3/5/2024	3/6/2024	CDW GOVT #PX83519	381.61	NICK FRANZEN
3/6/2024	3/7/2024	MSFT * E0500RA4BK	8.00	NICK FRANZEN

Purchasing Card Items

Transaction Date	Posting Date	Merchant Name	Transaction Amount	Name
3/6/2024	3/7/2024	MSFT * E0500RA5U1	10.00	NICK FRANZEN
3/7/2024	3/7/2024	MSFT * E0500RA9NV	8.00	NICK FRANZEN
2/26/2024	2/27/2024	FLEET FARM 2700	22.99	DAVID FRIBERG
3/1/2024	3/4/2024	THE HOME DEPOT #2801	38.50	DAVID FRIBERG
3/5/2024	3/7/2024	MENARDS 3385	6.87	DAVID FRIBERG
3/6/2024	3/7/2024	SQ *MINNESOTA CIT OFFICER	200.00	TONY GABRIEL
3/2/2024	3/4/2024	AMAZON RETAIL* 41246	4.29	ALEX GERONSIN
2/23/2024	2/26/2024	SQ *FULLY INVOLVED LEATHE	173.93	MICHAEL HAGEN
2/29/2024	3/1/2024	ASPEN MILLS	1,201.19	MICHAEL HAGEN
3/1/2024	3/4/2024	AIRGAS - NORTH	146.75	MICHAEL HAGEN
3/1/2024	3/4/2024	AIRGAS - NORTH	350.00	MICHAEL HAGEN
3/1/2024	3/4/2024	AIRGAS - NORTH	320.77	MICHAEL HAGEN
3/5/2024	3/6/2024	ASPEN MILLS	34.50	MICHAEL HAGEN
3/6/2024	3/7/2024	AIRGAS - NORTH	446.60	MICHAEL HAGEN
3/6/2024	3/7/2024	AIRGAS - NORTH	336.78	MICHAEL HAGEN
3/6/2024	3/7/2024	GALLS	260.99	MICHAEL HAGEN
2/23/2024	2/26/2024	THE HOME DEPOT #2801	21.97	TAMARA HAYS
3/1/2024	3/4/2024	SQ *CORPORATE MARK, INC.	61.00	MICHAEL HOEMKE
3/5/2024	3/7/2024	THE HOME DEPOT #2801	19.98	MICHAEL HOEMKE
3/5/2024	3/7/2024	THE HOME DEPOT #2801	33.98	MICHAEL HOEMKE
3/7/2024	3/8/2024	BLAUER MANUFACTURING	899.96	MICHAEL HOEMKE
2/27/2024	2/29/2024	THE HOME DEPOT #2801	44.81	DAVID JAHN
2/29/2024	3/4/2024	DALCO ENTERPRISES	(404.40)	DAVID JAHN
3/8/2024	3/8/2024	AMZN MKTP US*RN0JL2VD2	205.35	MEGHAN JANASZAK
2/23/2024	2/26/2024	HOBBY LOBBY #587	41.88	BARB JOHNSON
2/26/2024	2/26/2024	AMZN MKTP US*RW4HV7TM1	133.53	BARB JOHNSON
3/2/2024	3/4/2024	AMZN MKTP US*RZ3FB4QE2	84.47	BARB JOHNSON
3/5/2024	3/6/2024	AMERICAN PLANNING ASSOCI	101.00	RANDY JOHNSON
3/7/2024	3/8/2024	RED WING SHOE #727	307.98	DON JONES
2/28/2024	3/1/2024	ODP BUS SOL LLC # 105910	32.75	LOIS KNUTSON
2/28/2024	3/1/2024	ODP BUS SOL LLC # 101090	51.98	LOIS KNUTSON
2/29/2024	3/4/2024	PARTY CITY 1138	39.23	LOIS KNUTSON
2/29/2024	3/4/2024	STARBUCKS STORE 57157	43.35	LOIS KNUTSON
3/1/2024	3/1/2024	ALLIANCE FOR INNOVATIO	950.00	LOIS KNUTSON
3/1/2024	3/4/2024	HY-VEE DOTCOM WDM 6002	110.85	LOIS KNUTSON
3/1/2024	3/4/2024	STERICYCLE INC/SHRED-IT	81.35	LOIS KNUTSON
2/23/2024	3/1/2024	MEXICAN TO THE BONE	73.35	ERIC KUBAT
3/6/2024	3/7/2024	NFSA	50.00	ERIC KUBAT
3/6/2024	3/8/2024	MN IAAI	275.00	ERIC KUBAT
3/1/2024	3/4/2024	PAYPAL *PUTTERPLATI	20.75	MICHAEL MALESKI
3/5/2024	3/7/2024	DELTA AIR 0067027740284	308.10	MICHAEL MALESKI
3/5/2024	3/7/2024	DELTA AIR 0067027736525	268.10	MICHAEL MALESKI
3/5/2024	3/7/2024	DELTA AIR 0067027736526	268.10	MICHAEL MALESKI
3/5/2024	3/7/2024	DELTA AIR 0067027736530	268.10	MICHAEL MALESKI

Purchasing Card Items

Transaction Date	Posting Date	Merchant Name	Transaction Amount	Name
3/6/2024	3/8/2024	CLARION EVENTS INC	190.00	MICHAEL MALESKI
3/6/2024	3/8/2024	CLARION EVENTS INC	190.00	MICHAEL MALESKI
3/4/2024	3/5/2024	PIONEER PRESS CIRC	14.00	MIKE MARTIN
2/29/2024	3/1/2024	AMERICAN HEART SHOPCPR	168.00	BRAD MCGEE
3/5/2024	3/6/2024	AMERICAN HEART SHOPCPR	168.00	BRAD MCGEE
3/5/2024	3/7/2024	MENARDS 3385	37.32	BRAD MCGEE
2/27/2024	2/29/2024	THE HOME DEPOT 2801	85.41	BRENT MEISSNER
2/27/2024	2/29/2024	KWIK TRIP #415	14.00	MICHAEL MONDOR
2/28/2024	3/1/2024	KWIK TRIP #415	110.67	MICHAEL MONDOR
3/1/2024	3/4/2024	TEMI COTRANSCRIPTION	71.00	MICHAEL MONDOR
3/1/2024	3/4/2024	TEMI COTRANSCRIPTION	9.50	MICHAEL MONDOR
3/4/2024	3/5/2024	BEST BUY MHT 00000109	216.74	MICHAEL MONDOR
3/4/2024	3/5/2024	IN *MARIE RIDGEWAY LICSW,	260.00	MICHAEL MONDOR
3/4/2024	3/5/2024	IN *MARIE RIDGEWAY LICSW,	160.00	MICHAEL MONDOR
3/4/2024	3/5/2024	IN *MARIE RIDGEWAY LICSW,	130.00	MICHAEL MONDOR
3/5/2024	3/7/2024	SHAMROCKS IRISH NOOK	18.28	MICHAEL MONDOR
3/7/2024	3/7/2024	AMZN MKTP US*RN0FL80J2	26.70	MICHAEL MONDOR
3/1/2024	3/4/2024	CALIBRE PRESS	359.00	RACHEL MURRAY
3/6/2024	3/8/2024	MINNESOTA STATE FIRE CHIE	60.00	JERRY NOVAK
3/6/2024	3/8/2024	MN IAAI	275.00	JERRY NOVAK
3/1/2024	3/4/2024	LIFE ASSIST INC	27.20	KENNETH POWERS
2/23/2024	2/26/2024	POMPS TIRE 021	620.00	STEVEN PRIEM
2/24/2024	2/26/2024	AN FORD WHITE BEAR LAK	1,026.25	STEVEN PRIEM
2/29/2024	3/1/2024	FACTORY MOTOR PARTS (19)	35.65	STEVEN PRIEM
2/29/2024	3/1/2024	FACTORY MOTOR PARTS (19)	12.64	STEVEN PRIEM
3/5/2024	3/6/2024	FACTORY MOTOR PARTS (19)	12.00	STEVEN PRIEM
3/5/2024	3/6/2024	FACTORY MOTOR PARTS (19)	14.84	STEVEN PRIEM
3/6/2024	3/8/2024	NUSS TRUCK & EQUIPMENT	877.45	STEVEN PRIEM
3/7/2024	3/8/2024	FACTORY MOTOR PARTS (19)	172.08	STEVEN PRIEM
3/7/2024	3/8/2024	FACTORY MOTOR PARTS (19)	117.28	STEVEN PRIEM
3/4/2024	3/5/2024	AMZN MKTP US*RN00826F0	34.94	MICHAEL RENNER
3/6/2024	3/7/2024	AMZN MKTP US*RN5A84TO2	507.58	MICHAEL RENNER
3/7/2024	3/8/2024	AMZN MKTP US*RN4778XT2	508.08	MICHAEL RENNER
3/8/2024	3/8/2024	AMZN MKTP US*RN06G0MR2	127.72	MICHAEL RENNER
2/29/2024	3/1/2024	CINTAS CORP	86.35	AUDRA ROBBINS
3/4/2024	3/5/2024	MINNESOTA GOVERNMENT FINA	70.00	JOSEPH RUEB
3/4/2024	3/5/2024	MINNESOTA GOVERNMENT FINA	70.00	JOSEPH RUEB
3/4/2024	3/5/2024	MINNESOTA GOVERNMENT FINA	70.00	JOSEPH RUEB
3/4/2024	3/5/2024	MINNESOTA GOVERNMENT FINA	70.00	JOSEPH RUEB
2/26/2024	2/27/2024	IN *ADVANCED GRAPHIX, INC	7,077.50	RYAN SCHROEDER
2/26/2024	2/27/2024	TIDAL WAVE MAPLEWOOD	13.01	RYAN SCHROEDER
2/23/2024	2/26/2024	N-EAR	179.99	STEPHANIE SHEA
2/26/2024	2/27/2024	THOMSON WEST*TCD	700.69	STEPHANIE SHEA
2/29/2024	3/1/2024	CINTAS CORP	109.00	STEPHANIE SHEA

Purchasing Card Items

Transaction Date	Posting Date	Merchant Name	Transaction Amount	Name
2/29/2024	3/4/2024	ODP BUS SOL LLC # 101079	21.66	STEPHANIE SHEA
3/1/2024	3/4/2024	ODP BUS SOL LLC # 101090	460.75	STEPHANIE SHEA
3/1/2024	3/4/2024	MINNESOTA SHERIFFS ASSOC	90.00	STEPHANIE SHEA
3/1/2024	3/4/2024	MINNESOTA SHERIFFS ASSOC	90.00	STEPHANIE SHEA
3/2/2024	3/4/2024	GALLS	586.20	STEPHANIE SHEA
3/7/2024	3/8/2024	WWW.SPSWORKS.COM	54.12	STEPHANIE SHEA
3/7/2024	3/8/2024	CINTAS CORP	109.00	STEPHANIE SHEA
3/8/2024	3/8/2024	MINNESOTA STATE COLLEGES	425.00	ANDREA SINDT
3/8/2024	3/8/2024	MINNESOTA STATE COLLEGES	425.00	ANDREA SINDT
2/28/2024	2/28/2024	AMZN MKTP US*RW9LQ2801	23.32	KAYLA SPANDE
3/1/2024	3/4/2024	CINTAS CORP	246.23	KAYLA SPANDE
3/4/2024	3/5/2024	SALSBURY INDUSTRIES	965.06	KAYLA SPANDE
3/5/2024	3/5/2024	AMAZON.COM*RN7XV8S40	1,593.52	KAYLA SPANDE
3/5/2024	3/6/2024	ALDO ECOMMERCE	272.00	JOSEPH STEINER
3/5/2024	3/6/2024	DEFI TRAINING LLC	600.00	JOSEPH STEINER
3/5/2024	3/6/2024	SP C&G HOLSTERS	90.74	JOSEPH STEINER
3/6/2024	3/6/2024	MACIA	75.00	JOSEPH STEINER
3/2/2024	3/4/2024	SQ *HANDLEITGRIPS	87.99	BRIAN TAUZELL
3/4/2024	3/5/2024	AMZN MKTP US*RZ1PS5V31	123.24	BRIAN TAUZELL
3/7/2024	3/7/2024	AMZN MKTP US*RN8SC50X2	149.67	BRIAN TAUZELL
2/23/2024	2/26/2024	MENARDS 3385	17.28	MATT WOEHRLE
2/26/2024	2/27/2024	FERGUSON ENT #525	136.14	MATT WOEHRLE
2/26/2024	2/28/2024	NUSS TRUCK & EQUIPMENT	9.59	MATT WOEHRLE
2/27/2024	2/29/2024	MENARDS 3385	34.69	MATT WOEHRLE
2/28/2024	3/1/2024	NUSS TRUCK & EQUIPMENT	229.25	MATT WOEHRLE
3/6/2024	3/7/2024	TERMINAL SUPPLY-MINN 7	187.27	MATT WOEHRLE
3/7/2024	3/8/2024	FLEET FARM 2700	39.98	MATT WOEHRLE
2/26/2024	2/27/2024	TRI-STATE BOBCAT	(59.32)	BOON XIONG
3/1/2024	3/4/2024	MENARDS 3385	7.56	BOON XIONG
3/1/2024	3/4/2024	TRI-STATE BOBCAT	39.78	BOON XIONG
3/6/2024	3/8/2024	AN FORD WHITE BEAR LAK	161.92	BOON XIONG
3/7/2024	3/8/2024	WALSER POLAR CHEVROLET	376.65	BOON XIONG
3/7/2024	3/8/2024	LIFE ASSIST INC	781.85	ERIC ZAPPA
			<u>\$ 44,420.94</u>	

CITY COUNCIL STAFF REPORT
Meeting Date March 25, 2024

REPORT TO: Michael Sable, City Manager

REPORT FROM: Steven Love, Public Works Director / City Engineer
Audra Robbins, Parks and Natural Resources Manager

PRESENTER: Steven Love

AGENDA ITEM: Resolution Directing Modification of Existing Construction Contract, Change Order No. 1, Change Order No. 2, and Construction Contract Directive for Goodrich Park Improvements

Action Requested: Motion Discussion Public Hearing

Form of Action: Resolution Ordinance Contract/Agreement Proclamation

Policy Issue:

The City Council will consider approving two change orders to the contract with Sunram Construction, Inc. as well as a Construction Contract Directive (CCD) for the Goodrich Park Improvements Project.

Recommended Action:

Motion to approve resolution Directing Modification of Existing Construction Contract, Change Order No.1 & No. 2, and CCD No.1 for Goodrich Park Improvements, and authorize the City Manager to sign Change Order No. 1, No. 2 and CCD No.1.

Fiscal Impact:

Is There a Fiscal Impact? No Yes, the true or estimated cost is \$58,511.00

Financing source(s): Adopted Budget Budget Modification New Revenue Source
 Use of Reserves Other: Approval of Change Order No.1 (\$1,511.00) and CCD No.1 (not to exceed \$57,000.00) will increase the project construction contract by up to \$58,511.00 from \$406,875.00 to \$465,386.00. Change Order No. 2 does not affect the construction contract. The revised contract, including indirect costs, falls within the approved budget of \$523,803.50. No adjustment to the approved budget is required at this time.

Strategic Plan Relevance:

Financial Sustainability Integrated Communication Targeted Redevelopment
 Operational Effectiveness Community Inclusiveness Infrastructure & Asset Mgmt.

The updates to Goodrich Park touch on several of the City Council's strategic initiatives by evaluating what we have, planning for the future, and improving accessibility to our facilities for the community.

Background

The City Council previously awarded a construction contract to Sunram Construction Inc. for the Goodrich Park Improvements, in the amount of \$406,875.00. The project improvements included the addition of a parking lot, lighting, drinking fountain and an accessible picnic shelter adjacent to the existing playground.

During construction, it was discovered that changes needed to be made to the manhole location for sewer maintenance, as well as changes to the set up of the water connection as directed by Saint Paul Regional Water.

Change Order No.1 proposes to increase the construction contract by \$1,511.00 to cover costs associated with the following:

- Modification of sanitary sewer manhole location
- Revised grading and turf replacement modifications

Change Order No. 2 proposes a new project completion date of on or before June 28, 2024.

CCD No.1 proposes to increase the contract by up to \$57,000.00 to cover the costs associated with the following:

- Added water service enclosure per Saint Paul Regional Water Requirements.

Attachments

1. Change Order No. 1
2. Change Order No. 2
3. CCD No. 1
4. Resolution Directing Modification of Existing Construction Contract, Change Order No. 1, No. 2, and CCD No. 1



CHANGE ORDER

Date:	June 1, 2023	Change Order No.	01
Project:	Goodrich Park	LHB Project No.	200290
Owner:	City of Maplewood	Architect:	LHB, Inc.
Contractor:	Sunram Construction, Inc.	Contract for:	General Construction

This change order contains changes in the Contract Sum and/or Time in response to proposed modification to the Contract Documents. This document is not valid unless signed by all parties.

Description of Change

1. PR 01	ADD	\$1,511.00
Original Contract Sum		\$406,875.00
Net Change by previous Change Orders		\$0.00
Contract Sum prior to this Change Order		\$406,875.00
Amount of change by this Change Order		\$1,511.00
New Contract Sum		\$408,386.00

Contract time will change by Zero (0) days.

Substantial Completion, to date, is unchanged.

By signing this Change Order, Contractor agrees that all cost and time implications of this change are addressed hereon and waives any future claims for cost or time related to this change.

Architect:

LHB, Inc.
701 Washington Avenue North,
Suite 200
Minneapolis, Minnesota 55401

Contractor:

Sunram Construction, Inc.
20010 75th Avenue North
Corcoran, Minnesota 55340

Owner:

City of Maplewood
1830 County Road B E
Maplewood, Minnesota 55109

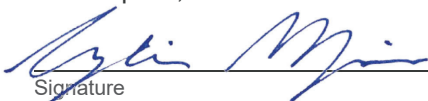
Signature

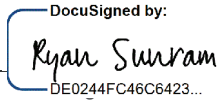
DocuSigned by:

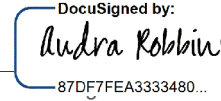
Ryan Sunram
DE0244FC46C6423...

DocuSigned by:

Audra Robbins
87DF7FEA3333480...

Lydia Major, Project Manager

Name, Title

Ryan Sunram

Name, Title

President

Audra Robbins

Name, Title

Parks Manager

June 1, 2023

Date

6/1/2023

Date

6/1/2023

Date

Attachments: PR 01 dated March 30, 2023

c: LHB File No. 200290

m:\20proj\200290\400 construction\change orders\co1\200290 change order 01.docx



701 Washington Ave, N, Ste 200 | Minneapolis, MN 55401 | 612.338.2020

CLIENT:
**CITY OF
 MAPLEWOOD**
 2659 EAST 7TH STREET
 MAPLEWOOD, MN 55119

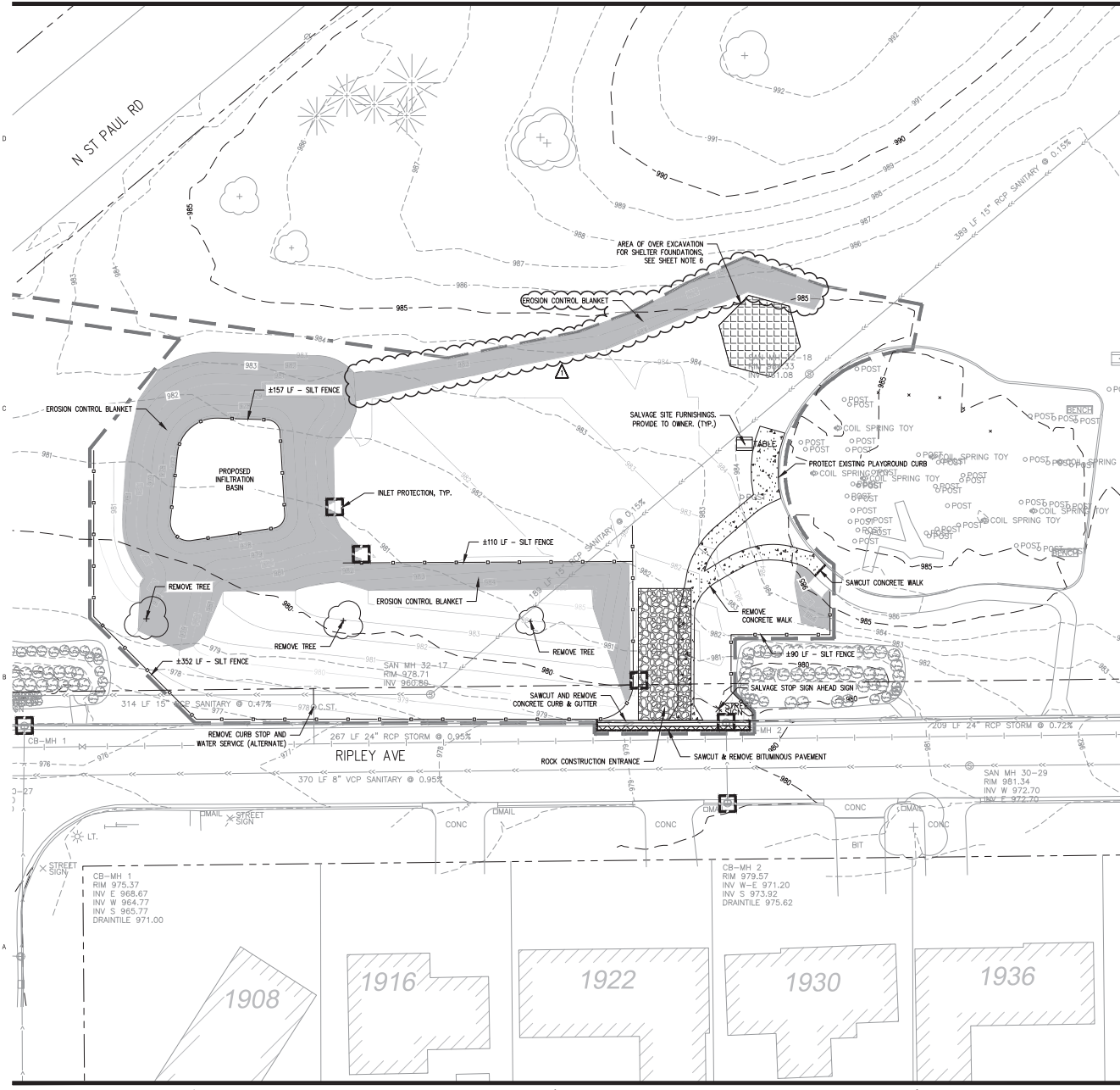

LEGEND

- CONSTRUCTION LIMITS
- SILT FENCE, SEE DETAIL 3/C501
- █ ROCK CONSTRUCTION ENTRANCE, SEE DETAIL 1/C501
- INLET PROTECTION, SEE DETAIL 4/C501
- ▨ EROSION CONTROL BLANKET, SEE DETAIL 2/C501
- ▩ REMOVE BITUMINOUS PAVEMENT
- ▧ REMOVE CONCRETE
- ▦ SAWCUT (FULL DEPTH)
- ▤ AREA OF OVER EXCAVATION FOR SHELTER FOUNDATIONS

SHEET NOTES

1. THE CONTRACTOR IS RESPONSIBLE FOR EROSION CONTROL ON THIS PROJECT. THE EROSION CONTROL DEVICES SHOWN IN THESE DRAWINGS ARE THE MINIMUM REQUIREMENTS. CONSTRUCT EROSION CONTROL DEVICES AS SHOWN AND AS NECESSARY TO PREVENT RUNOFF, TRACKING, OR LOSS OF SOIL MATERIALS FROM DISTURBED AREAS ON THE PROJECT SITE. ADDITIONAL PRACTICES MAY BE REQUIRED DURING THE COURSE OF CONSTRUCTION.
2. SEDIMENT AND EROSION CONTROL DEVICES SHALL BE FUNCTIONAL BEFORE ANY LAND IS OTHERWISE DISTURBED ON THE SITE.
3. REMOVE ALL TOPSOIL AND ORGANICS, BRUSH, SHRUBS, AND TREES WITHIN THE CONSTRUCTION LIMITS PRIOR TO SUBGRADE PREPARATIONS UNLESS OTHERWISE NOTED IN THE DRAWINGS. TOPSOIL THICKNESS VARIES.
4. INFILTRATION BASIN MUST BE KEPT OFFLINE AND PROTECTED FROM CONSTRUCTION ACTIVITY UNTIL ALL CONTRIBUTING AREAS ARE PERMANENTLY RESTORED.
5. REFER TO THE TOPOGRAPHIC SURVEY FOR SHEETS FOR DATUM INFORMATION.
6. AREA OF OVER EXCAVATION IS TO BE EXCAVATED TO AT LEAST ONE FOOT VERTICALLY AND HORIZONTALLY BEYOND THE PLANNED BOTTOM-OF-FOOTING ELEVATION AND PLACE A COMPACTED GRANULAR FILL LAYER.

THIS SQUARE APPEARS 1/2" x 1/2" ON FULL SIZE SHEETS	
02	01/24/2023 BID
01	12/02/2022 100% CD SET
NO	DATE ISSUED FOR
1	03/28/2023 PR 01
NO	DATE REVISION

I HEREBY CERTIFY that this plan, specification or report was prepared by me or under my direct supervision and that I am a duly Licensed Professional Engineer under the laws of the State of Minnesota.

SIGNATURE: *Adam Besse*
 TYPED OR PRINTED NAME: ADAM BESSE
 DATE: 01/24/2023 REG. NO.: 52597

COPYRIGHT 2023 BY LHB, INC. ALL RIGHTS RESERVED.
 PROJECT NAME:
GOODRICH PARK

1930 NORTH ST PAUL ROAD
 MAPLEWOOD, MN 55109

DRAWING TITLE:
**REMOVAL & EROSION
 CONTROL PLAN**

DRAWN BY: MJJ
 CHECKED BY: APB
 PROJ. NO: 20230
 DRAWING NO:

WARNING
 LOCATION OF ALL UNDERGROUND UTILITIES SHALL BE VERIFIED BY THE CONTRACTOR. CALL BEFORE DIGGING.
 MINNESOTA ONE-CALL SYSTEM
 1-800-252-1166
 REQUIRED BY MN STATUTE 216D



C101

DocuSign Envelope ID: 84AC2084-0872-4523-8350-6810698DFD48

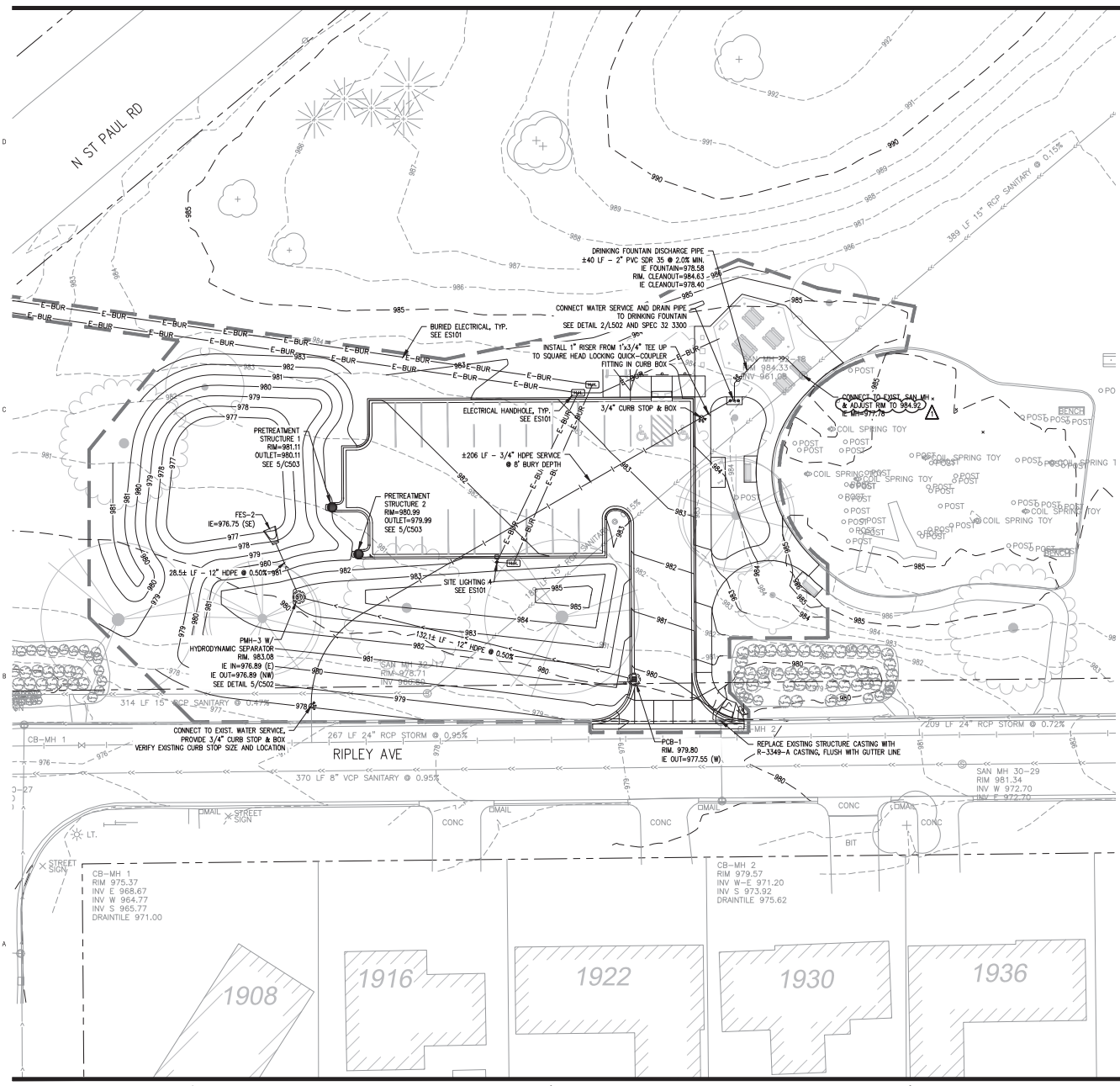

LEGEND

- CONSTRUCTION LIMITS
- STORM SEWER
- CATCH BASIN
- RAIN GUARDIAN PRETREATMENT STRUCTURE
- MANHOLE
- FLARED END
- WATER SERVICE
- CURB STOP
- SANITARY SEWER
- CLEANOUT, SEE DETAIL 6/C501

SHEET NOTES

1. EXISTING UTILITIES ARE BASED ON RECORD DRAWINGS AND HAVE NOT BEEN INDEPENDENTLY VERIFIED BY THE OWNER OR ENGINEER. THE CONTRACTOR SHALL FIELD VERIFY ALL EXISTING UTILITIES PRIOR TO BEGINNING CONSTRUCTION. UTILIZE THE "OPENER STATE ONE CALL SYSTEM" (1-800-252-1166) TO HAVE PUBLIC UTILITIES LOCATED WITHIN THE CONSTRUCTION LIMITS. CONTACT THE OWNER TO LOCATE PRIVATE UTILITIES LOCATED WITHIN THE CONSTRUCTION LIMITS. NOTIFY THE ENGINEER IMMEDIATELY OF ANY CONFLICTS.
2. UNLESS OTHERWISE NOTED, ALL UTILITY TRENCHES SHALL BE CONSTRUCTED PER 1/C503.
3. ADJUST ALL RISERS AND CASTINGS TO FINISH GRADE.
4. NOT ALL PIPE FITTINGS ARE SHOWN IN THE DRAWINGS. PROVIDE ALL NECESSARY PIPE FITTINGS TO COMPLETE THE WORK. ALL FITTINGS SHALL CONFORM TO CITY DETAILS AND SPECIFICATIONS.
5. PREVENT CONSTRUCTION SEDIMENT, DIRT AND DEBRIS FROM ENTERING ALL INFILTRATION BAPS.
6. PROVIDE TRACER WIRE FOR ALL WATER SERVICE AND SANITARY PIPING. BRING TO SURFACE, AND PROVIDE TRACER BOX IN ACCORDANCE WITH DETAIL 2/C503 AND AS INDICATED IN THE SPECIFICATIONS.
7. CONTRACTOR TO PROVIDE AS-BUILT SURVEY OF ALL STORMWATER BEST MANAGEMENT PRACTICES (INFILTRATION BASIN), REFER TO SPEC. SECTION 01.7800.



701 Washington Ave, N, Ste 210 | Minneapolis, MN 55401 | 612.338.2020

CLIENT:
**CITY OF
 MAPLEWOOD**
 2659 EAST 7TH STREET
 MAPLEWOOD, MN 55119

THIS SQUARE APPEARS 12" x 12" ON FULL SIZE SHEETS		
02	01/24/2023	BID
01	12/02/2022	100% CD SET
NO	DATE	ISSUED FOR
1	03/28/2023	PR 01
NO	DATE	REVISION

I HEREBY CERTIFY that this plan, specification or report was prepared by me or under my direct supervision and that I am a duly Licensed Professional Engineer under the laws of the State of Minnesota.

SIGNATURE: *Adam Besse*
 TYPED OR PRINTED NAME: ADAM BESSE
 DATE: 01/24/2023 REG. NO.: 52597

COPYRIGHT 2023 BY LHB, INC. ALL RIGHTS RESERVED.
 PROJECT NAME:
GOODRICH PARK

1930 NORTH ST PAUL ROAD
 MAPLEWOOD, MN 55109

DRAWING TITLE:
UTILITY PLAN

DRAWN BY: MJJ
 CHECKED BY: APB
 PROJ. NO: 20230
 DRAWING NO:

WARNING
 LOCATION OF ALL UNDERGROUND UTILITIES SHALL BE VERIFIED BY THE CONTRACTOR. CALL BEFORE DIGGING.
 MINNESOTA ONE-CALL SYSTEM
 1-800-252-1166
 REQUIRED BY MN STATUTE 216D



C201



701 Washington Ave, N, Ste 210 | Minneapolis, MN 55401 | 612.338.2020

CLIENT:
**CITY OF
 MAPLEWOOD**
 2659 EAST 7TH STREET
 MAPLEWOOD, MN 55119

THIS SQUARE APPEARS 1/2" x 1/2"
 ON FULL SIZE SHEETS

02	01/24/2023	BID
01	12/02/2022	100% CD SET
NO	DATE	ISSUED FOR

1	03/20/2023	PR 01
NO	DATE	REVISION

I HEREBY CERTIFY that this plan, specification or report was prepared by me or under my direct supervision and that I am a duly Licensed Professional Engineer under the laws of the State of Minnesota.

SIGNATURE: *[Signature]*
 TYPED OR PRINTED NAME: ADAM BESSE

DATE: 01/24/2023 REG. NO.: 52997

COPYRIGHT 2023 BY LHB, INC. ALL RIGHTS RESERVED.

PROJECT NAME:
GOODRICH PARK

1930 NORTH ST PAUL ROAD
 MAPLEWOOD, MN 55109

DRAWING TITLE:
GRADING PLAN

DRAWN BY: MJJ
 CHECKED BY: APB
 PROJ. NO: 20230
 DRAWING NO:

C301

G2, Attachment 1

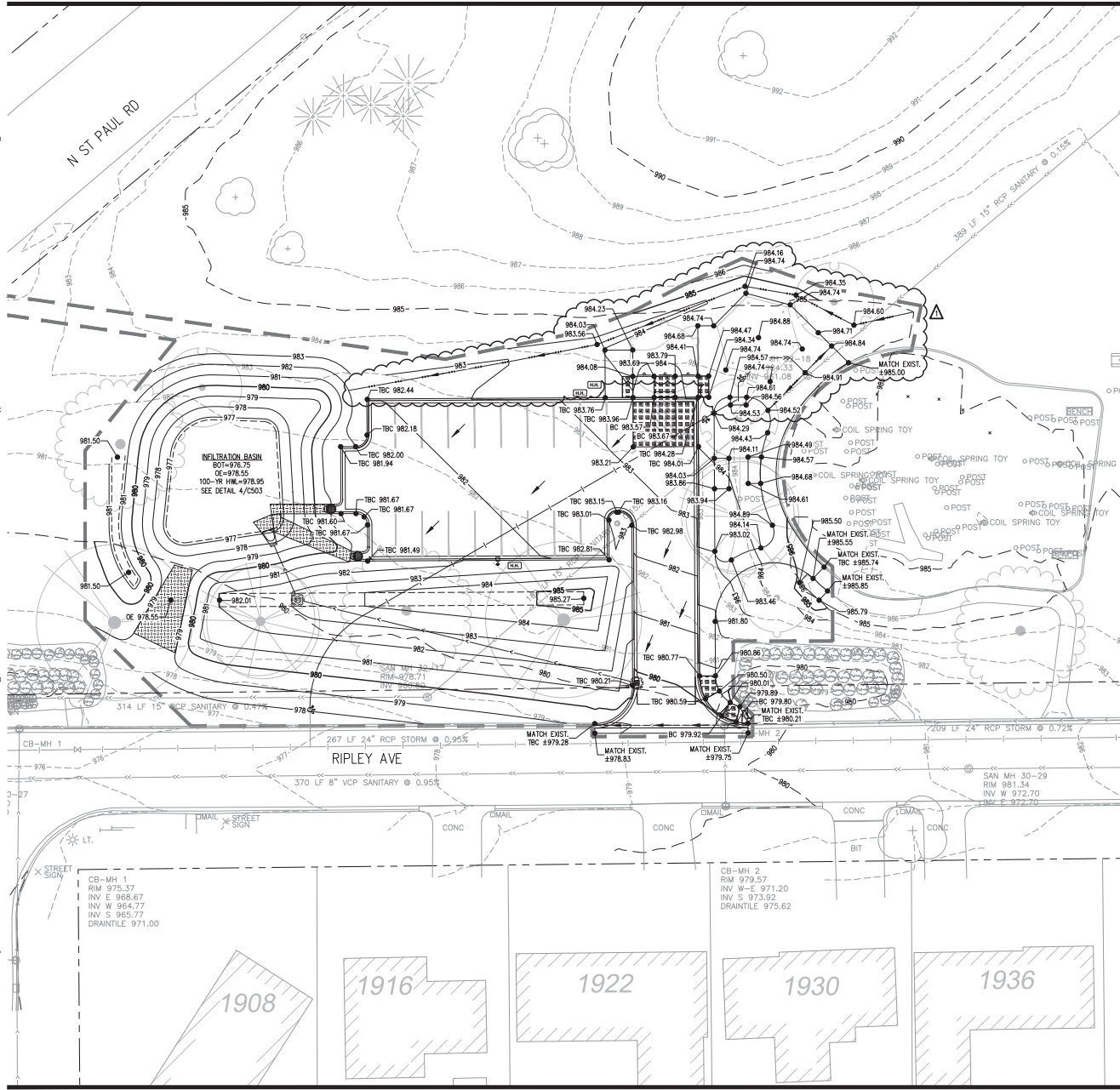

LEGEND

- CONSTRUCTION LIMITS
- - - - - EXISTING MINOR CONTOUR (1' INTERVAL)
- 980 --- EXISTING MAJOR CONTOUR (5' INTERVAL)
- 981 --- MINOR CONTOUR (1' INTERVAL)
- 980 --- MAJOR CONTOUR (5' INTERVAL)
- 982.50 SPOT ELEVATION
- GRADE BREAK
- ADACRITICAL AREA (2% MAX. SLOPE IN ANY DIRECTION)
- SWALE
- DRAINAGE ARROW

SHEET NOTES

1. GRADES SHOWN ARE FINISH SURFACE ELEVATIONS UNLESS OTHERWISE NOTED. THE CONTRACTOR SHALL MAKE APPROPRIATE DEDUCTIONS FOR VARYING SURFACES TO DETERMINE SUBGRADE ELEVATIONS.
2. SPOT ELEVATIONS ALONG CURB LINES REPRESENT THE TOP BACK OF CURB UNLESS OTHERWISE NOTED.
3. ALL EXISTING AND PROPOSED STRUCTURE ACCESS COVERS SHALL BE ADJUSTED TO FINISHED GRADE BY THE CONTRACTOR.
4. CONTRACTOR SHALL STOP WORK IMMEDIATELY IN THE AFFECTED AREA AND NOTIFY THE OWNER IF CONTAMINANTS ARE FOUND IN THE EXISTING SOILS.
5. SIDEWALK CROSS-SLOPES SHALL NOT EXCEED 2.0%. CROSS-SLOPES OF AT LEAST 1.5% IN THE GENERAL DIRECTION OF THE OVERALL SITE SLOPE WILL BE ACHIEVED IN AREAS WHERE LONGITUDINAL SLOPES ARE LESS THAN 1.5%.
6. IN AREAS WHERE NEW FILL IS TO BE PLACED ON SLOPING GROUND, BENCHING THE SURFACE SHALL BE COMPLETED PRIOR TO PLACING THE FILL. BENCHING SHALL BE COMPLETED WHERE SLOPES ARE STEEPER THAN 4:1 (HORIZONTAL:VERTICAL).
7. SEE SHEETS C101 FOR THE SEDIMENTATION AND EROSION CONTROL PLANS.
8. PROVIDE POSITIVE DRAINAGE AT ALL TIMES WITHIN THE CONSTRUCTION AREA. DO NOT ALLOW WATER TO POND IN EXCAVATION AREAS, AND MAINTAIN ALL EXISTING DRAINAGE PATTERNS.
9. REFER TO LANDSCAPE PLANS FOR AREAS TO RECEIVE PERMANENT SEED, SOO, TREES, AND SHRUBS, ETC.
10. THE CONTRACTOR SHALL ADJUST TO GRADE ALL MANHOLE STRUCTURES AND APPURTENANCES THAT FALL WITHIN THE LIMITS OF THIS CONTRACT. THE CONTRACTOR SHALL KEEP ALL SAID EXISTING UTILITIES AND THEIR APPURTENANCES FREE OF DEBRIS AND OPERABLE AT ALL TIMES DURING CONSTRUCTION.
11. ALL GRADES WITHIN THE LANDSCAPED AREAS SHALL NOT EXCEED 3 HORIZONTAL TO 1 VERTICAL AND HAVE A MINIMUM GRADE OF 4% UNLESS OTHERWISE NOTED. GRADED SWALES MUST HAVE A MINIMUM BOTTOM SLOPE OF 0.5%.
12. DURING SITE GRADING THE BASIN SHALL BE FINISHED TO FINAL GRADE USING EQUIPMENT THAT MINIMIZES SOIL COMPACTION AT THE BOTTOM OF THE BASIN. AFTER GRADING, THE BASIN WILL BE PROTECTED FROM SOIL EROSION THROUGHOUT THE REMAINDER OF THE DEVELOPMENT PROCESS.
13. ALL DISTURBED AREAS SHALL BE FINISHED WITH 4 INCHES OF TOP SOIL UNLESS INDICATED OTHERWISE. REFER TO LANDSCAPE FOR SEEDING.
14. CONTRACTOR IS RESPONSIBLE FOR MAINTAINING AND STABILIZING CONSTRUCTION ACCESS AS NECESSARY.

ABBREVIATIONS

- TC TOP OF CURB
- BC BACK OF FLUSH CURB
- BT BOTTOM OF BASIN
- GL GUTTER LINE
- HP HIGH POINT
- LP LOW POINT
- OE OVERFLOW ELEVATION
- HWL HIGH WATER LEVEL
- HP HIGH POINT
- TYP. TYPICAL
- MATCH EXIST. MATCH EXISTING GRADE (FIELD VERIFY)
- O.C. ON CENTER
- O.C.E.W. ON CENTER EACH WAY

WARNING
 LOCATION OF ALL UNDERGROUND UTILITIES SHALL BE VERIFIED BY THE CONTRACTOR. CALL BEFORE DIGGING.
 MINNESOTA ONE-CALL SYSTEM
 1-800-252-1166
 REQUIRED BY MN STATUTE 216D



DocuSign Envelope ID: 84AC9084-6872-4523-8350-81850680F048

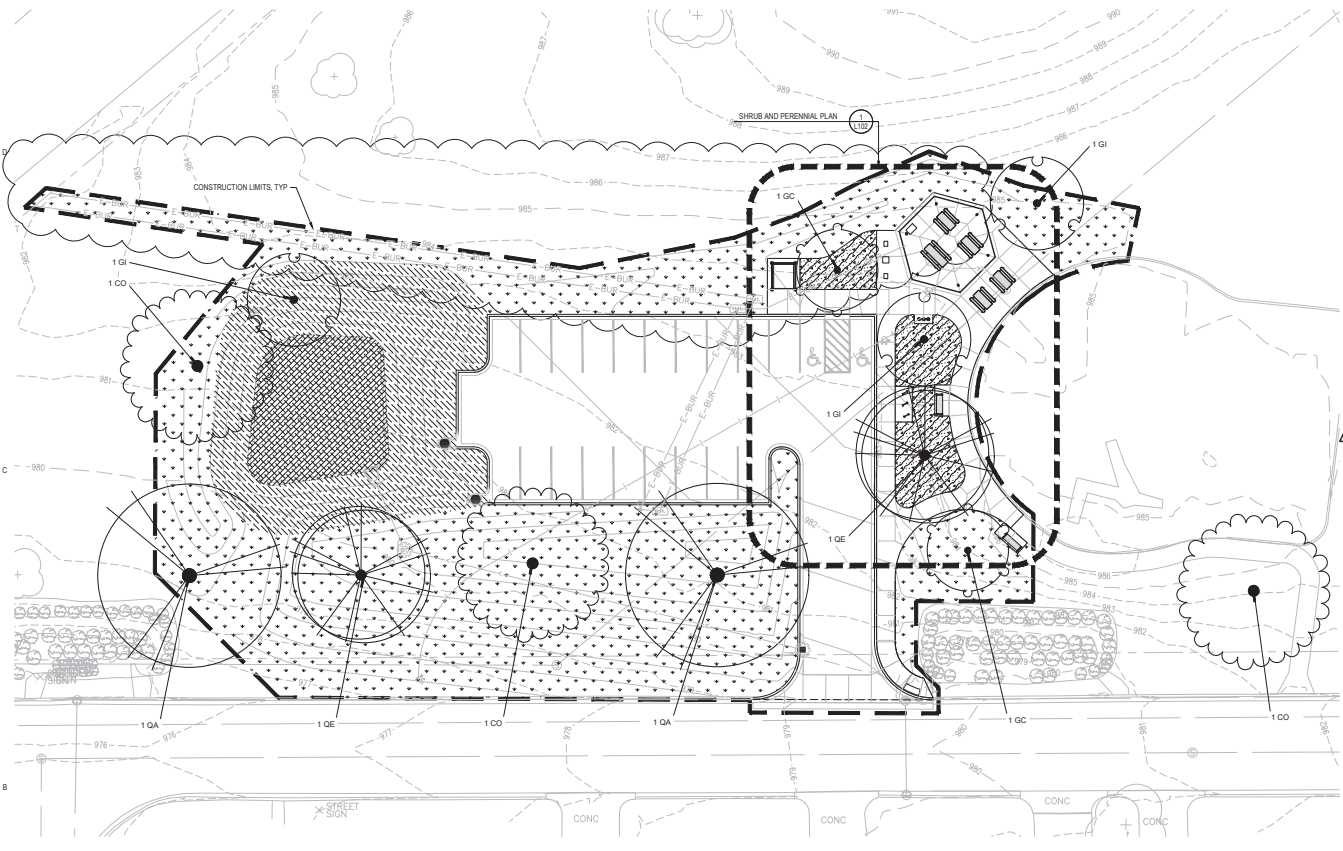

PLANT SCHEDULE

TREES	CODE	QTY	BOTANICAL / COMMON NAME	CONT
	CO	3	<i>Celtis occidentalis</i> Common Hackberry	2-1/2' B&B
	GI	3	<i>Gleditsia tricanthos</i> 'inermis' 'Skycol' TM Skyline Honey Locust	2-1/2' B&B
	GC	2	<i>Gymnotadus dioicus</i> 'UMNSynergy' TM Kentucky Tree North	2-1/2' B&B
	OA	2	<i>Quercus alba</i> White Oak	2-1/2' B&B
	OE	2	<i>Quercus ellipsoidalis</i> Northern Pin Oak	2-1/2' B&B
GROUND COVERS	CODE	QTY	BOTANICAL / COMMON NAME	CONT
	DB	1,906 sf	Deterioration Basin Native Seed Mix	Seed Mix
	SP	4,805 sf	Dry Short Prairie Seed Mix	Seed Mix
	TH	19,117 sf	Turf Seed	Seed Mix
MULCH	CODE	QTY	BOTANICAL / COMMON NAME	CONT
	HM	1,352 sf	Hardwood Mulch See Shrub & Perennial Plan for Plantings	Mulch



701 Washington Ave. N. Ste 201 | Minneapolis, MN 55401 | 612.338.2020

CLIENT:
CITY OF MAPLEWOOD
2659 EAST 7TH STREET
MAPLEWOOD, MN 55119

THIS SQUARE APPEARS 1/2" x 1/2" ON FULL SIZE SHEETS

02	01/24/2023	BID
01	12/02/2022	100% CD SET
NO	DATE	ISSUED FOR

01	03/29/2023	PR 01
NO	DATE	REVISION

I HEREBY CERTIFY that this plan, specification or report was prepared by me or under my direct supervision and that I am a duly Licensed Landscape Architect under the laws of the State of Minnesota.

SIGNATURE: *Lydia A. Major*
TYPED OR PRINTED NAME: LYDIA A. MAJOR
DATE: 01/24/2023 REG. NO.: 46911

COPYRIGHT 2023 BY LHB, INC. ALL RIGHTS RESERVED.

PROJECT NAME:
GODDRICH PARK

1930 NORTH ST PAUL ROAD
MAPLEWOOD, MN 55109

DRAWING TITLE:
LANDSCAPE PLAN & NOTES

DRAWN BY: JHV
CHECKED BY: LAM
PROJ. NO.: 30356
DRAWING NO.:

1 OVERALL LANDSCAPE PLAN
Scale: 1"=20'

LANDSCAPE NOTES

- GENERAL LANDSCAPE NOTES:**
- THIS DRAWING DOES NOT CONSTITUTE AN OFFICIAL SURVEY OF THE SITE. CONFIRM ALL LOCATIONS OF SURFACE AND SUB-SURFACE FEATURES BEFORE BEGINNING INSTALLATION. ADVISE LANDSCAPE ARCHITECT OF ANY DISCREPANCIES.
 - CONFIRM ALL QUANTITIES, SHAPES AND LOCATIONS OF BEDS, AND ADJUST AS REQUIRED TO CONFORM TO THE SITE CONDITIONS. CONFIRM ANY ADJUSTMENTS WITH THE LANDSCAPE ARCHITECT.
 - LOCATE ALL UTILITIES. NOTIFY THE LANDSCAPE ARCHITECT OF ANY CONFLICTS WITH PLANT INSTALLATION.
 - THE CONTRACTOR SHALL BE RESPONSIBLE FOR ALL MULCHES AND PLANTING SOIL. QUANTITIES TO COMPLETE THE WORK SHOWN ON THE PLAN. VERIFY ALL QUANTITIES SHOWN ON THE PLANT SCHEDULE.
 - THE CONTRACTOR SHALL REMOVE FROM THE SITE ALL SOOT/URF WHICH HAS BEEN REMOVED FOR NEW PLANT BEDS. LONG TERM STORAGE OF MATERIALS OR SUPPLIES ON SITE WILL NOT BE ALLOWED. ANY PLANT STOCK NOT PLANTED ON DAY OF DELIVERY SHALL BE KEPT IN AND WATERED UNTIL INSTALLATION. PLANTS NOT MAINTAINED IN THIS MANNER WILL BE REJECTED.
 - THE PLAN TAKES PRECEDENCE OVER THE PLANT SCHEDULE IF DISCREPANCIES EXIST. ADVISE LANDSCAPE ARCHITECT OF ANY DISCREPANCIES.
- PROTECTIONS**
- THE CONTRACTOR SHALL AVOID DAMAGING EXISTING TREES. DO NOT STORE OR DRIVE HEAVY MATERIALS OVER TREE ROOTS. DO NOT DAMAGE TREE BARK OR BRANCHES.
 - THE CONTRACTOR SHALL KEEP PAVEMENTS, FIXTURES AND BUILDINGS CLEAN AND UNSTAINED. ANY DAMAGE TO EXISTING FACILITIES SHALL BE REPAIRED AT THE CONTRACTOR'S EXPENSE. THE PROTECTIVE SITE SHALL BE KEPT CLEAR OF CONSTRUCTION WASTES AND DEBRIS.
 - PROVIDE SILT FENCE IF NECESSARY TO PROTECT STREET FROM EROSION.
 - TURF SEED ALL AREAS DISTURBED BY CONSTRUCTION. REFER TO SPECIFICATIONS.

- PLANT MATERIAL**
- NO SUBSTITUTIONS OF PLANT MATERIAL SHALL BE ACCEPTED UNLESS APPROVED IN WRITING BY THE LANDSCAPE ARCHITECT. THE LANDSCAPE ARCHITECT RESERVES THE RIGHT TO REJECT ANY PLANTS WHICH ARE DEEMED UNSATISFACTORY.
 - ALL PLANTING STOCK SHALL CONFORM TO THE "AMERICAN STANDARD" FOR NURSERY STOCK", ANSI-Z60, LATEST EDITION, OF THE AMERICAN ASSOCIATION OF NURSERYMEN, INC.
 - ALL PLANTS SHALL BE GUARANTEED FOR ONE YEAR FROM DATE OF SUBSTANTIAL COMPLETION, UNLESS OTHERWISE SPECIFIED. THE GUARANTEE SHALL COVER THE FULL COST OF REPLACEMENT INCLUDING LABOR AND PLANTS.
- OTHER MATERIAL**
- PROVIDE SHREDDED HARDWOOD MULCH, CLEAN AND FREE OF NOXIOUS WEEDS OR OTHER DELETERIOUS MATERIAL. DELIVER MULCH ON DAY OF INSTALLATION. USE 2" DEPTH FOR PERENNIAL/GROUND COVER BEDS, UNLESS OTHERWISE DIRECTED. APPLY PELLET WEED PREVENTER UNDER MULCH BEDS IN SHRUB AREAS.
- SOILS AND GROUND**
- SOIL CORRECTION FOR TREES, SHRUBS AND TURF: DISC SOIL TO A FULL 9" DEPTH IN ALL AREAS TO BE PLANTED TO LOOSEN COMPACTED SOILS. IDENTIFY AND PROTECT ROOTS OF EXISTING TREES.
 - CONFIRM THAT SOILS CONFORM TO SPECIFICATION SECTION 31 2323 FOR TYPE AND SECTION 32 2019 FOR EXECUTION PRIOR TO PLANTING. CONTACT LANDSCAPE ARCHITECT IF SOILS ARE INSUFFICIENT.

- MAINTENANCE AND CARE**
- MAINTENANCE SHALL BE PROVIDED IMMEDIATELY AFTER EACH PORTION OF THE WORK IS IN PLACE.
 - MAINTENANCE SHALL INCLUDE WATERING, WEEDING, MULCHING, REMOVAL OF DEAD MATERIAL PRIOR TO GROWING SEASON, RE-SETTING PLANTS AND PROPER GRADE, AND KEEPING PLANTS IN A PLUMB POSITION.
 - WATERING MAINTAIN A WATERING SCHEDULE WHICH WILL THOROUGHLY WATER ALL PLANTS ONCE A WEEK. IN EXTREMELY HOT DRY WEATHER, WATER MORE OFTEN AS REQUIRED BY INDICATIONS OF HEAT STRESS SUCH AS WILTING LEAVES. CHECK MOISTURE UNDER MULCH PRIOR TO WATERING TO DETERMINE NEED. CONTRACTOR SHALL MAKE THE NECESSARY ARRANGEMENTS FOR WATER.
 - REFER TO SPECIFICATIONS FOR FULL INSPECTION, MAINTENANCE, AND WARRANTY REQUIREMENTS.

WARNING

LOCATION OF ALL UNDERGROUND UTILITIES SHALL BE VERIFIED BY THE CONTRACTOR.
CALL BEFORE DIGGING.

MINNESOTA
ONE-CALL SYSTEM
1-800-252-1166
REQUIRED BY
MN STATUTE 216D

File Path: S:\2023\30356\30356.dwg Plot Date: 03/29/2023 4:29 PM



CHANGE ORDER

Date: January 5, 2024 Change Order No. 02
 Project: Goodrich Park LHB Project No. 200290
 Owner: City of Maplewood Architect: LHB, Inc.
 Contractor: Sunram Construction, Inc. Contract for: General Construction

This change order contains changes in the Contract Sum and/or Time in response to proposed modification to the Contract Documents. This document is not valid unless signed by all parties.

Description of Change

1. Change in date of Substantial Completion.

Original Contract Sum	\$406,875.00
Net Change by previous Change Orders	\$1,511.00
Contract Sum prior to this Change Order	\$408,386.00
Amount of change by this Change Order	\$0
New Contract Sum	\$408,386.00

Substantial Completion, to date, is now **June 28, 2024.**

By signing this Change Order, Contractor agrees that all cost and time implications of this change are addressed hereon and waives any future claims for cost or time related to this change.

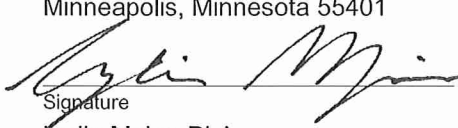
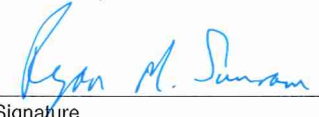
Architect:	Contractor:	Owner:
LHB, Inc. 701 Washington Avenue North, Suite 200 Minneapolis, Minnesota 55401	Sunram Construction, Inc. 20010 75th Avenue North Corcoran, Minnesota 55340	City of Maplewood 1830 County Road B E Maplewood, Minnesota 55109
 _____ Signature	 _____ Signature	_____ Signature
Lydia Major, PLA Project Manager _____ Name, Title	Ryan M. Sunram President _____ Name, Title	_____ Name, Title
January 5, 2024 _____ Date	3/15/24 _____ Date	_____ Date

Attachments: None

c: LHB File No. 200290

M:\20Proj\200290\400 Construction\Change Orders\CO2\200290 Change Order 02.docx



PROPOSAL REQUEST

Date: March 13, 2024 PR No. 02
Project: Goodrich Park LHB Project No. 200290
Owner: City of Maplewood Architect: LHB, Inc.
Contractor: Sunram Construction, Inc. Contract for: General Construction

Please submit an itemized cost for changes in the Contract Sum and Contract Time for proposed modifications to Contract Documents. Submit your cost within five days or notify Architect of the date you anticipate submitting your proposal.

This is not a change order or a direction to proceed with the work described in the proposed modifications.

Reason: Owner Request Unforeseen Condition Code Other

- 1. Replace Sheet C201 in its entirety with the attached revised sheet.
 - a. Added water service enclosure per Saint Paul Regional Water requirements.
- 2. Add Sheet C504 in its entirety.
 - a. Added detail 1 for water service enclosure.

Contractor Pricing

Labor	\$ 29,075
Materials	\$ 21,150
OH&P	\$ 6,775
TOTAL ADD / DEDUCT	\$ 57,000

(Circle one)

Does Proposed Change involve a change in Contract Time? No Yes (Increased)(Decreased) _____ days.
Material lead time is 8-12 weeks. Once materials are in hand, this will take about 2 weeks to complete.

Attachments: C201, C504, SPRW Punchlist
Request By: LHB, Inc.

c: LHB File No. 200290
m:\20proj\200290\400 construction\proposal requests\pr 02\2023\200290 20240313 proposal request 02.docx

Saint Paul Regional Water Services
Goodrich Park
Plans dated: 01/24/2023

Reviewer:
Brent Marsolek | 651-266-6810 | brent.marsolek@ci.stpaul.mn.us

LHB Responses to be noted in RED below.

Requirements:

- a. Plumbing permit applications to be made with SPRWS at 1900 Rice Street, Saint Paul, MN. The Contractor will submit Plumbing Permit Application.
- b. Before scheduling future inspections, SPRWS must receive a Water Service Contract(s) signed by the property owner. Contact Engineering at 651-266-6270 to coordinate contracts. City Staff will contact SPRWS to negotiate and sign a water service contract.
- c. All water piping material before water meter must be Type K copper. Material between the water meter and curb stop to be Type K copper as shown in Detail 1 of C504.
- d. All water piping material between water meter and approved backflow preventer must be listed as approved in the State Plumbing Code. All material between water meter and backflow preventor to be approved materials, see detail 1 of C504.
- e. Water service valve must be exposed to verify that the valve is wasting, if found to be non-wasting the valve will need to be replaced. The Contractor will expose curb stop to confirm it is wasting.
- f. All water service valve boxes within construction area must be exposed and brought to grade upon completion of construction. See Water Service Enclosure detail 1 on C504 and utility plan for note to adjust risers and casting to finish grade.
- g. All pipe work inside of property to be performed by a plumber licensed by the State of Minnesota and Certified by the City of Saint Paul. SPRWS requires separate outside and inside plumbing permits for each new water service. The Contractor will provide a licensed plumber to install water service piping.
- h. Water line needs to be brought up 18" above grade near the intersection with property line. Meter setting required at this point within an approved lockable enclosure. Please refer to detail A1-7178 provided. See detail 1 on C504 for water service information above grade.

PROPOSAL (Rev-1 Updated Pricing)



2415 Ventura Drive, Suite #100 ♦Woodbury, MN ♦55125 ♦Phone (651) 773-9000 ♦Fax (651) 773-9010

Company Name Sunram Construction, Inc.	Phone / Fax	Date 2/26/2024
Street Address	Project Name Maplewood - Goodrich Park – PR 02	
City, State, Zip	Project Location	
Attention: Ryan Sunram	Project Description Adding water service enclosure	

Division 22 Plumbing –

Clarifications:

- All work is figured for normal hours.
- Concrete and all restoration by others.
- Water meter provided by Saint Paul Regional Water Services, Installed by Kraft Mechanical.
- Saint Paul Regional Water Services will collaborate with Kraft Mechanical to deactivate the water main for the installation of a new curb stop.
- Proposal based off plan sheets C201 and C504, and SPRW Punchlist.
- Concrete Pads by others.

Exclusions:

- Temporary utilities
- Import and Export Soils
- Bonds
- Allowances
- Structural Steel
- Final clean up
- Fire Protection
- Concrete pads & bases
- Access panels
- Dumpsters
- Roofing
- Painting
- Concrete saw cut & patch.
- Temp Heat.
- Ground Thaw Heating
- Electrical

Proposal based on plans & narrative prepared by LHB dated 1/24/2023.

Plans Received: PR 02

WE PROPOSE hereby to furnish material and labor - complete in accordance with above specifications, for the sum of:

Base Bid: -----\$ 38,700. 00

All material is guaranteed to be as specified. All work to be completed in a workmanlike manner according to standard practices. Kraft Contracting, L.L.C. accepts the responsibility for the construction work only as it relates to the bid scope as detailed in the bidding documents. We exclude engineering liability for the design or code compliance of the construction. Any alteration or deviation from above specifications involving extra costs will become an extra charge over and above the estimate. Kraft Contracting, L.L.C. will not be held liable for agreements contingent upon strikes, accidents or delays beyond our control. Building owner to carry fire, property and other necessary insurance. Our workers are covered by workmen's compensation insurance. Kraft Contracting, L.L.C. will not be responsible for, nor will bid on this project; any work or cost of asbestos abatement. Building owner to provide safe work area with free access to carry out above work. All work to be performed during normal workday on straight time unless otherwise noted. 1 ½ % charged on all accounts over 30 days. Kraft Contracting L.L.C. has the right to terminate this proposal with no recourse should any clerical or other errors become evident before a contract is signed. As part of this Proposal, if it is required by the Contract, Kraft Contracting L.L.C. will provide commercial general liability insurance to the fullest extent of its current insurance coverage. . Kraft Contracting will not assume any insurance obligations beyond that included in its current insurance policy.

Corey Huberty

Office 651-773-9000

Chuberty@kraftcm.com

Note: Proposal may be withdrawn by us if not accepted within 30 days.

ACCEPTANCE OF PROPOSAL - The above prices, specifications and conditions are satisfactory and hereby accepted. You are authorized to do the work as specified. Payment will be made as outlined above.

Date of Acceptance _____ Authorized Signature _____



SUBMITTAL FORM

To: Ryan Sunram
Project Manager
ryan@sunramconstructioninc.com
763-420-2140

Sunram Construction
20010 75th Ave N
Cororan, MN 55340

From: Swen Pearson
Project Manager
swen@kraftcm.com
612-221-4147

Kraft Contracting & Mechanical LLC
2415 Ventura Drive, Suite 100
Woodbury, MN 55125

Job #: PR-02

Previously Submitted:

PROJECT: Maplewood Goodrich Park - PR 02

Date Submitted: 3/11/2024

REFERENCE: Curb Box

Specifications Section: - _____

Articles & Paragraphs: - _____

Other References: - _____

Description of Item: **Curb Box**

Manufacture: McDonald _____

Supplier's Name: - _____ Phone # - _____

DELIVERY VIA:

FORM TYPE:

REMARKS:

The following Submittal(s) is (are) attached for your review:

SUBMITTAL DATA SHEET

Curb Boxes – 5614

Minneapolis Pattern



MODEL NO.	SIZE	A-RANGE
5614	2 1/2	1 1/2' TO 2 1/2'
5614	3	2' TO 3'
5614	3 1/2	2 1/2' TO 3 1/2'
5614	4	3' TO 4'
5614	4 1/2	3 1/2' TO 4 1/2'
5614	5	4' TO 5'
5614	5 1/2	4 1/2' TO 5 1/2'
5614	6	5' TO 6'
5614	6 1/2	5 1/2' TO 6 1/2'
5614	7	6' TO 7'
5614	7 1/2	6 1/2' TO 7 1/2'
5614	8	7' TO 8'
5614	8 1/2	7 1/2' TO 8 1/2'
5614	9	8' TO 9'
5614	9 1/2	8 1/2' TO 9 1/2'
5614	10	9' TO 10'

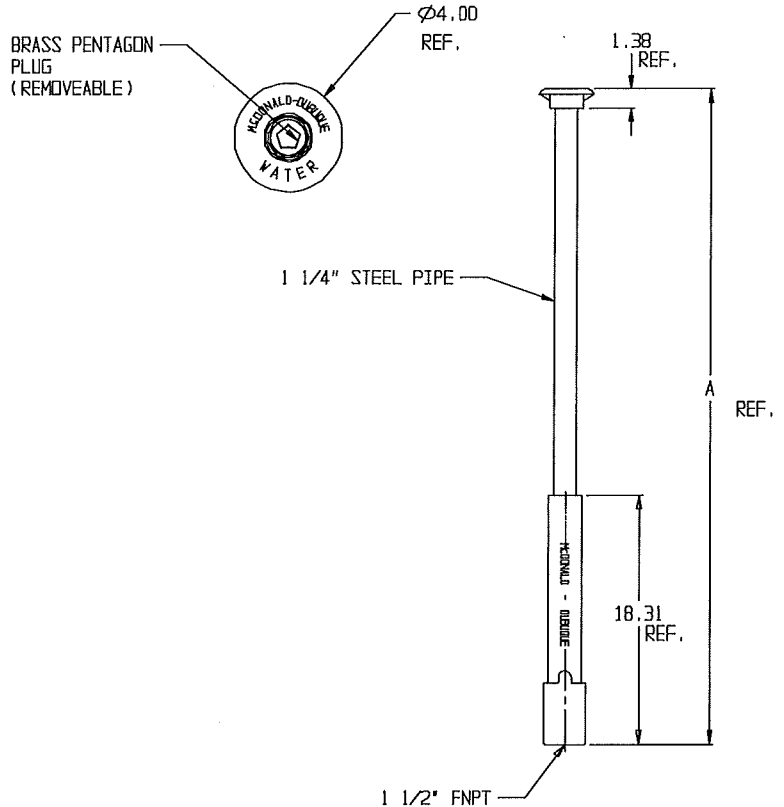

SUBMITTAL INFORMATION

- Brass components conform to ASTM B62 and ASTM B584, UNS C83600 -85-5-5-5 (latest revision) or ASTM B584, UNS C84400 -81-3-7-9 (latest revision)
- Lid and Base made of Cast Iron per ASTM A48, Class 25
- Upper Section made of steel pipe
- Coated with black dip



A.Y. McDonald Mfg. Co.
 P.O. Box 508
 Dubuque, IA 52004-508

Toll Free: 1-800-292-2737
Fax: 1-800-832-9296
Hours: 7:00 a.m. – 5:00 p.m., CST

sales@aymcdonald.com
www.aymcdonald.com

A.Y. McDonald considers the information on this assembly drawing correct when published. Item and option availability, including specifications, are subject to change without notice.

Submitted by:

09-14



SUBMITTAL FORM

To: Ryan Sunram
 Project Manager
ryan@sunramconstructioninc.com
 763-420-2140

Sunram Construction
 20010 75th Ave N
 Cororan, MN 55340

From: Swen Pearson
 Project Manager
swen@kraftcm.com
 612-221-4147

Kraft Contracting & Mechanical LLC
 2415 Ventura Drive, Suite 100
 Woodbury, MN 55125

Job #:

PROJECT: Maplewood Goodrich Park - PR 02

Previously Submitted:

Date Submitted: 3/11/2024

REFERENCE: Insulated Enclosure

Specifications Section: _____

Articles & Paragraphs: _____

Other References: - _____

Description of Item: **Insulated Enclosure**

Manufacture: Watts _____

Supplier's Name: - _____ Phone # - _____

DELIVERY VIA:

FORM TYPE:

REMARKS:

The following Submittal(s) is (are) attached for your review:

For Outdoor Installations

Job Name _____

Contractor _____

Job Location _____

Approval _____

Engineer _____

Contractor's P.O. No. _____

Approval _____

Representative _____

WattsBox

Insulated Enclosures

Specifications

Backflow prevention assemblies subjected to potential freezing conditions shall be protected with the WattsBox enclosure as shown.

The enclosure shall be of reinforced aluminum construction, providing access through doors for testing/certification purposes. It must also be totally removable for maintenance purposes. The enclosure shall be structurally lined with a unicellular, non-wicking insulation consisting of a sandwich laminate or applied by spray. It shall contain a thermostatically controlled heat source mounted to the interior wall or on the backflow preventer to provide protection to -30°F. No wood or "particle board" shall be allowed in assembly. Insulation mounted with glue will be cause for rejection. Power source will be protected with a ground fault circuit interrupting receptacle, UL Standard 943, NEMA 3R, installed by others, inside the box.

The enclosure shall contain drain openings sized to accommodate the maximum discharge of the reduced pressure zone assembly. Drain openings shall open to discharge under the most severe conditions. These openings are protected against intrusion of either wind, debris or animal. The enclosure is provided with means of permanent anchor and "lockable" access doors and/or lid to prohibit theft or vandalism.

All "wet" portions of the backflow prevention assembly shall be protected within the enclosure. Fire department hose connections and OSY indicating valve handles shall be maintained outside the enclosure.

The enclosure shall be factory assembled and delivered to the site ready to install with no drilling, screwing or riveting of enclosure required on site. The enclosure and the backflow preventer shall be covered by a single warranty policy. Enclosure shall be a Watts Series WattsBox.

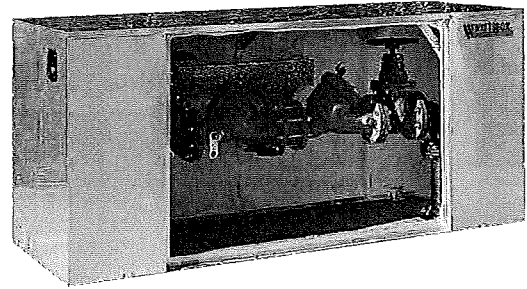

WattsBox Aluminum Enclosure

Features

- Designed to eliminate valve vault entry requirements of OSHA confined Space Ruling 29CFR 1910.146.
- Single source Watts Regulator warranty of the enclosure, the backflow preventer, and the heat source.
- Allows for the installation of the backflow preventer "at the service connection" in accordance with AWWA Standards.
- Is specifically designed to meet NFPA guidelines. The enclosure provides freeze protection to maintain the water supply to the property's fire protection system. (NFPA 3-3.1.8 and 3.6.1.3.2).
- Strategically placed doors provide access to the backflow prevention assembly for testing and repair without removal of the entire unit.
- An economical alternative to expensive retrofit installations.
- Eliminates potential drainage constraints in existing equipment rooms.
- Saves valuable floor space.
- Standardly furnished with thermostatically controlled heat source for freeze protection down to -30°F.
- Contains no structural wood or particle board for long life.
- Easy installation aluminum enclosures feature interlocking panels which eliminate the use of screws during assembly.
- Can be temporarily removed for replacement of the backflow preventer without the need for replacement of freeze protection services.
- ASSE 1060 Certified (Consult factory for approved models)

NOTICE

The information contained herein is not intended to replace the full product installation and safety information available or the experience of a trained product installer. You are required to thoroughly read all installation instructions and product safety information before beginning the installation of this product.

Watts product specifications in U.S. customary units and metric are approximate and are provided for reference only. For precise measurements, please contact Watts Technical Service. Watts reserves the right to change or modify product design, construction, specifications, or materials without prior notice and without incurring any obligation to make such changes and modifications on Watts products previously or subsequently sold.



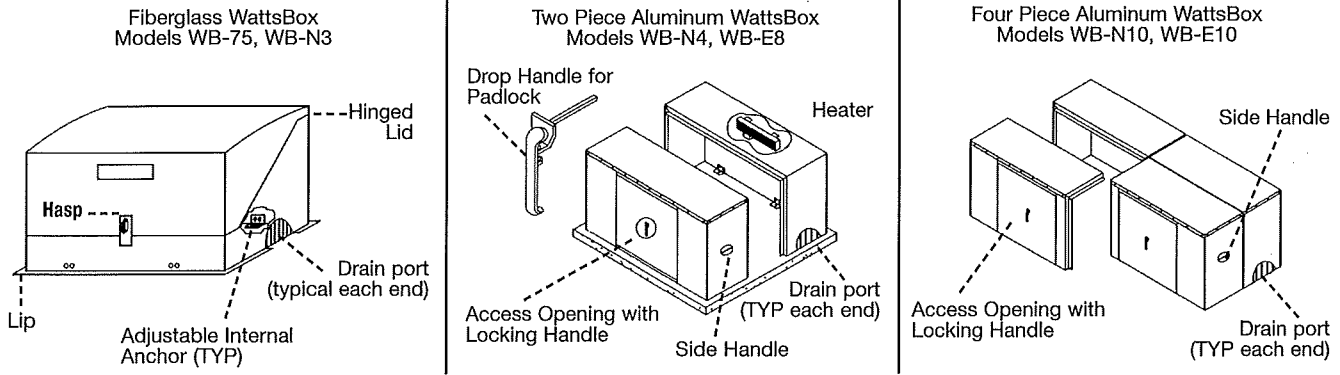

Construction

1. Minimum 18 gauge aluminum or fiberglass construction.
2. Structural unicellular insulation.
3. Stainless steel hasps or handle to accept customer supplied lock.
4. Relief ports at enclosure grade level.
5. Designed to protect to -30°F.
6. Minimum R of 8.
7. Adjustable internal anchors.

Heater Notes

1. 30W through 90W are heating cables, UL listed, CSA certified.
2. 1000W+ are wall mounted air heaters,  listed.
3. All circuits are 120 volt, single phase.
4. Service to WattsBox must be installed in accordance with the National Electric code and local ordinances, and protected with a G.F.I.

Typical Installation

1. Enclosure supplied with "anchor angles" at grade.
 - a. Recommended installation: on concrete slab
 - b. "Anchor angles" anchored to grade with mechanical fasteners (interior or exterior)
2. NRS (non-rising stem) valve handles enclosed inside enclosure
3. OSY (outside stem and yoke) valve handles concealed inside enclosure roof.
4. Door and construction hardware are lockable to prevent theft, vandalism or unauthorized entry.

Cutaway View of WattsBox Wall and Anchor

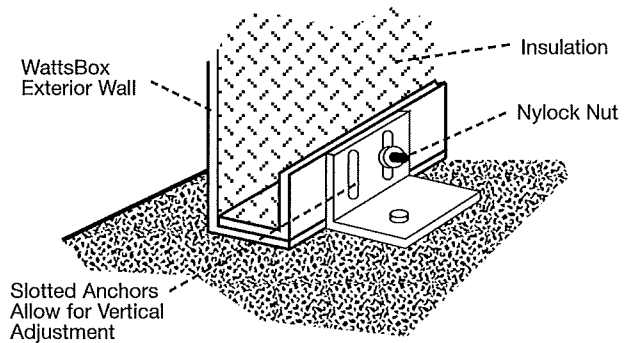

OSY Valve Enclosed — Side View

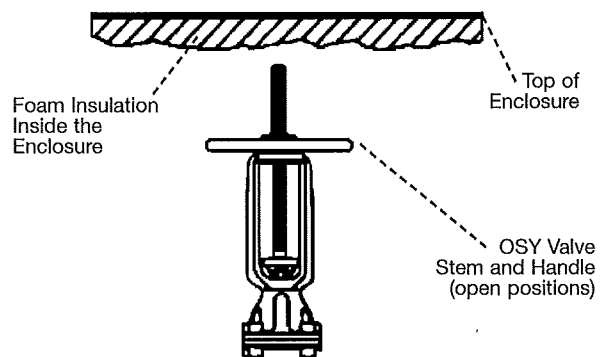

Dimensions

(all enclosures are available less heat - contact factory or your local Watts representative for details)

FITS WATTS VALVES	WATTS MODEL #	DIMENSIONS			HEATERS	WEIGHT LBS.	MOUNTING PAD SIZE
		12" CLEARANCE LENGTH X WIDTH X HEIGHT					
Fiberglass							
Thru ¾"							
007/LF007, 009/LF009, 909/LF909, 719/LF719, 919/LF919	WB-75		19" x 11" x 22"		30W	30	28" x 20"
Thru 1"							
007/LF007, 009/LF009, 909/LF909, 719/LF719, 919/LF919	WB-1		27" x 13" x 23"		60W	40	36" x 22"
Thru 1½"							
007/LF007, 009/LF009, 909/LF909, 719/LF719, 919/LF919	WB-1.5		33" x 21" x 25"		60W	60	44" x 32"
Thru - 2"							
007/LF007, 009/LF009, 909/LF909, 719/LF719, 919/LF919	WB-2		39" x 13" x 28"		90W	55	50" x 24"
¾" - 1"							
008/LF008, 800/LF800, 288/LF288, 289/LF289	WB-PVB1		18" x 9" x 18"		30W	25	19" x 27"
(Increases height by 6")	WB-PVB T1		18" x 9" x 24"		30W	28	19" x 27"
1¼" - 2"							
800 / 288	WB-PVB2		26" x 12" x 20"		60W	30	21" x 35"
(Increases height by 8")	WB-PVB T2		26" x 12" x 28"		60W	35	21" x 35"
2½" - 3" all							
007/LF007, 009/LF009, 909/LF909							
4" 774 NRS / OSY / DCDA							
4" 994NRS, 3" 775NRS / OSY / DCDA ,							
3" 995NRS, 4" 775NRS, 4" 994NRS,							
2½" - 3" 757DCDA, 2½" - 3" 957QT,							
2½" - 3" 957RPDA	WB-N3		70" x 26" x 45"		1000W	285	82" x 38"
4" 994OSY / RPDA, 4" 775OSY / DCDA,							
3" 995OSY / RPDA	WB-E3		70" x 26" x 55"		1500W	375	82" x 38"
2½" - 3" 957N NRS / OSY / BFG / QT,							
4" 957N NRS / BFG / QT	WB 3000		45" x 35" x 35"		1000W	265	57" x 47"
4" 957N OSY, 4" 757DCDA	WB 4000		53" x 44" x 44"		1000W	290	65" x 56"
Aluminum							
4" 709/LF709 NRS / OSY / DCDA,							
4" 909/LF909 NRS / OSY / RPDA,							
6" 774NRS / OSY / DCDA,							
6" 994NRS, 6" 775NRS,							
6" 995NRS, 8" 775NRS,							
4" 757NRS / OSY, 6" 757NRS / OSY / BFG,							
8" 757NRS / BFG, 4" 757DCDA, 6" 757DCDA,							
4" 957OSY, 6" 957NRS, 8" 957NRS	WB-N4		90" x 32" x 50.5"		1900W	400	102" x 44"
6" 957OSY, 6" 957RPDA	WB-E4		90" x 32" x 57.5"		1900W	435	102" x 44"
6" 709/LF709 NRS / OSY / DCDA,							
6" 909/LF909 NRS / OSY / RPDA,							
8" 774 / 994NRS, 10" 774 NRS,							
10" 957NRS	WB-N6		105" x 36" x 53"		1900W	480	117" x 48"
6" 994 OSY / RPDA, 8" 774 OSY / DCDA,							
10" 994 NRS, 6" 775OSY / DCDA,							
8" 775OSY / DCDA, 6" 995OSY / RPDA,							
8" 757OSY, 10" 757NRS, 8" 757DCDA,							
8" 957OSY, 8" 957RPDA	WB-E6		105" x 36" x 64"		3000W	530	117" x 48"
8" 709/LF709, 909/LF909 NRS	WB-N8		118" x 40" x 58"		3000W	565	130" x 52"
8" 709/LF709 OSY / DCDA, 8" 909/LF909 / 994OSY / RPDA,							
10" 774OSY / DCDA,							
8" 757OSY / DCDA, 8" 957OSY / RPDA,							
10" 757NRS, 10" 957NRS	WB-E8		118" x 40" x 74"		3000W	625	130" x 52"
10" 709/LF709, 909/LF909 NRS	WB-N10		142" x 42" x 65"		3000W	620	154" x 54"
10" 709/LF709 OSY / DCDA, 10" 909/LF909 / 994OSY / RPDA,							
10" 757OSY / DCDA, 10" 957OSY / RPDA	WB-E10		142" x 42" x 85"		3800W	700	154" x 54"
2½" - 3" 757N OSY, 4" 757N NRS / BFG,							
6" 757N NRS / BFG, 6" 957N BFG	WB 4000AN		53" x 33" x 44"		1000W	280	65" x 45"
4" 757N OSY, 3" 757N DCDA, 6" 957N NRS,							
8" 957N NRS, 2½" - 3" 957N RPDA, 4" 957N RPDA	WB 4000AE		53" x 44" x 44"		1000W	340	65" x 56"
8" 757N NRS, 4" 957 QT	WB 6000AN		62" x 39" x 46"		1500W	350	74" x 51"
6" 757N OSY, 6" 757N DCDA, 6" 957N OSY,							
8" 957N NRS, 6" 957N RPDA	WB 6000AE		62" x 53" x 46"		1500W	440	74" x 65"

Dimensions (cont.)

FITS WATTS VALVES	WATTS MODEL #	DIMENSIONS		HEATERS	WEIGHT LBS.	MOUNTING PAD SIZE
		12" CLEARANCE	LENGTH X WIDTH X HEIGHT			
Stucco Aluminum						
2½" - 3" 757N NRS / BFG / QT	WB 2000A		39" x 24" x 32"	90W	120	42" x 34"
2½" - 3" 757NRS / QT / BFG, 4" 757BFG	WB 2.5		60" x 22" x 30"	(2) 90W	100	63" x 32"
2½" - 3" 757OSY, 2½" - 3" 957NRS / OSY, 4" 957NRS	WB 2.75		60" x 22" x 42"	(2) 90W	140	63" x 44"
10" 757OSY, 10" 757DCDA, 10" 957OSY, 10" 957RPDA	WB 6 ET		105" x 36" x 80"	(2) 1500W	551	108" x 82"
10" 757N NRS	WB 8000ANT		73" x 45" x 60"	2000W	363	75" x 62"
8" 757N OSY, 8" 757N DCDA, 10" 757N OSY, 10" 757N DCDA, 8" 957N OSY, 10" 957N NRS, 10" 957N OSY, 8" 957N RPDA, 10" 957N DCDA	WB 8000AET		73" x 67" x 60"	2000W	453	76" x 62"
Strainer Models						
¼" - 2"	WB-2S		47" x 13" x 28"	90W	65	58" x 24"
2½" - 3" NRS	WB-N3S		83" x 26" x 45"	1500W	365	95" x 38"
2½" - 3" OSY	WB-E3S		83" x 26" x 55"	1500W	365	95" x 38"
4" NRS	WB-N4S		102" x 32" x 50.5"	2000W	415	114" x 44"
4" OSY	WB-E4S		102" x 32" x 57.5"	2000W	425	114" x 44"
6" NRS	WB-N6S		125" x 36" x 53"	3000W	545	137" x 48"
6" OSY	WB-E6S		125" x 36" x 64"	3000W	550	137" x 48"
8" NRS	WB-N8S		142" x 40" x 58"	3000W	585	154" x 52"
8" OSY	WB-E8S		142" x 40" x 74"	4000W	650	154" x 52"
10" NRS	WB-N10S		172" x 42" x 65"	4000W	685	184" x 54"
10" OSY	WB-E10S		172" x 42" x 85"	3800W	825	184" x 54"



USA: T: (978) 689-6066 • F: (978) 975-8350 • Watts.com
 Canada: T: (905) 332-4090 • F: (905) 332-7068 • Watts.ca
 Latin America: T: (52) 81-1001-8600 • Watts.com



SUBMITTAL FORM

To: Ryan Sunram
 Project Manager
ryan@sunramconstructioninc.com
 763-420-2140

Sunram Construction
 20010 75th Ave N
 Cororan, MN 55340

From: Swen Pearson
 Project Manager
swen@kraftcm.com
 612-221-4147

Kraft Contracting & Mechanical LLC
 2415 Ventura Drive, Suite 100
 Woodbury, MN 55125

Job #: PR-02

Previously Submitted:

PROJECT: Maplewood Goodrich Park - PR 02

Date Submitted: 3/11/2024

REFERENCE: Reduced Pressure Zone

Specifications Section: - _____

Articles & Paragraphs: - _____

Other References: - _____

Description of Item: **RPZ**

Manufacture: Watts

Supplier's Name: - Phone # -

DELIVERY VIA:

FORM TYPE:

REMARKS:

The following Submittal(s) is (are) attached for your review:

Engineering Specification

Job Name _____
 Job Location _____
 Engineer _____
 Approval _____

Contractor _____
 Approval _____
 Contractor's P.O. No. _____
 Representative _____

LEAD FREE*

Series LF009 Reduced Pressure Zone Assemblies 1/4" – 3"

Series LF009 Reduced Pressure Zone assemblies are designed to protect potable water supplies in accordance with national plumbing codes and water authority requirements. These series are used in a variety of installations, including the prevention of health hazard cross-connections in piping systems or for containment at the service line entrance. They are also used in irrigation systems, boiler feed, water lines, and other installations requiring maximum protection. The body construction is fused with ArmorTek™ coating technology to resist corrosion due to microbial induced corrosion (MIC) or exposed metal substrate.* The series also features Lead Free* construction to comply with Lead Free* installation requirements.

The series features two in-line, independent check valves, captured springs, and replaceable check seats with an intermediate relief valve. Its compact modular design facilitates maintenance and assembly access. Sizes 1/4" to 1" shutoffs have tee handles.

Series LF009 assemblies of sizes 1/2" to 3" include a flood sensor to detect excessive water discharges from the relief valve. The sensor is installed on the assembly exterior and does not alter assembly functions or certifications. The sensor relays a signal that triggers notification to facility personnel who can take corrective action, thus avoiding the possibility of ruinous flooding and costly damage.

NOTICE

An add-on connection kit is required to activate the flood sensor. Without the connection kit, the sensor is a passive component that has no communication with any other device. (For more information, download RP/IS-009.)

Features

- Single access cover and modular check construction for ease of maintenance
- Top entry to all internals for immediate accessibility
- Captured springs for safe maintenance
- Internal relief valve for reduced installation clearances
- Replaceable seats for economical repair
- ArmorTek™ coating technology to resist internal corrosion†

*The wetted surface of this product contacted by consumable water contains less than 0.25% of lead by weight.

†ArmorTek coating applied to the 2 1/2" and 3" models only.

Watts product specifications in U.S. customary units and metric are approximate and are provided for reference only. For precise measurements, please contact Watts Technical Service. Watts reserves the right to change or modify product design, construction, specifications, or materials without prior notice and without incurring any obligation to make such changes and modifications on Watts products previously or subsequently sold.

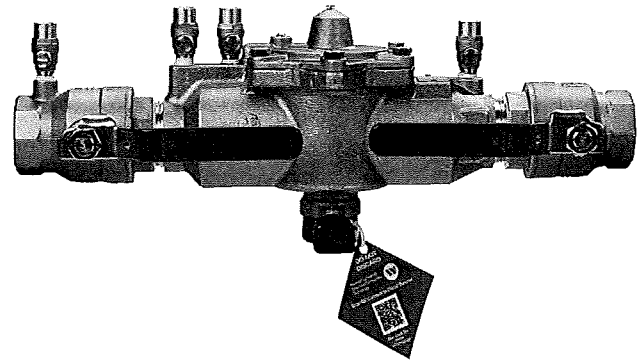

LF009M2-QT-FS

- Lead Free* cast copper silicon alloy body construction (1/4" – 2")
- Fused epoxy coated cast iron body (2 1/2" – 3")
- Ball valve test cocks — screwdriver slotted (1/4" – 2")
- Large body passages provides low pressure drop
- Compact, space saving design
- No special tools required for servicing
- Sensor on the relief valve for flood detection (1/2" – 3")
- Flood alerts feature activated with add-on sensor connection kit, compatible with BMS and cellular communication

NOTICE

Use of the flood sensor does not replicate the need to comply with all required instructions, codes, and regulations related to installation, operation, and maintenance of this product, including Watts® is not responsible for the failure of alerts due to connectivity or power issues.

NOTICE

The information contained herein is not intended to replace the full product installation and safety information available or the experience of a trained product installer. You are required to thoroughly read all installation instructions and product safety information before beginning the installation of this product.

Inquire with governing authorities for local installation requirements.

WATTS®

Specification

A Reduced Pressure Zone Assembly shall be installed at each potential health hazard location to prevent backflow due to backsiphonage and/or backpressure. The assembly shall consist of an internal pressure differential relief valve located in a zone between two positive seating check modules with captured springs and silicone seat discs. Seats and seat discs shall be replaceable in both check modules and the relief valve. There shall be no threads or screws in the waterway exposed to line fluids. Service of all internal components shall be through a single access cover secured with stainless steel bolts. Body and shutoffs shall be constructed using Lead Free* cast copper silicon alloy materials. Lead Free* reduced pressure zone assembly shall comply with state codes and standards, where applicable, requiring reduced lead content.

The assembly shall also include two resilient seated isolation valves, four resilient seated test cocks, and an air gap drain fitting. The valve body shall utilize a coating system with built-in electrochemical corrosion inhibitor and microbial inhibitor.† The assembly shall meet the requirements of USC; ASSE Std. 1013; AWWA Std. C511; CSA B64.4. Shall be a Watts Series LF009, and shall include a sensor on the relief valve for flood detection on sizes 1/2" to 3".

Materials

1/4" – 2"

Lead Free* cast copper silicon alloy body construction, silicone rubber disc material in the first and second check plus the relief valve. Replaceable polymer check seats for first and second checks. Removable relief valve seats. Stainless steel cover bolts.

Standardly furnished with NPT body connections. Model LF009QT furnished with quarter-turn, full port, resilient seated, Lead Free* cast copper silicon alloy body ball valve shutoffs.

2 1/2" – 3"

- FDA-approved epoxy-coated cast iron unibody with plastic seats
- Relief valve with stainless steel seat and trim
- Lead Free* cast copper silicon alloy body ball valve test cocks

Model/Option

1/4" – 2"

Prefix:

U – Union connections

Suffix:

FS – Flood detection sensor (1/2" – 2")

LF – Without shutoff valves

PC – Internal polymer coating

Press** – Press inlet x press outlet (1/2" – 2")

QT – Quarter-turn ball valves

S – Strainer

2 1/2" – 3"

Suffix:

FS – Flood detection sensor

LF – Without shutoff valves

NRS – Non-rising stem resilient seated gate valves

OSY – UL Classified and FM Approved outside stem and yoke resilient seated gate valves

S-FDA – FDA epoxy coated strainer

NOTE: The installation of a drain line is recommended. When installing a drain line, an air gap is necessary. (For more information download ES-AG/EL/TC at watts.com.)

Pressure – Temperature

1/4" – 2"

Suitable for supply pressure up to 175 psi (12.1 bar)

Water temperature: 33°F – 180°F (0.5° – 82°C)

2 1/2" – 3"

Suitable for supply pressures up to 175 psi (12.1 bar)

Water temperature: 110°F (43°C) continuous; 140°F (60°C) intermittent

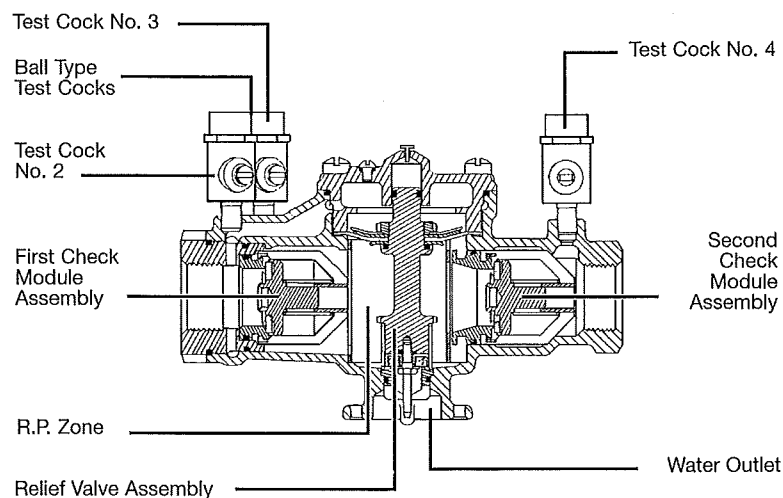

** Viega ProPress® connections are optional factory-installed fitting on each end of the approved/certified assembly.

Standards

USC
 ASSE No. 1013
 AWWA C511
 CSA B64.4
 IAPMO File No. 1563

Approvals



ASSE, AWWA, CSA, IAPMO

Approved by the Foundation for Cross-Connection Control and Hydraulic Research at the University of Southern California

Approval models NRS, OSY, PC, QT

UL Classified

2½" – 3" with OSY gate valves

¾" – 2" without shutoff valves (-LF), except LF009M3LF

Insulated Enclosure

The WattsBox insulated enclosure is available for Series LF009. For more information download ES-WB at watts.com.

Air Gaps and Elbows

Call customer service if you need assistance with technical details.

MODEL	DRAIN OUTLET	DIMENSIONS				WEIGHT			
		A		B		lb	kg		
909AGA	For 909, 009, and 993 sizes ¼"-½" 009, ¾" 009M2/M3	½"	13	2¾"	60	3¾"	79	0.625	0.28
909AGC	¾"-1" 009/909, 1"-1½" 009M2	1"	25	3¼"	83	4⅞"	124	1.5	0.68
909AGF	1¼"-2" 009M1, 1¼"-3" 009/909, 2" 009M2, 4"-6" 993	2"	51	4⅞"	111	6¾"	171	3.25	1.47
909AGK	4"-6" 909, 8"-10" 909M1	3"	76	6⅞"	162	9⅞"	244	6.25	2.83
909AGM	8"-10" 909	4"	102	7⅞"	187	11¼"	286	15.5	7.03
909ELA	¼"-½" 009, ¾" 009M2/M3	-	-	-	-	-	-	-	-
909ELC	¾"-1" 009/909	-	-	2¾"	60	2¾"	60	0.38	0.17
909ELF*	1¼"-2" 009M1, 1¼"-2" 009/909, 2" 009M2, 4"-6" 993	-	-	3⅞"	92	3⅞"	92	2	0.91
909ELH* Vertical	2½"-3" 009/909	-	-	-	-	-	-	-	-

*Epoxy coated

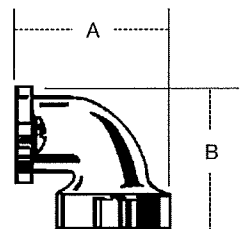
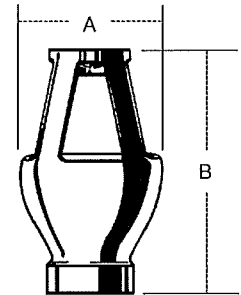

Dimensions – Weight

Call customer service if you need assistance with technical details.

1/4" – 3/8"

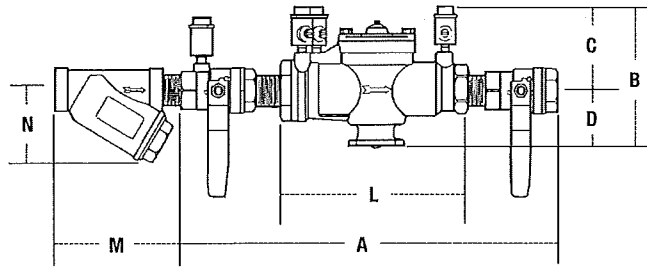

1/2" – 2"

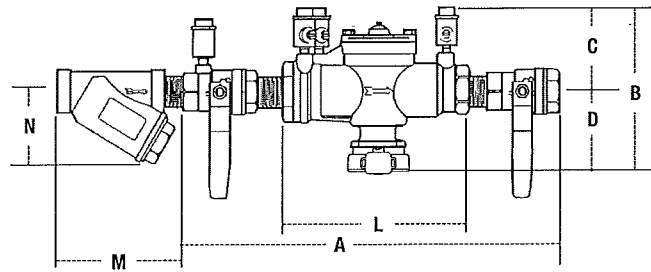

SIZE	DIMENSIONS (APPROX.)										WEIGHT					
	A		B		C		D		L		M		N		lb	kg
in.	in.	mm	in.	mm	in.	mm	in.	mm	in.	mm	in.	mm	in.	mm		
1/4	10	250	4 5/8	117	3 3/8	86	1 1/4	32	5 1/2	140	2 3/8	60	2 1/2	64	5	2
3/8	10	250	4 5/8	117	3 3/8	86	1 1/4	32	5 1/2	140	2 3/8	60	2 1/2	64	5	2
1/2	10	250	5 1/4	149	3 3/8	86	2 1/2	64	5 1/2	140	2 3/4	70	2 1/4	57	5	2
3/4	10 3/4	273	6 1/4	159	3 1/2	89	2 3/4	70	6 3/4	171	3 3/16	81	2 3/4	70	6	3
1	14 1/2	368	6 1/4	159	3	76	3 1/4	83	9 1/2	241	3 3/4	95	3	76	12	5
1 1/4	17 3/8	441	6 3/4	169	3 1/2	89	3 3/4	83	11 3/8	289	4 7/16	113	3 1/2	89	15	6
1 1/2	17 3/8	454	6 3/4	169	3 1/2	89	3 3/4	83	11 1/8	283	4 7/8	124	4	102	16	7
2	21 3/8	543	8 3/4	222	4 1/2	114	4 1/4	108	13 1/2	343	5 7/16	151	5	127	30	13

2 1/2" – 3"

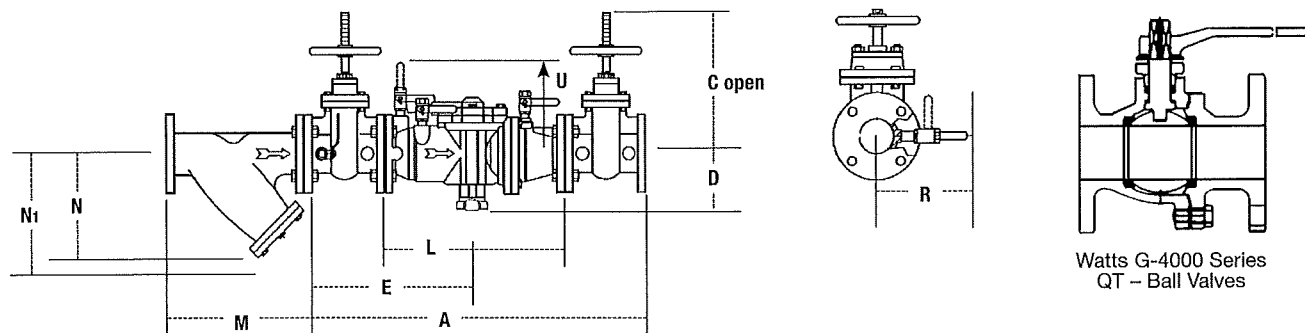

Watts G-4000 Series
QT – Ball Valves

STRAINER SIZE	DIMENSIONS (APPROX.)						WEIGHT		
	M		N		N1 †		lb	kg	
in.	mm	in.	mm	in.	mm	in.	mm		
2 1/2	65	10	254	6 1/2	165	9 3/4	248	28	12.7
3	80	10 1/4	257	7	178	10	254	34	15.4

† Clearance for servicing

MODEL	SIZE	DIMENSIONS (APPROX.)										WEIGHT					
		A		C		D		E		L		R		U		lb	kg
	in.	in.	mm	in.	mm	in.	mm	in.	mm	in.	mm	in.	mm	in.	mm		
LF009LF	2 1/2	—	—	—	—	5 5/8	143	—	—	18 3/8	460	—	—	10 3/8	270	76	34.5
LF009OSY	2 1/2	33 3/4	845	15 3/8	403	5 5/8	143	16 3/8	416	18 3/8	460	7 3/4	197	10 3/8	270	166	75.3
LF009NRS	2 1/2	33 3/4	845	11 3/8	289	5 5/8	143	16 3/8	416	18 3/8	460	7 3/4	197	10 3/8	270	161	73.0
LF009LF	3	—	—	—	—	5 5/8	143	—	—	18 3/8	460	—	—	10 3/8	270	76	34.5
LF009OSY	3	34 3/4	870	18 1/2	470	5 5/8	143	16 3/8	422	18 3/8	460	8 3/4	222	10 3/8	270	198	89.8
LF009NRS	3	34 3/4	870	12 3/4	324	5 5/8	143	16 3/8	422	18 3/8	460	8 3/4	222	10 3/8	270	191	86.6

Capacity

Performance as established by an independent testing laboratory.

The asterisk (*) indicates the typical maximum system flow rate (7.5 ft/s, 2.3 m/s).

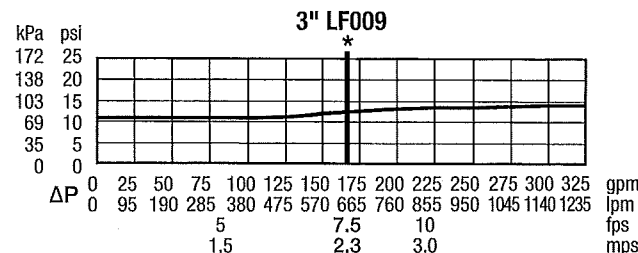
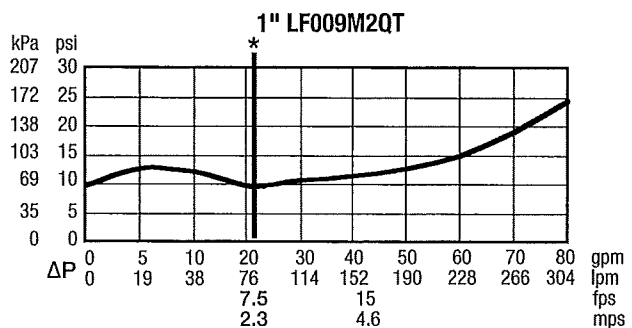
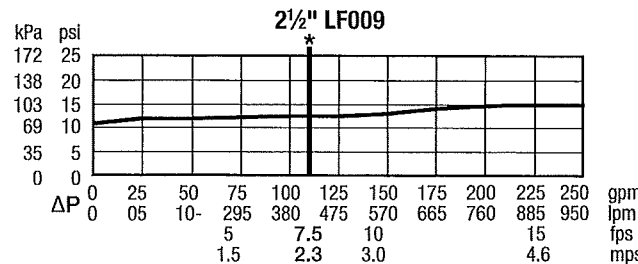
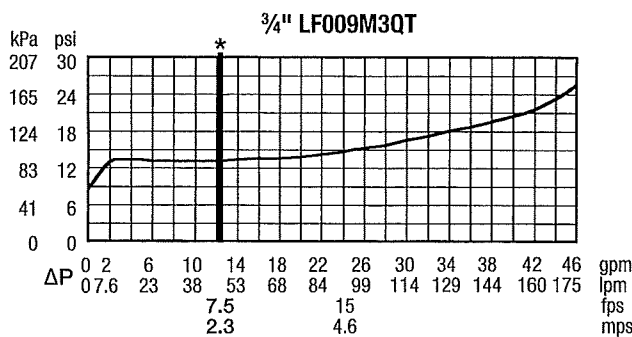
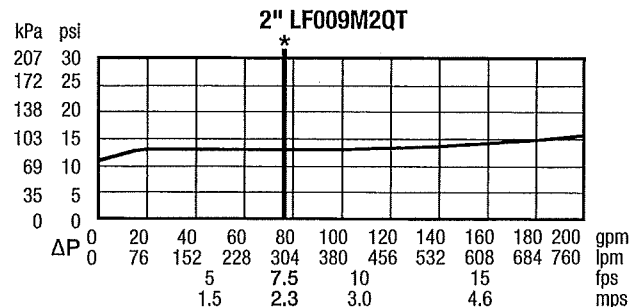
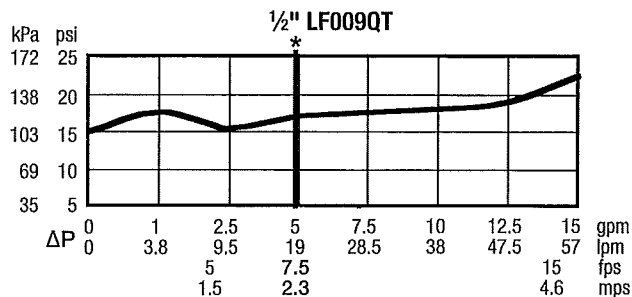
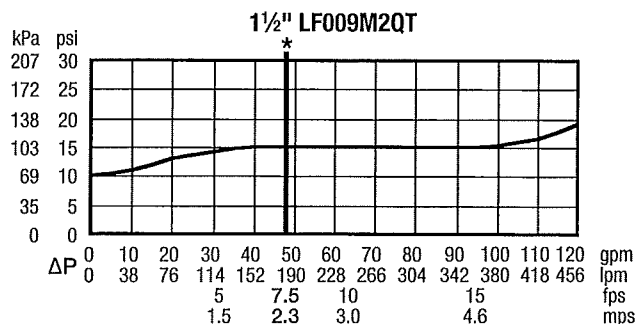
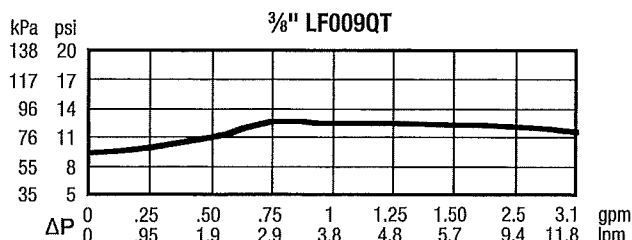
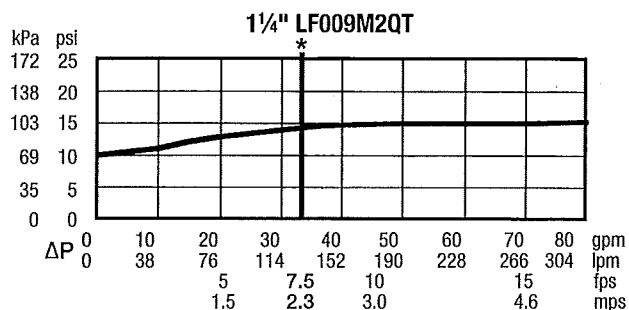
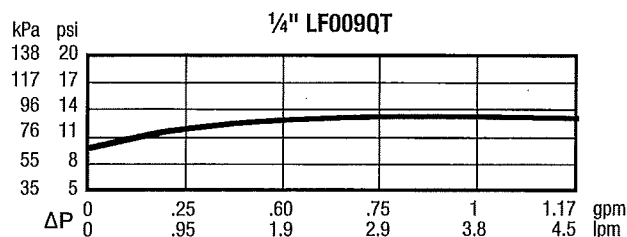

USA: T: (978) 689-6066 • Watts.com
 Canada: T: (888) 208-8927 • Watts.ca
 Latin America: T: (52) 55-4122-0138 • Watts.com





SUBMITTAL FORM

To: Ryan Sunram
Project Manager
ryan@sunramconstructioninc.com
763-420-2140

From: Swen Pearson
Project Manager
swen@kraftcm.com
612-221-4147

Sunram Construction
20010 75th Ave N
Cororan, MN 55340

Kraft Contracting & Mechanical LLC
2415 Ventura Drive, Suite 100
Woodbury, MN 55125

Job #: PR-02

Previously Submitted:

PROJECT: Maplewood Goodrich Park - PR 02

Date Submitted: 3/11/2024

REFERENCE: General duty valves

Specifications Section: - _____

Articles & Paragraphs: - _____

Other References: - _____

Description of Item: **Ball Valves, Water Pressure Reducing Valve, Inline Curb Valve**

Manufacture: Watts, Mueller

Supplier's Name: - _____ Phone # - _____

DELIVERY VIA:

FORM TYPE:

REMARKS:

The following Submittal(s) is (are) attached for your review:

For Commercial and Industrial Applications

Job Name _____
 Job Location _____
 Engineer _____
 Approval _____

Contractor _____
 Approval _____
 Contractor's P.O. No. _____
 Representative _____

LEAD FREE*

G2 Series LFB6080-G2-SS, LFB6081-G2-SS 2-Piece, Full Port, Lead Free* Bronze Ball Valves with Stainless Steel Trim

Sizes: 1/4" – 4"

The G2-SS series ball valves are a 2-Piece, Full Port, Lead Free, Bronze valve with Stainless Steel trim. These products are ideal for potable water, commercial, and industrial applications. These valves features a blowout proof stem, as well as a full-port design which ensures minimal pressure drop. The G2-SS series offers multiple models for solder and NPT end-connections with NSF-61G certification.

Features

- Lead Free*, forged bronze body and adapter
- Full-port flow
- Full range of sizes from 1/4" – 4"
- Certified to NSF/ANSI/CAN 61 & NSF/ANSI/CAN 372
- 316 Stainless steel ball and stem
- Minimal pressure drop due to large ports
- Blowout proof, pressure retaining stem
- Adjustable stem packing gland
- White handles for easy Lead Free* identification
- 100% Factory tested in USA

Models

LFB6080 G2-SS 1/4" – 4" 316 stainless steel ball and stem threaded NPT end connections
LFB6081 G2-SS 3/8" – 3" 316 stainless steel ball and stem solder end connections

Please refer to watts.com for BAA information on specific models.

NOTICE

The information contained herein is not intended to replace the full product installation and safety information available or the experience of a trained product installer. You are required to thoroughly read all installation instructions and product safety information before beginning the installation of this product.

Watts product specifications in U.S. customary units and metric are approximate and are provided for reference only. For precise measurements, please contact Watts Technical Service. Watts reserves the right to change or modify product design, construction, specifications, or materials without prior notice and without incurring any obligation to make such changes and modifications on Watts products previously or subsequently sold.

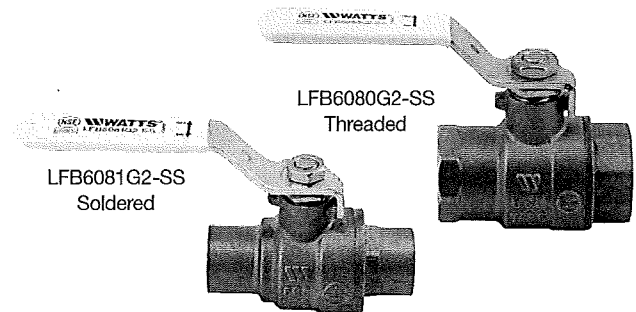

Pressure — Temperature

Temperature Range:

0°F - 400°F (-18°C – 205°C) @ 50psi (3.4 bar)

Pressure Range:

1/4" – 2" 600psi (41 bar) WOG, non-shock;
 150psi (10.3 bar) WSP

2 1/2" – 4 400psi (27.5 bar) WOG, non-shock;
 125psi (8.6 bar) WSP

Specifications

A 2-piece full port Lead Free* bronze ball valve to be installed as indicated on the plans. Valves with top loaded stems or valves without adjustable packing are not acceptable. Pressure up to 600psi for 1/4" to 2" and 400psi for 2 1/2" to 4". The valve shall be constructed using Lead Free* bronze. Lead Free* ball valves shall comply with state codes and standards, where applicable, requiring reduced lead content. Valve must conform to NSF-61G and shall be a Watts Series LFB6080G2-SS (threaded) or LFB6081G2-SS (solder).

Standards

Tested and Certified by NSF International
 NSF-61 Potable Water and NSF 372 low lead.

Complies with MSP-110



Applications

- Full range of fluids
- Hydronic Heating (90% glycol max)
- Low Pressure Steam, 15 psi max
- Not applicable for flammable gas installations
- Not compatible with soft annealed copper tubing

*The wetted surface of this product contacted by consumable water contains less than 0.25% of lead by weight.

NOTICE

For soldered versions, heat **MUST** be directed **AWAY** from the center of the valve body as excessive heat harm the seats. After soldering, the packing nut may have to be tightened.

WATTS®

Materials

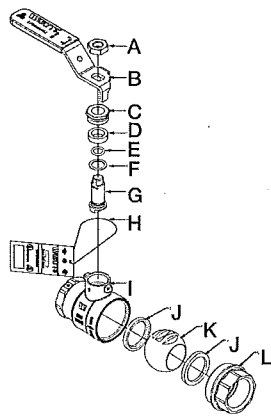

- A. Handle Nut Zinc-plated carbon steel
- B. Handle Assembly Zinc-plated carbon steel with vinyl insulator
- C. Packing Nut Brass
- D. Stem Packing Virgin PTFE
- E. O-ring Fluorocarbon elastomer (FKM)
- F. Thrust Washer Virgin PTFE
- G. Stem 316 Stainless Steel
- H. Tag Cardboard, Mylar coated both sides
- I. Body Forged Lead Free* bronze
- J. Seats Virgin PTFE
- K. Ball 316 Stainless Steel
- L. Adapter Forged Lead Free* bronze

Temperature – Pressure

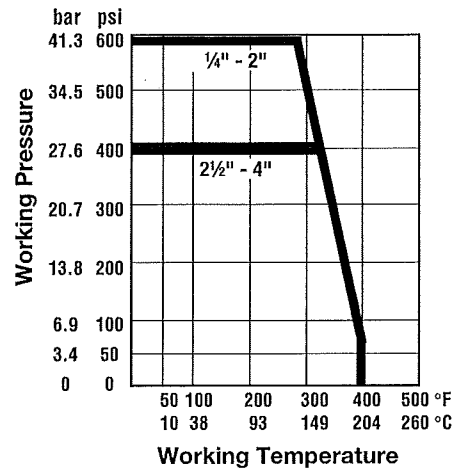

Dimensions – Weights

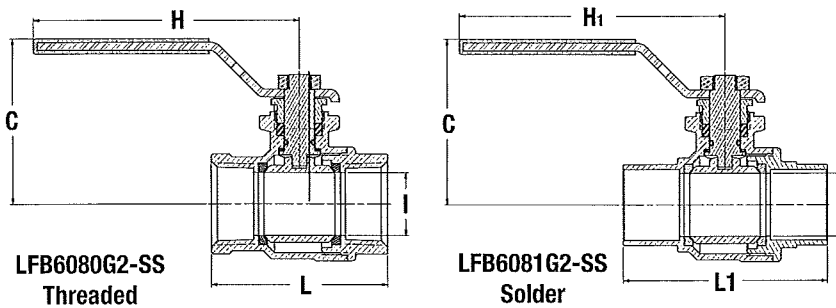

SIZE	DIMENSIONS								WEIGHT					
	C		H, H1		I		L		L1		LFB6080G2		LFB6081G2	
in	in	mm	in	mm	in	mm	in	mm	in	mm	lb	kg	lb	kg
1/4"	1 13/16	46	3 7/16	87	7/16	11	1 3/4	47	-	-	0.4	0.2	-	-
3/8"	1 13/16	46	3 7/16	87	1/2	13	1 7/8	48.3	1 15/16	49	0.4	0.2	0.4	0.18
1/2"	1 13/16	46	3 7/16	87	1/2	13	2	57	2 5/8	54	0.5	0.22	0.4	0.18
3/4"	2 1/4	58	3 15/16	101	3/4	19	2 1/4	58	3	76	0.9	0.41	0.8	0.36
1"	2 5/8	67	4 1/4	108	1	26	3	77	3 1/2	89	1.4	0.65	1.3	0.57
1 1/4"	2 13/16	72	4 1/4	108	1 1/4	32	3 3/8	86	3 3/8	98	2.1	0.94	1.8	0.82
1 1/2"	3 1/8	80	5 1/8	135	1 1/2	38	3 1/2	93	4 1/8	109	3.1	1.4	2.7	1.23
2"	3 1/2	89	6	153	2	51	4 1/4	108	5 3/8	136	4.9	2.25	4.4	2.02
2 1/2"	4 1/8	104	7 3/8	187	2 1/2	63.6	5 1/8	134	6 1/4	158	9.0	4.1	8.2	3.7
3"	4 1/2	114	7 3/4	197	3	76.3	6 1/8	154	7 3/8	185	13.9	6.3	12.9	5.9
4"	5 3/8	136	9 5/8	245	7 1/8	189	7 1/8	189	-	-	27.7	12.6	-	-

Ordering Chart

Ordering Code	Valve		Locking Handle Kit				Stem Extension		
	Description	Connection Type	EDP	Description	Size	EDP	Description	Size	
LFB6080G2-SS	0450115	1/4 LFB6080G2-SS	Threaded	88005484	#1 LL-HK LFB6080/1 G2-SS	Fits 1/4" - 1/2"	0789542	SXI-HK-1A StemExtension	1/4"-1/2" 3C/3CM1/G2
	0450116	3/8 LFB6080G2-SS	Threaded	88005484	#1 LL-HK LFB6080/1 G2-SS	Fits 1/4" - 1/2"	0789542	SXI-HK-1A StemExtension	1/4"-1/2" 3C/3CM1/G2
	0450117	1/2 LFB6080G2-SS	Threaded	88005484	#1 LL-HK LFB6080/1 G2-SS	Fits 1/4" - 1/2"	0789542	SXI-HK-1A StemExtension	1/4"-1/2" 3C/3CM1/G2
	0450118	3/4 LFB6080G2-SS	Threaded	88005485	#2 LL-HK LFB6080/1 G2-SS	Fits 3/4"	0789550	SXI-HK-9A StemExtension	3/4" 3C/G2
	0450119	1 LFB6080G2-SS	Threaded	88005486	#3 LL-HK LFB6080/1 G2-SS	Fits 1" -1 1/4"	0789551	SXI-HK-10A StemExtension	1" - 1 1/4" 3C/G2
	0450120	1 1/4 LFB6080G2-SS	Threaded	88005486	#3 LL-HK LFB6080/1 G2-SS	Fits 1" -1 1/4"	0789551	SXI-HK-10A StemExtension	1" - 1 1/4" 3C/G2
	0450121	1 1/2 LFB6080G2-SS	Threaded	88005487	#4 LL-HK LFB6080/1 G2-SS	Fits 1 1/2"	0789552	SXI-HK-11A StemExtension	1 1/2" 3C/G2
	0450122	2 LFB6080G2-SS	Threaded	88005488	#5 LL-HK LFB6080/1 G2-SS	Fits 2"	0789546	SXI-HK-5A StemExtension	2" 3C/3CM1/G2
	0422015	2 1/2 LFB6080G2-SS	Threaded	88005490	#6 LL-HK LFB6080/1 G2-SS	Fits 2 1/2"	0789547	SXI-HK-6A StemExtension	2 1/2" 3C/3CM1/G2
	0422016	3 LFB6080G2-SS	Threaded	88005491	#7 LL-HK LFB6080/1 G2-SS	Fits 3"	0789548	SXI-HK-7A StemExtension	3" 3C/3CM1/G2
	0422017	4 LFB6080G2-SS	Threaded	88005492	#8 LL-HK LFB6080/1 G2-SS	Fits 4"	0789549	SXI-HK-8A StemExtension	4" 3C/3CM1/G2
LFB6081G2-SS	0450123	3/8 LFB6081G2-SS	Solder	88005484	#1 LL-HK LFB6080/1 G2-SS	Fits 1/4" - 1/2"	0789542	SXI-HK-1A StemExtension	1/4"-1/2" 3C/3CM1/G2
	0450124	1/2 LFB6081G2-SS	Solder	88005484	#1 LL-HK LFB6080/1 G2-SS	Fits 1/4" - 1/2"	0789542	SXI-HK-1A StemExtension	1/4"-1/2" 3C/3CM1/G2
	0450125	3/4 LFB6081G2-SS	Solder	88005485	#2 LL-HK LFB6080/1 G2-SS	Fits 3/4"	0789550	SXI-HK-9A StemExtension	3/4" 3C/G2
	0450126	1 LFB6081G2-SS	Solder	88005486	#3 LL-HK LFB6080/1 G2-SS	Fits 1" -1 1/4"	0789551	SXI-HK-10A StemExtension	1" - 1 1/4" 3C/G2
	0450127	1 1/4 LFB6081G2-SS	Solder	88005486	#3 LL-HK LFB6080/1 G2-SS	Fits 1" -1 1/4"	0789551	SXI-HK-10A StemExtension	1" - 1 1/4" 3C/G2
	0450128	1 1/2 LFB6081G2-SS	Solder	88005487	#4 LL-HK LFB6080/1 G2-SS	Fits 1 1/2"	0789552	SXI-HK-11A StemExtension	1 1/2" 3C/G2
	0450129	2 LFB6081G2-SS	Solder	88005488	#5 LL-HK LFB6080/1 G2-SS	Fits 2"	0789546	SXI-HK-5A StemExtension	2" 3C/3CM1/G2
	0422021	2 1/2 LFB6081G2-SS	Solder	88005490	#6 LL-HK LFB6080/1 G2-SS	Fits 2 1/2"	0789547	SXI-HK-6A StemExtension	2 1/2" 3C/3CM1/G2
	0422022	3 LFB6081G2-SS	Solder	88005491	#7 LL-HK LFB6080/1 G2-SS	Fits 3"	0789548	SXI-HK-7A StemExtension	3" 3C/3CM1/G2



USA: T: (978) 689-6066 • Watts.com
 Canada: T: (888) 208-8927 • Watts.ca
 Latin America: T: (52) 55-4122-0138 • Watts.com

Engineering Specification

Job Name _____

Contractor _____

Job Location _____

Approval _____

Engineer _____

Contractor's P.O. No. _____

Approval _____

Representative _____

LEAD FREE*

Series LFU5B Water Pressure Reducing Valves**

Sizes: 1/2" – 2"

Series LFU5B Water Pressure Reducing Valves are designed to reduce incoming water pressure to a sensible level to protect plumbing system components and reduce water consumption. The LFU5B features Lead Free* construction to comply with Lead Free* installation requirements. This series is suitable for water supply pressures up to 300psi (20.7 bar) and may be adjusted from 25 – 75psi (172 – 517 kPa). The standard setting is 50psi (345 kPa). All parts are quickly and easily serviceable without removing the valve from the line. The LFU5B's standard bypass feature permits the flow of water back through the valve into the main when pressures, due to thermal expansion on the outlet side of the valve, exceed the pressure in the main supply.

Features

- Standard construction includes Z3 sealed spring cage and stainless steel corrosion resistant adjusting cage screws for accessible outdoor or pit installations
- Integral stainless steel strainer
- Replaceable seat module
- Lead Free* cast copper silicon alloy body construction
- Serviceable in line
- Bypass feature controls thermal expansion pressure (LFU5B-Z3)***
- High temperature resistant reinforced diaphragm for hot water

Models

- LFU5B-Z3** NPT threaded female union inlet x NPT female outlet w/built in thermal expansion bypass
- LFU5B-S-Z3** Solder union inlet x NPT female outlet w/built in thermal expansion bypass
- LF5M3-Z6** Water meter threaded connections and 7 1/2" (190mm) lay length for new or existing meter box installations. For 5/8" (16mm), 5/8" x 3/4" (16 x 20mm) or 3/4" (20mm) meter setters or resetters
- LFU5B-QC-Z3** Quick-Connect Single-Union – inlet end

Specifications

Standard Specifications: A Water Pressure Reducing Valve with integral strainer shall be installed in the water service pipe near its entrance to the building where supply main pressure exceeds 60psi (413 kPa) to reduce it to 50psi (345 kPa) or lower. The water pressure reducing valve shall be constructed using Lead Free* materials. Lead Free* regulators shall comply with state codes and standards, where applicable, requiring reduced lead content. The valve shall feature a Lead Free* cast copper silicon alloy body suitable for water supply pressures up to 300psi (20.7 bar). Provision shall be made to permit the bypass flow of water back through the valve into the main when pressures, due to thermal expansion on the outlet side of the valve, exceed the pressure in the main supply. Water Pressure Reducing Valve with built-in bypass check valves will be acceptable. Approved valve shall be listed to ASSE 1003 and IAPMO and certified to CSA B356. Valve shall be a Watts Series LFU5B-Z3.

Watts product specifications in U.S. customary units and metric are approximate and are provided for reference only. For precise measurements, please contact Watts Technical Service. Watts reserves the right to change or modify product design, construction, specifications, or materials without prior notice and without incurring any obligation to make such changes and modifications on Watts products previously or subsequently sold.

LFU5B-Z3

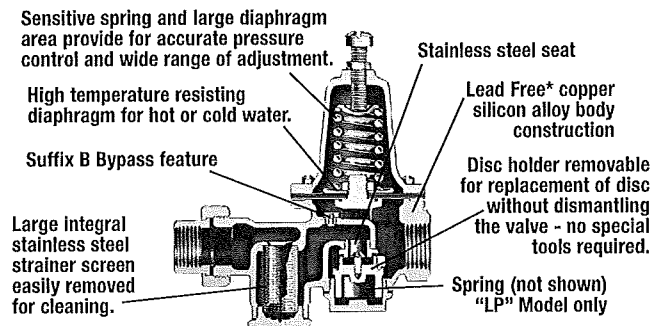
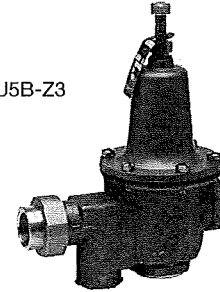

Suffix B
Thermal Expansion Bypass Check Valve Feature

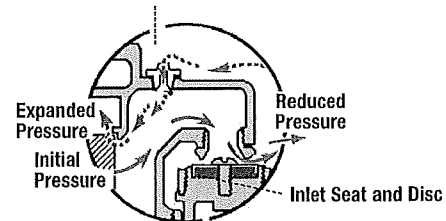

*The wetted surface of this product contacted by consumable water contains less than 0.25% of lead by weight.

**A water saving test program concluded that reducing the supply pressure from 80-50psi (551-345 kPa) resulted in a water savings of 30%.

***The bypass feature will not prevent the pressure relief valve from opening on the hot water supply system with pressure above 150psi (10.3 bar).

NOTICE

The information contained herein is not intended to replace the full product installation and safety information available or the experience of a trained product installer. You are required to thoroughly read all installation instructions and product safety information before beginning the installation of this product.

NOTICE

Inquire with governing authorities for local installation requirements

WATTS®

Materials

- Body: Lead Free* cast copper silicon alloy
- Seat: Replaceable stainless steel
- Integral Strainer: Stainless steel
- Diaphragm: Reinforced EPDM
- Valve Disc: EPDM
- Yoke: Lead Free* cast copper silicon alloy

LF5M3-Z6 model provided with cast iron spring cage

Pressure – Temperature

- Temperature Range: 33°F – 180°F (0.5°C – 82°C)
- Maximum Working Pressure: 300psi (20.7 bar)
- Adjustable Reduced Pressure Range: 25 – 75psi (172 – 517 kPa)
- Standard Reduced Pressure Setting: 50psi (345 kPa)

Options

Add Suffix

- G Gauge tapping
- GG Gauge tapping and 160psi (11.0 bar) gauge
- HP High pressure range 75 – 100psi (5.2 – 6.9 bar)
- LP Low pressure range 10 – 35psi (69 – 241 kPa)



Standards

Meets requirements of ASSE Standard 1003; (ANSI A112.26.2); CSA Standard B356; Southern Standard Plumbing Code and listed by IAPMO.

Capacity

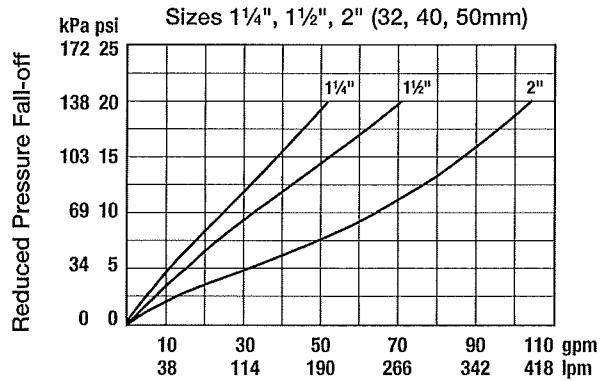
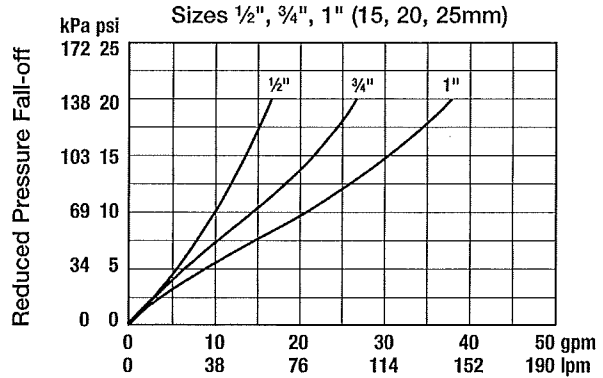

Dimensions - Weights

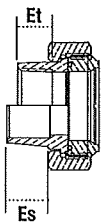

- A - LFU5B-Z3
- A1 - LFU5B-S-Z3
- Et - NPT Engagement for tight joint
- Es - Female sweat socket depth
- Eoc - Quick-Connect

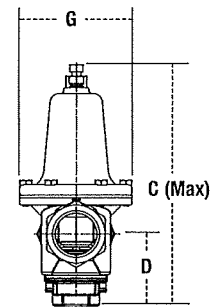
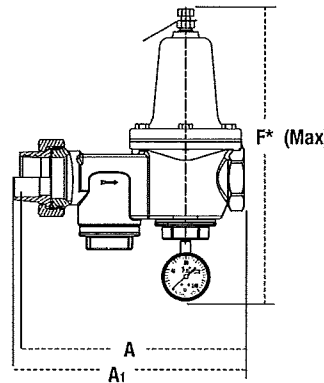
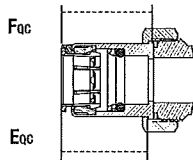

MODEL	SIZE	DIMENSIONS											WEIGHT										
		A		A1		C		D		G	Et	Es	Eoc	Foc	F*	lbs.	kgs						
	in.	mm	in.	mm	in.	mm	in.	mm	in.	mm	in.	mm	in.	mm	in.	mm							
LFU5B-Z3	1/2	5 5/8	142.8	5 1/2	139.7	5 5/8	149.2	1 5/8	41.2	3 1/16	77.7	7/16	11.1	1/2	12.7	1 1/16	36	1 1/2	38	10 1/4	260.3	4	1.8
	3/4	6 1/16	157.1	6 1/4	158.7	6 3/8	174.6	1 7/8	47.6	3 1/2	88.9	1/2	12.7	3/4	19	1 1/16	40	1 11/16	42	11 1/2	292.1	5	2.3
	1	6 5/8	168.2	6 3/4	171.4	7 3/8	187.3	2	50.8	4	101.6	9/16	14.2	7/8	22.2	1 11/16	43	1 3/4	45	12 1/8	307.9	6	2.7
	1 1/4	7 15/16	190.5	7 11/16	195.2	8 3/8	212.7	2 1/4	57.1	4 1/2	113.3	5/8	15.8	1	25.4	-	-	13 3/8	339.7	9.4	4.3		
	1 1/2	9 7/16	239.7	9 5/8	247.6	9 3/4	238.1	2 5/8	73	4 3/4	120.6	5/8	15.8	1 1/8	28.5	-	-	15	381.0	14.4	6.5		
	2	10 7/8	276.2	11 1/2	292.1	12 1/4	311.1	3 1/4	82.5	6	152.4	5/8	15.8	1 3/8	34.9	-	-	18 3/4	463.5	23	10.4		

*Dimension includes optional gauge



USA: T: (978) 689-6066 • F: (978) 975-8350 • Watts.com
 Canada: T: (888) 208-8927 • F: (905) 332-7068 • Watts.ca
 Latin America: T: (52) 55-4122-0138 • Watts.com

No.	DESCRIPTION	MATERIAL DESCRIPTION
1	BODY	CAST LOW LEAD BRASS ALLOY
2	CAP	CAST BRASS ASTM B62 ALLOY C83600
3	STEM	LOW LEAD BRASS ALLOY
4	BALL	LOW LEAD BRASS ALLOY
5	GASKET	ASTM D2000 (NITRILE)
6	SOLID PIN	AISI 303 STAINLESS STEEL
7	D-RING	ASTM D2000 (EP)
8	END PIECE	CAST LOW LEAD BRASS ALLOY
9	D-RING	ASTM D2000 (NITRILE)
10	TUBE NUT	CAST BRASS ASTM B62 ALLOY C83600

SIZE	ØA	B	C	D	E
3/4"	.75	4.23	.84	2.62	3.47
1"	1.00	5.53	1.15	2.82	3.97
1 1/2"	1.50	6.97	1.66	3.47	5.13
2"	2.00	8.69	2.00	3.80	5.80

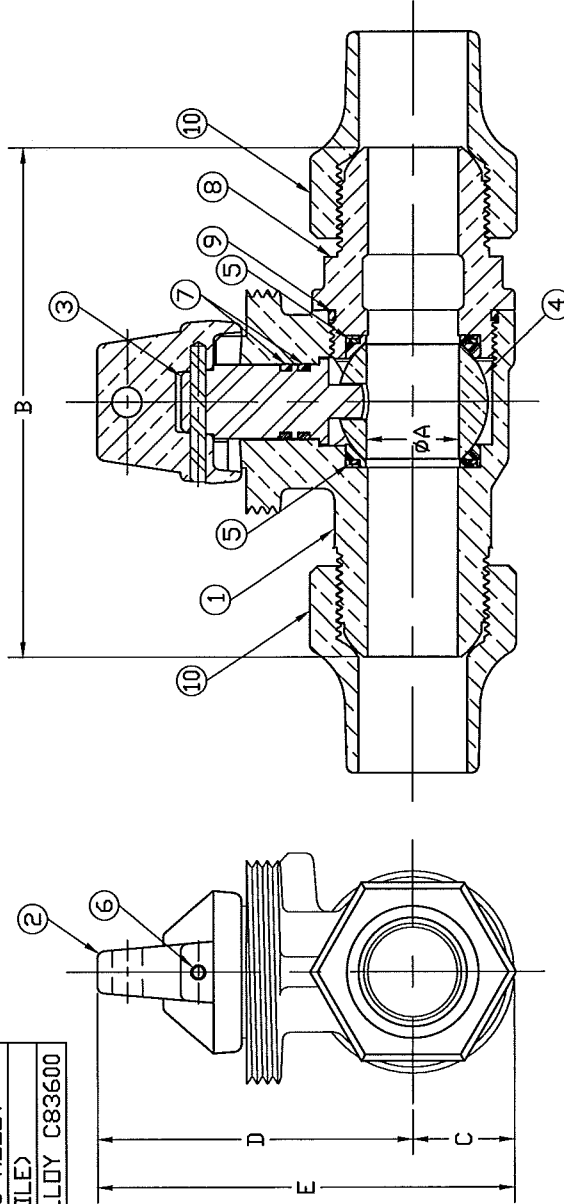

ALL WETTED PARTS ARE LOW LEAD BRASS ALLOY

FILEPATH: PROD-ENG\MUELLER\ASYSUBMITTALS\B25154N

DRFTR	RVB	6/20/13
CHKR		
ENGR		
MGR		
BY	DATE	
STK No		
MAT'L		

UNLESS OTHERWISE NOTED THIRD ANGLE PROJECTION

SURFACE PREPARATION: BREAK CORNERS .000 FINISH ---XXX RMS TOLERANCES: LINEAR ± .000 ANGULAR ± 0°00'

Mueller Co.

SCALE: FULL

REF. No.

DWG NUMBER: B25154N

DESCR: INLINE MINN TOP LLB BALL CURB VALVE (CS X CS)

TITLE ID AND OWNERSHIP OF THIS ENGINEERING DATA REMAINS IN FULL FORCE AND EFFECT TO BE AUTHORIZED BY THE ORIGINAL ASSIGNED PART OF THE RECIPIENT TO THESE CONDITIONS IS PRESUMED

DWG NUMBER
B25154N
42-MRKTG



TRANSMITTAL

Project: Maplewood - Goodrich Park
LHB Project No. 200290

Date: 3/13/2024

Subject: Updated PR 02 and CCD 01

Transmittal ID: 00061

Purpose: For your review and comment

Via: Info Exchange

From

NAME	COMPANY	EMAIL	PHONE
Angie Martin Minneapolis MN United States	LHB	angie.martin@lhbcorp.com	(612) 766-2836

To

NAME	COMPANY	EMAIL	PHONE
Ryan Sunram 20010 75th Ave N Corcoran MN 55340 United States	Sunram Construction, Inc.	ryan@sunramconstructioninc.com	(763) 420-2140
Annette Shierts 20010 75th Ave N Corcoran MN 55340 United States	Sunram Construction, Inc.	general_mail@sunramconstructi oninc.com	

Remarks: Hi Ryan, I've attached an updated PR 02 and an updated CCD 01 for your review and signature. These replace the previous versions sent. The only updates are the dates on each - they've been changed to today's date. I filled out the cover page of PR 02 so you didn't have to write it again - please confirm that everything looks correct. Thanks, Angie

Description of Contents

QTY	DATED	TITLE	NOTES
1	3/13/2024	200290 20240313 Proposal Request 02 - Pricing from Sunram.pdf	
1	3/13/2024	200290 Goodrich CCD 01.pdf	

Copies:

Lydia Major (LHB)

**RESOLUTION
DIRECTING MODIFICATION OF EXISTING CONSTRUCTION CONTRACT,
GOODRICH PARK IMPROVEMENTS, CHANGE ORDER NO. 1, NO. 2 AND CCD NO.1**

WHEREAS, the City Council of Maplewood, Minnesota has heretofore ordered the Goodrich Park Improvements, and has let a construction contract pursuant, and

WHEREAS, it is now necessary and expedient that said contract be modified and designated as Goodrich Park Improvements, Change Order No. 1, No. 2 and CCD No.1,

NOW, THEREFORE, BE IT RESOLVED BY THE CITY COUNCIL OF MAPLEWOOD, Minnesota, that

1. The Mayor, City Manager, and City Engineer are hereby authorized and directed to modify the existing contract by executing said Change Order No. 1, No. 2, and CCD No.1 which is an increase of up to \$58,511.00.

The revised contract amount is \$465,386.00.

Adopted by the Maplewood City Council on this 25th day of March, 2024.

CITY COUNCIL STAFF REPORT
Meeting Date March 25, 2024

REPORT TO: Michael Sable, City Manager

REPORT FROM: Steven Love, Public Works Director/City Engineer
Troy Brink, Street/Storm Superintendent

PRESENTER: Steven Love

AGENDA ITEM: Purchase of Road Salt for 2024-2025 Winter Season

Action Requested: Motion Discussion Public Hearing

Form of Action: Resolution Ordinance Contract/Agreement Proclamation

Policy Issue:

City Council will consider authorizing the purchase of de-icing salt under a State cooperative purchasing agreement for the 2024-2025 winter season.

Recommended Action:

Motion to authorize the Street Superintendent to purchase de-icing salt under a State contract for the 2024-2025 winter season in an estimated amount of \$62,421.00.

Fiscal Impact:

Is There a Fiscal Impact? No Yes, the true or estimated cost is \$62,421.00

 Financing source(s): Adopted Budget Budget Modification New Revenue Source
 Use of Reserves Other: n/a

Strategic Plan Relevance:

Community Inclusiveness Financial & Asset Mgmt Environmental Stewardship

Integrated Communication Operational Effectiveness Targeted Redevelopment

The use of de-icing salt is a vital part of the City's snow and ice program and essential for vehicle safety on City streets.

Background:

An allocation is made in the Public Works operating budget each year for the purchase of de-icing salt for winter street maintenance. Each year the street maintenance division purchases de-icing salt under the State cooperative purchasing agreement. In order to be included in this program, the State requires the City to submit salt needs for the upcoming winter season, in March of this year.

The State contract offers regular road salt and treated road salt under an 80/120 purchasing rule. The 80/120 rule requires the City to purchase 80% of the placed order and the vendor

guarantees to supply up to 120% of the placed order at the locked price. We estimate regular road salt needs to be 300 ton (estimated at \$99.62, estimate based on 5% increase from last year) and treated road salt needs of 250 ton (estimated at \$130.14 based on 5% increase from last year) for an estimated purchase cost of \$62,421.00 for the 2024-2025 winter season. While this winter was mild and we used less salt than a typical winter, staff recommends the purchase of additional salt to ensure we have a sufficient supply for the 2024/2025 winter season.

Attachments:

None

CITY COUNCIL STAFF REPORT
Meeting Date March 25, 2024

REPORT TO: Michael Sable, City Manager
REPORT FROM: Steven Love, Public Works Director/City Engineer
Troy Brink, Street/Storm Superintendent
PRESENTER: Steven Love
AGENDA ITEM: Ramsey County Public Works to Perform 2024 Street Striping

Action Requested: Motion Discussion Public Hearing
Form of Action: Resolution Ordinance Contract/Agreement Proclamation

Policy Issue:

City Council will consider authorizing Ramsey County Public Works to perform pavement striping for the City of Maplewood.

Recommended Action:

Motion to authorize Ramsey County Public Works to perform City pavement striping needs, in an amount estimated at \$30,000.

Fiscal Impact:

Is There a Fiscal Impact? No Yes, the true or estimated cost is \$30,000.00
Financing source(s): Adopted Budget Budget Modification New Revenue Source
 Use of Reserves Other: n/a

Strategic Plan Relevance:

Community Inclusiveness Financial & Asset Mgmt Environmental Stewardship
 Integrated Communication Operational Effectiveness Targeted Redevelopment

Pavement striping of City maintained streets is essential to the safety of vehicular and pedestrian traffic.

Background:

An allocation is made in the Public Works operating budget each year for the purchase of street striping services. It is anticipated that the cost for striping services will be \$30,000 in 2024. Maplewood has received Ramsey County’s annual notification for 2024 street striping request. Each year staff evaluates existing striping conditions, any upcoming projects, and all planned maintenance operations. Typically, 50% of the striping throughout the City is repainted by the County each year. Staff recommends to do the same for 2024.

Attachments:

None

CITY COUNCIL STAFF REPORT

Meeting Date March 25, 2024

REPORT TO: Michael Sable, City Manager

REPORT FROM: Andrea Sindt, City Clerk
Christine Evans, Deputy City Clerk

PRESENTER: Andrea Sindt, City Clerk

AGENDA ITEM: Resolution for a Lawful Gambling Premises Permit for White Bear Avenue Business Association at Unison Restaurant & Banquet LLC, 1800 White Bear Avenue North

Action Requested: Motion Discussion Public Hearing

Form of Action: Resolution Ordinance Contract/Agreement Proclamation

Policy Issue:

A request for a Lawful Gambling Premises permit has been submitted by White Bear Avenue Business Association. Approval of the request would allow lawful gambling activity (pull-tabs, bar bingo, tip-boards and paddlewheel) to be conducted at Unison Restaurant & Banquet LLC, 1800 White Bear Avenue North, on an ongoing basis.

Recommended Action:

Motion to approve the resolution for a lawful gambling premises permit for White Bear Avenue Business Association to conduct gambling activities at Unison Restaurant & Banquet LLC, 1800 White Bear Avenue North.

Fiscal Impact:

Is There a Fiscal Impact? No Yes, the true or estimated cost is \$0.00

Financing source(s): Adopted Budget Budget Modification New Revenue Source
 Use of Reserves Other: n/a

Strategic Plan Relevance:

Community Inclusiveness Financial & Asset Mgmt Environmental Stewardship
 Integrated Communication Operational Effectiveness Targeted Redevelopment

Approval and issuance of a Premises permit is done by the Minnesota Gambling Control Board; however, before the Board will review an application, city council approval of the activity is required per MN §349.213 subd. 2.

Background:

White Bear Avenue is the “Main Street” of the north east neighborhoods of St. Paul and the eastern portion of Maplewood. The White Bear Avenue Business Association has formed a coalition of civic, public and private resources. Members come from businesses and organizations through the area that surrounds White Bear Avenue. The Business Association oversees and regulates the charitable gambling proceeds and incorporates them back into the neighborhood. Since being licensed in 1995 for charitable gambling, the Association has grown strong and has established its success to serve the people. The organization currently conducts lawful gambling at The Cherry Pit, 735 White Bear Avenue in St Paul.

For the purposes of this application, a background investigation has been conducted on the organization’s designated gambling manager: Kelly Ellsworth.

Attachments:

1. Resolution for a Lawful Gambling Premises Permit

RESOLUTION _____
LAWFUL GAMBLING PREMISES PERMIT FOR WHITE BEAR AVENUE BUSINESS ASSOCIATION AT UNISON RESTAURANT & BANQUET LLC.

WHEREAS, White Bear Business Association has submitted an application to the City of Maplewood requesting City approval of a Lawful Gambling Premises permit application, to be used at Unison Restaurant & Banquet LLC, 1800 White Bear Avenue North, Maplewood, MN;

WHEREAS, local approval is required prior to the Gambling Control Board's issuance of a premises permit;

BE IT HEREBY RESOLVED, by the City Council of Maplewood, MN, that the premises permit for lawful gambling is approved for White Bear Business Association to conduct gambling activities at Unison Restaurant & Banquet LLC, 1800 White Bear Avenue North, Maplewood, MN.

FURTHERMORE, that the Maplewood City Council requests that the Gambling Control Board approve said permit application as being in compliance with Minnesota Statute §349.213.

NOW, THEREFORE, be it further resolved that this Resolution by the City Council of Maplewood, MN, be forwarded to the Gambling Control Board for their approval.

CITY COUNCIL STAFF REPORT

Meeting Date March 25, 2024

REPORT TO: Michael Sable, City Manager

REPORT FROM: Steven Love, Public Works Director / City Engineer
Jon Jarosch, Assistant City Engineer

PRESENTER: Steven Love

AGENDA ITEM: 2024 Maplewood Street Improvements, City Project 23-08
a. Resolution Approving Plans and Specifications and Advertising For Bids
b. Resolution Ordering Preparation Of Assessment Roll

Action Requested: Motion Discussion Public Hearing

Form of Action: Resolution Ordinance Contract/Agreement Proclamation

Policy Issue:

The Engineering Department prepares plans and specifications prior to advertising the project for bids. The plans and specifications are essential to ensuring the project is constructed to current standards, meets the needs of area residents, receives reasonable bids, and the project is constructed in a timely manner.

The City Council will consider approving the plans and specifications and advertising for bids for the 2024 Maplewood Street Improvements, City Project 23-08. Final plans and specifications are complete and ready to be advertised for bids. The bid opening is tentatively proposed for 10:00 a.m. on April 24, 2024.

The City Council will also consider ordering the preparation of the assessment roll for the 2024 Maplewood Street Improvements, City Project 23-08. The assessment hearing is proposed to be held in September of 2024.

Recommended Action:

- a. Motion to approve the attached resolution approving plans and specifications and advertising bids for the 2024 Maplewood Street Improvements, City Project 23-08.
- b. Motion to approve the attached resolution ordering preparation of assessment roll for the 2024 Maplewood Street Improvements, City Project 23-08.

Fiscal Impact:

Is There a Fiscal Impact? No Yes, the true or estimated cost is \$10,878,200

Financing source(s): Adopted Budget Budget Modification New Revenue Source
 Use of Reserves Other: The proposed funding plan includes a combination of Special Benefit Assessments, the Street Revitalization Fund, the Environmental Utility Fund, the Sanitary Sewer Fund, St. Paul Regional Water Services, G.O. Improvement Bonds, Ramsey-Washington Metro Watershed District, and the W.A.C. Fund.

Strategic Plan Relevance:

- | | | |
|---|--|---|
| <input checked="" type="checkbox"/> Community Inclusiveness | <input checked="" type="checkbox"/> Financial & Asset Mgmt | <input checked="" type="checkbox"/> Environmental Stewardship |
| <input type="checkbox"/> Integrated Communication | <input type="checkbox"/> Operational Effectiveness | <input type="checkbox"/> Targeted Redevelopment |

The streets proposed for reconstruction under this project represent an important part of the City's infrastructure, serving as a connection to and from residential properties, businesses and other points of interest. The City streets and utilities included in the project have deteriorated beyond the point of regular annual maintenance and are in need of replacement. The project will be constructed utilizing environmentally sound practices such as pavement reclamation, reducing impervious surfaces where possible, installing water-quality features such as rain gardens, and using recycled asphalt in the pavement.

Background:

The City streets included in the 2024 Maplewood Street Improvements total approximately 4.30 miles in length. The project includes two areas; the East Shore Drive area and the Cypress-Maplewood Drive area. The East Shore Drive area is generally bounded by Frost Avenue to the north, Lake Phalen to the west, Larpenteur Avenue to the south, and Birmingham Street to the east. The Cypress-Maplewood Drive area is generally bounded by Beam Avenue to the north, Keller Parkway to the west, Gervais Avenue to the south, and Hazelwood Avenue to the east. This project is a part of the 2024 – 2028 Maplewood Capital Improvement Plan (CIP). If the project moves forward through the approval process and the City Council awards a construction contract, construction would begin in June of 2024.

The existing street pavement and aging utility infrastructure on the project streets present an ongoing maintenance problem for the City of Maplewood Street and Utility Departments. Of the infrastructure elements the City maintains, the bulk of the maintenance activities consist of patching the roadway, crack sealing, filling potholes, and maintaining the aging utility infrastructure. The condition of the existing street also represents a decreased level of service for the residents of Maplewood, with the City receiving complaints from area residents about substandard street conditions. The project streets have a combined average PCI rating of 32/100. The PCI rating is based on a visual survey of the pavement and is a number between 0 and 100, with 0 being the worst possible pavement condition and 100 being the best possible pavement condition (i.e. a new road). This project would include the following improvements:

Pavement Rehabilitation Type Improvement Streets:

- Full depth reclamation (essentially grinding and mixing) of existing pavement and underlying aggregate base
- Removal of excess reclaim material to accommodate new pavement section
- Full replacement of asphalt pavement section
- Spot replacement of severely deteriorated concrete curb and gutter
- Roadway subgrade soil corrections as necessary
- Upgrade of existing pedestrian features to ADA compliance
- Saw & seal of control joints for the new bituminous pavement
- Replacement of outdated utility surface castings/lids and failing structures
- Installation of sacrificial anodes on existing water mains
- Restoration of driveways, turf and landscape features impacted by the project

Full Reconstruction Type Improvement Streets:

- Full removal of existing pavement and underlying aggregate base
- Full replacement of asphalt pavement section
- Construction of all new concrete curb and gutter
- Subgrade soil corrections based on soil boring data
- Improvements to the existing pedestrian features
- Saw & seal of control joints for the new bituminous pavement
- Installation on sacrificial anodes on proposed and existing water mains
- Utility improvements to include the installation of new storm sewer structures and piping, replacement of cast iron water main, and replacement of select sanitary sewer services
- Water quality improvements to include residential rain water gardens, infiltration basins, or underground infiltration basins where feasible
- Restoration of driveways, turf and landscape features impacted by the project

Additional Improvements:

- Sanitary sewer lining of deteriorating mains throughout the City
- Fog seal pavement of a past project area streets

In 2022, the City of Maplewood Sanitary Sewer Department performed televising and manhole inspections of the sewer system within the project streets. Based on the results of the reports, staff are recommending repairs to select sewer services which have had a history of root infiltration. The majority of these services are located in the East Shore Drive area of the project. Staff also recommend upgrading existing surface castings to the current standard and replacing failing manhole adjustment rings as needed.

Saint Paul Regional Water Services (SPRWS) has identified approximately 2,600-feet of cast iron water main which needs to be removed and replaced as a part of the project. The water main work would be done under the project contract, with the costs associated with this work being reimbursed to the City by SPRWS. SPRWS is also recommending sacrificial anodes be installed on all new water mains and existing water mains in the Cypress-Maplewood Drive area of the project. Sacrificial anodes improve corrosion resistance and break susceptibility of the water mains they are attached to.

Some project streets lack an adequate storm sewer system, while others have an effective system currently in place. Depending on the project street, installation of new storm sewer piping and structures may be needed or repairs to the existing system may be needed. On streets with new storm sewer systems proposed, water quality and rate control improvements will be implemented where possible. Based on the existing conditions, staff are recommending the East Shore Drive area storm sewer system be expanded and replaced as necessary. The Cypress-Maplewood Drive area has an adequate storm sewer system in place, staff recommend only replacing failing structures and pipes as necessary.

Assessments

An independent appraisal firm has been hired to provide an opinion of special benefit received by properties within the project area. This information will ultimately be utilized to determine the special benefit assessment amounts for the project area. The rates established in the City's Special Assessment Policy were utilized at this time to generate a pending assessment roll.

Based on the City of Maplewood's Pavement Management Policy, parcels are assessed on an equal "unit" basis. However, per Minnesota State Statute 429, the assessment amount cannot be greater than the benefit received by the property from the type(s) improvement. Ultimately the special benefit appraisal report will determine the final assessment amounts for the properties proposed to be assessed as a part of the project. For the purposes of this report and establishing a project financing plan, the preliminary assessment rate(s) are as follows.

- Residential
 - Full Reconstruction Rate, Single Family Unit = \$6,600/Unit
 - Partial Reconstruction Rate, Single Family Unit = \$4,950/Unit
 - Pavement Rehabilitation Rate, Single Family Unit = \$3,450/Unit
 - Pavement Rehabilitation Rate, Duplex Rate = \$1,955/Unit
- Commercial/Multi-Family
 - Pavement Rehabilitation Rate = \$69.00/Front-Foot

The assessment hearing is currently proposed to be held in September of 2024.

Estimated Project Cost

The total estimated project cost is \$10,878,200 and is outlined below.

Estimated Project Cost Summary		
Proposed Improvements	Total Amount	% of Total
Street Improvements	\$6,458,000	59%
Drainage Improvements	\$2,820,000	26%
Sanitary Sewer Improvements	\$430,000	4%
Water System Improvements	\$1,170,200	11%
Total Estimated Project Cost:	\$10,878,200	100%

The estimated costs include 10% contingencies and 12% overhead, which include geotechnical, legal, and fiscal expenses.

Project Funding Plan

The improvements are proposed to be financed through a combination of Environmental Utility Fund, G.O. Improvement Bonds, Sanitary Sewer Fund, Special Benefit Assessments, Saint Paul Regional Water, Ramsey-Washington Metro Watershed District, and the W.A.C. Fund. An update to the financing plan will be provided after the special benefits appraisal is received.

Estimated Project Cost Recovery		
Funding Source	Total Amount	% of Total
General Obligation (G.O.) Improvement Bonds	\$4,759,300	43%
Street Revitalization Fund	\$658,100	6%
Environmental Utility Fund	\$2,156,000	20%
Ramsey-Washington Metro Watershed District	\$125,000	1%
Sanitary Sewer Fund	\$430,000	4%
Water Area Fund (WAC)	\$83,400	1%
St. Paul Regional Water Services	\$1,086,800	10%
Special Benefit Assessments	\$1,579,600	15%
Total Estimated Project Funding:	\$10,878,200	100%

The total estimated project cost is roughly \$58,000 higher than the approved CIP. This is due to higher than anticipated water main replacement costs and drainage improvement costs at the feasibility level versus the CIP. These additional costs will be covered by contributions from Saint Paul Regional Water Services and the Ramsey-Washington Metro Watershed District. Overall bonding levels are estimated to be roughly \$34,000 less than the CIP estimate.

The estimated project costs and the preliminary project funding plan have been reviewed by the Finance Director.

Project Schedule

The following is a tentative schedule for City Project 23-08 should it be determined to proceed with the project:

Project Milestone	Date
Order Preparation of Feasibility Study	7/24/2023
Neighborhood Meeting #1 (Maplewood Drive-Cypress Area only)	12/13/2023
Neighborhood Meeting #1 (East Shore Drive Area only)	12/14/2023
City Council Meeting Accept Feasibility Study, Order Public Hearing, Authorize Preparation of Plans & Specifications	1/22/2024
Neighborhood Meeting #2 (East Shore Drive Area & Maplewood Drive-Cypress Area)	2/7/2024
City Council Meeting Public Hearing & Order Improvement	2/12/2024
City Council Meeting Approve Plans and Specifications, Authorize Advertisement for Bids, Authorize Preparation of Assessment Roll	3/25/2024
Bid Opening	4/24/2024
City Council Meeting Award Contract	5/13/2024
Neighborhood Meeting #3 (East Shore Drive Area only)	May 2024
Neighborhood Meeting #3 (Maplewood Drive-Cypress Area only)	May 2024
Begin Construction	June 2024
City Council Meeting Accept Assessment Roll & Order Assessment Hearings	8/12/2024
Neighborhood Meeting #4 (East Shore Drive Area & Maplewood Drive-Cypress Area)	9/4/2024
City Council Meeting Assessment Hearing and Adopt Assessment Roll	9/9/2024
Complete Construction	November 2024
Assessments Certified to Ramsey County	November 2024

Attachments:

1. Resolution Approving Plans and Specifications and Advertising for Bids
2. Resolution Authorizing Preparation of Assessment Roll
3. Project Location Map

**RESOLUTION
APPROVING PLANS AND SPECIFICATIONS
AND ADVERTISING FOR BIDS**

WHEREAS, pursuant to a resolution of the City Council adopted January 11th, 2024, fixed a date for a Council hearing on the proposed street improvements for the 2024 Maplewood Street Improvements, City Project 23-08.

AND WHEREAS, pursuant to resolution passed by the City Council on February 12th, 2024, plans and specifications for the 2024 Maplewood Street Improvements, City Project 23-08, have been prepared by (or under the direction of) the City Engineer, who has presented such plans and specifications to the City Council for approval,

NOW, THEREFORE, BE IT RESOLVED BY THE CITY COUNCIL OF THE CITY OF MAPLEWOOD, MINNESOTA:

1. Such plans and specifications are hereby approved and ordered placed on file in the office of the City Engineer.
2. The City Clerk or office of the City Engineer shall prepare and cause to be inserted into the official paper and Finance and Commerce an advertisement for bids upon the making of such improvement under such approved plans and specifications. The advertisement shall be published twice, at least twenty-one days before the date set for bid opening, shall specify the work to be done, shall state that bids will be publicly opened electronically via QuestCDN and considered at 10:00 a.m. on the 24th day of April, 2024. Bids shall be accompanied by a certified check or bid bond, payable to the City of Maplewood, Minnesota for five percent of the amount of such bid.
3. The City Clerk and City Engineer are hereby authorized and instructed to receive, open, and read aloud bids received at the time and place herein noted, and to tabulate the bids received. The City Council will consider the bids, and the award of a contract, at the regular City Council meeting of May 13th, 2024.

Approved this 25th day of March 2024.

**RESOLUTION
ORDERING PREPARATION OF ASSESSMENT ROLL**

WHEREAS, the City Clerk and City Engineer will receive bids for the 2024 Maplewood Street Improvements, City Project 23-08.

NOW, THEREFORE, BE IT RESOLVED BY THE CITY COUNCIL OF MAPLEWOOD, MINNESOTA that the City Clerk and City Engineer shall forthwith calculate the proper amount to be specially assessed for such improvement against every assessable lot, piece or parcel of land abutting on the streets affected, without regard to cash valuation, as provided by law, and they shall file a copy of such proposed assessment in the city office for inspection.

FURTHER, the City Clerk shall, upon completion of such proposed assessment notify the City Council thereof.

Approved this 25th day of March 2024.

Cypress-Maplewood Drive Area

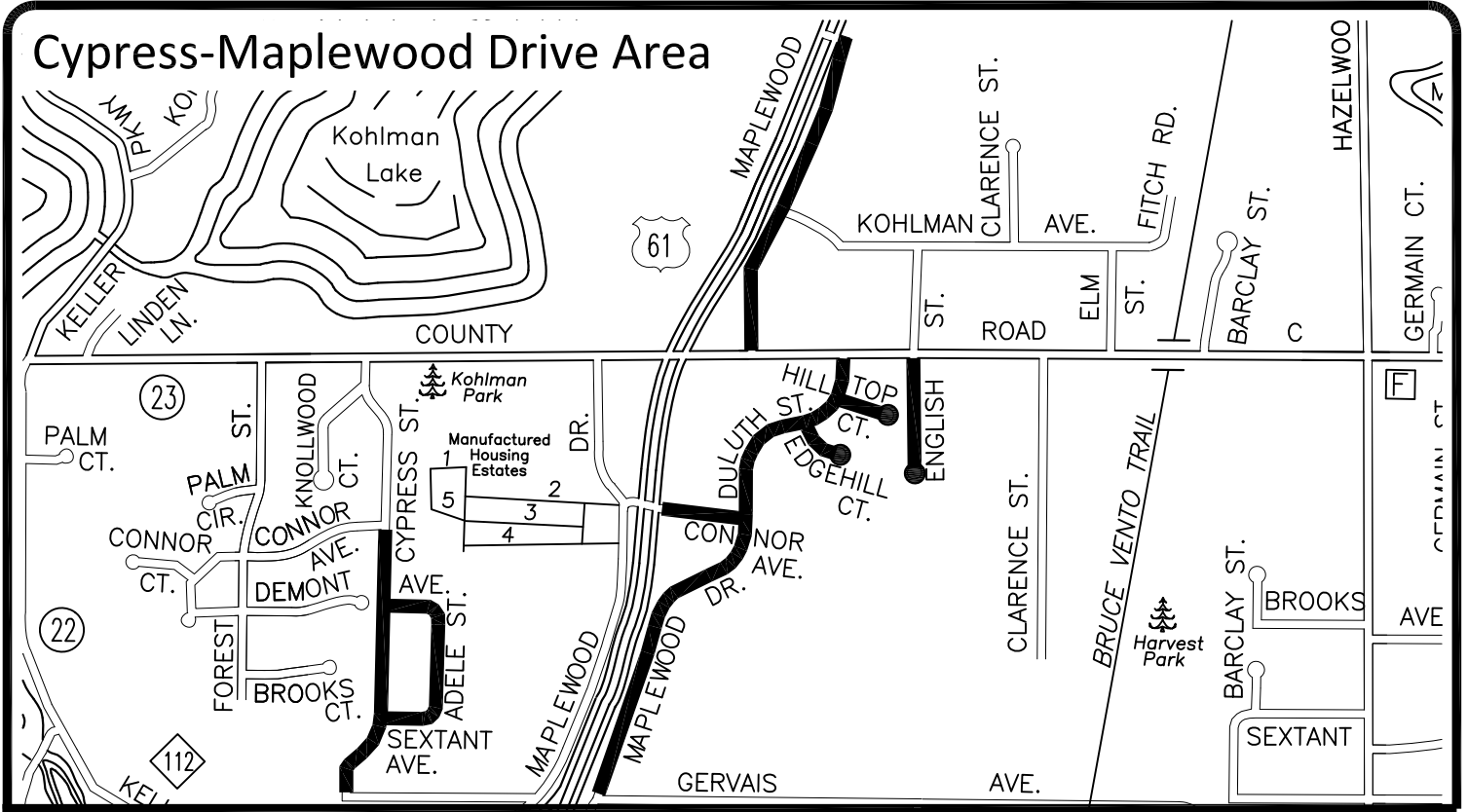

East Shore Drive Area



— PROPOSED STREET IMPROVEMENT

ST. I
NO SCALE

2024 Maplewood Street Improvements City Project 23-08

